

© BY ZEMBA + PRIETO ARCHITECTS ALL COMMON LAW COPYRIGHT AND OTHER PROPERTY RIGHTS RESERVED. THIS DOCUMENT IS AN ORIGINAL UNPUBLISHED WORK PRODUCT OF ZEMBA + PRIETO ARCHITECTS THIS WORK SHALL NOT BE REPRODUCED COPIED OR OTHERWISE USED IN CONNECTION WITH ANY WORK OR PROJECT OTHER THAN THAT FOR WHICH THEY HAVE BEEN PREPARED OR ASSIGNED TO ANY THIRD PARTY WITHOUT FIRST OBTAINING THE EXPRESS WRITTEN CONSENT OF ZEMBA + PRIETO ARCHITECTS VISUAL CONTACT WITH THIS DOCUMENT SHALL CONSTITUTE CONCLUSIVE EVIDENCE OF ACCEPTANCE OF THESE RESTRICTIONS CONTRACTORS SHALL VERIFY AND BE RESPONSIBLE FOR ALL DIMENSIONS AND CONDITIONS ON THE JOB UPON DISCOVERY OF ANY VARIATION, DISCREPANCY, OR OMISSION, NOTIFY ZEMBA + PRIETO ARCHITECTS AND PRIOR TO PROCEEDING WITH RELATED WORK OBTAIN WRITTEN RESOLUTION FROM ZEMBA + PRIETO ARCHITECTS

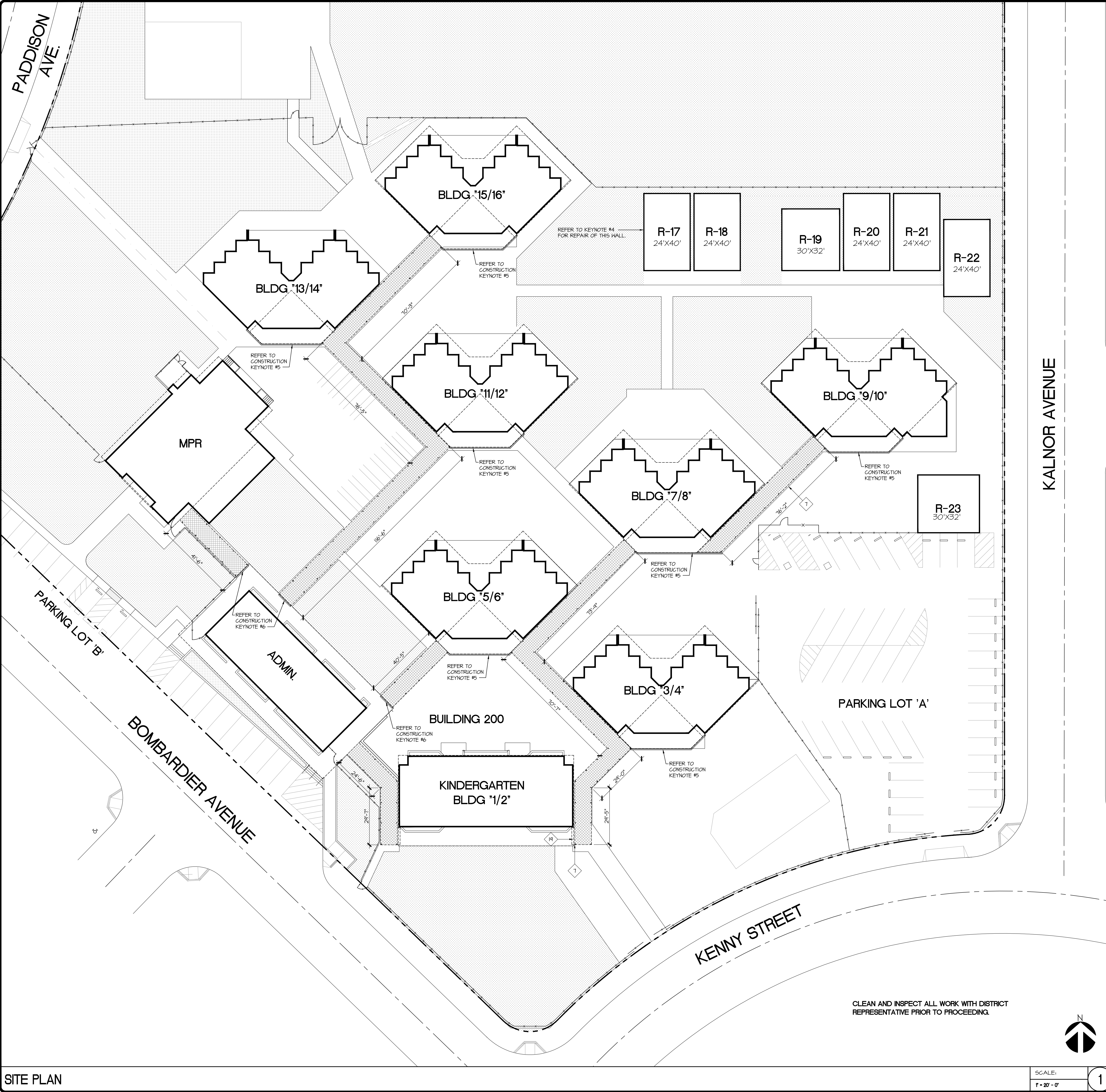

CONSTRUCTION KEYED NOTES

- REFER TO SHEETS A4.0-F THROUGH A5.0-F FOR CONSTRUCTION KEYNOTES.
- 2. SCRAPE / LEVEL SURFACE FOR PAINT WITH PLASTER PATCH/STUCCO PATCH AS REQUIRED.
- 3. VERIFY WITH DISTRICT FOR BRICK REPAIRS.
- 4. REMOVE/DEMO/REPLACE T-HI WOOD SIDING FOR THIS WALL IN ITS ENTIRETY. PREPARE WALL TO RECEIVE (N) WORK. INSTALL (N) SIDING, PREP, FINISH AND PAINT PER DETAIL 5/A4.5-F.
- 5. REMOVE/DEMO, REPLACE RAIN GUTTERS AT BUILDING LOCATIONS AS SHOWN ON SITE PLAN. REFER TO KEYNOTE #2B AND COLOR NOTE 'A' ON PLANS.
- 6. REMOVE/DEMO, REPLACE RAIN GUTTERS AT COVERED WALKWAYS AS SHOWN ON SITE PLAN. PAINT TO MATCH COLOR FROM COLOR NOTE 'A' ON PLANS.

REPAIR KEYED NOTES

- 1 - AREA OF DAMAGED / CRACKED PLASTER. REPAIR AND PATCH WITH NEW PLASTER TO MATCH (E).
- 2 - BRICK INFILL OR DISCOLORED BRICK. LIGHTLY VAPORBLAST ENTIRE BRICK WALL SURFACE. COAT WITH ANTI-GRAFFITI COATING. INSPECT ALL BRICK WORK PRIOR TO PROCEEDING.
- 3 - DAMAGED / CRACKED BRICK / CONCRETE. REPLACE OR PATCH TO MATCH (E).
- 4 - EXPOSED CONCRETE LINTEL. REPAIR CRACKS IF ANY. PAINT TO MATCH ADJACENT BRICK COLOR.
- 5 - DAMAGED WOOD PANELING. REMOVE AND REPLACE WITH NEW WOOD PANELING.
- 6 - CRACKED / DAMAGED WINDOW PANE. REMOVE AND REPLACE WITH NEW GLASS TO MATCH EXISTING.
- 7 - DAMAGED WOOD FASCIA. REMOVE AND REPLACE WITH NEW WOOD FASCIA TO MATCH EXISTING. REPLACE METAL DRIP EDGE AS REQUIRED WHERE DAMAGED. DETAIL 8/T3.0
- 8 - DAMAGED METAL FLASHING / COPING. REMOVE AND REPLACE WITH NEW FLASHING / COPING TO MATCH EXISTING.
- 9 - DAMAGED METAL GUTTER. REMOVE AND REPLACE AS NEEDED WITH NEW METAL GUTTER. DETAIL 7/3.0. PATCH WHERE GUTTER WAS REPLACED AND PATCH ROOFING AS NEEDED.
- 10 - DAMAGED DOWNSPOUT. REMOVE AND REPLACE WITH NEW DOWNSPOUT TO MATCH (E).
- 11 - DOWNSPOUT. PROVIDE MISSING / DAMAGED CONNECTION FROM GUTTER TO DOWNSPOUT. SEE DETAIL 1/13.0
- 12 - DAMAGED VENT. REMOVE AND REPLACE WITH NEW TO MATCH (E). FOR SOFFIT VENT, REMOVE PORTION OF ADJACENT PLASTER OR WOOD AS REQUIRED AND PROVIDE NEW PLASTER / WOOD WHERE REMOVED. SEE DETAIL 2/13.0.
- 13 - DAMAGED WOOD SKIRTING. REMOVE AND REPLACE WITH NEW SKIRTINGS AS NEEDED TO MATCH (E).
- 14 - REMOVE AND REPLACE DAMAGED BACKPACK HANGER HOOD PLATE.
- 15 - REMOVE (E) LOWERED OPENINGS AND PROVIDE NEW. SEE DETAIL 13 + 14/T3.0.
- 16 - SAW CUT UNSEAL METAL POST ABOVE FINISH GRADE AND GAP THE OPENING. PROTECT THE CONCRETE AND WALL AROUND THE POST FROM ANT-DAMAGE DURING REMOVAL.
- 17 - SMOOR. ADHESIVE LOGO. REMOVE. DISTRICT TO REPLACE WITH NEW ADHESIVE LOGO / STICKER.
- 18 - DAMAGED WOOD SIDING. REMOVE AND REPLACE AS REQUIRED.
- 19 - DAMAGED WOOD PLANK CEILING TO BE REMOVED AND REPLACED IN AREA INDICATED IN DRAWING.
- 20 - ROOM SIGNAGE. REMOVE AND REPLACE WITH NEW SIGNAGE PER DISTRICT'S APPROVAL.
- 21 - REMOVE WOOD LATTICE OVER LOWERED OPENINGS.
- 22 - HOLE IN BRICK MASONRY. FILL WITH COLORED GROUT TO MATCH BRICK.
- 23 - DAMAGED ELECTRICAL BOX / SPEAKER TO BE REPLACED BY THE DISTRICT BEFORE PAINTING WORK BEGINS. REFER TO THE PAINTING AND CONSTRUCTION NOTES #5.
- 24 - DAMAGED METAL FASCIA. REMOVE AND REPLACE WITH NEW METAL FASCIA TO MATCH EXISTING. REPLACE METAL DRIP EDGE AS REQUIRED WHERE DAMAGED.
- 25 - WOOD PLANK / SKIRTING WITH LOOSE EDGE. NAIL / FIX AS REQUIRED.

NOTE: BUILDING REPAIR KEYED NOTES ARE CALLED ON SHEETS A4.0-F THROUGH A4.5-F.

LEGEND

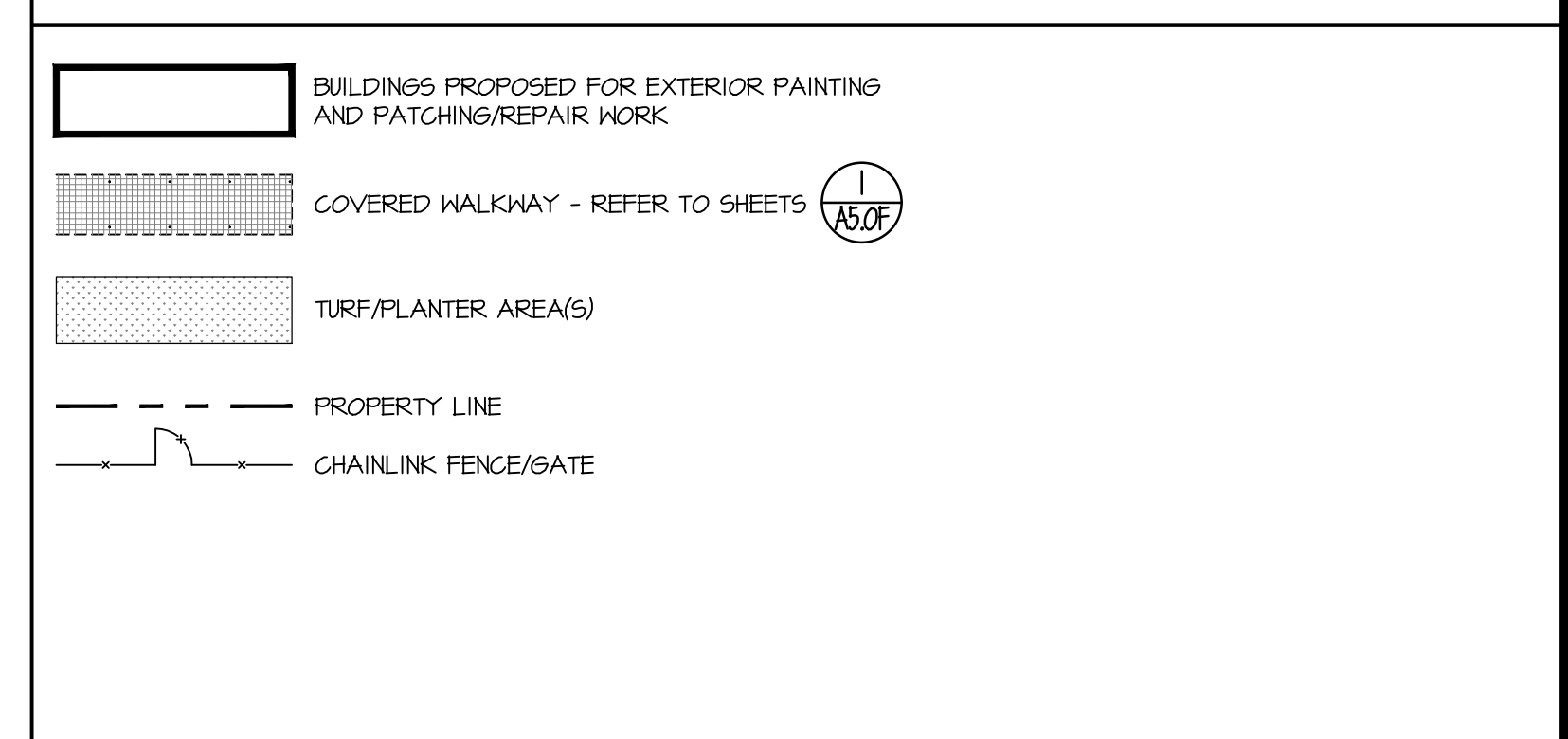

BUILDING REFERENCES

RELOCABLE #	SIZE (X L) APPROXIMATE	REFERENCE
ADMINISTRATION	32' X 80'	U/A4.0-F
KINDERGARTEN	37' X 40'	6/A4.0-F
CLASSROOM 3/4	45' X 41'	U/A4.1-F
CLASSROOM 5/6	45' X 41'	6/A4.1-F
CLASSROOM 7/8	45' X 41'	U/A4.2-F
CLASSROOM 9/10	45' X 41'	6/A4.2-F
CLASSROOM 11/12	45' X 41'	U/A4.3-F
CLASSROOM 13/14	45' X 41'	6/A4.3-F
CLASSROOM 15/16	45' X 41'	U/A4.4-F
MPR	61' X 80'	6/A4.4-F
R-17	24' X 40'	U/A4.5
R-18	24' X 40'	U/A4.5
R-19	30' X 32'	6/A4.5
R-20	24' X 40'	U/A4.5
R-21	24' X 40'	U/A4.5
R-22	24' X 40'	U/A4.5
R-23	30' X 32'	6 /A4.5

CLEAN AND INSPECT ALL WORK WITH DISTRICT REPRESENTATIVE PRIOR TO PROCEEDING.

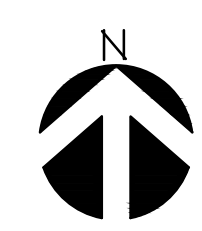

SCALE: 1" = 20' - 0"

SITE PLAN

NO.	DATE	REVISION	BY

DATE: 02/14/20

JOB NO.: 180104

DESIGNED BY: JMM

DRAWN BY: JMM

CHECKED BY: JP

ZIEMBA + PRIETO ARCHITECTS
 401 South Glendora Boulevard • Suite 400 • Burbank, CA 91502
 P: (618) 841-2635 • F: (618) 841-7782 • www.ziembaandprieto.com

SITE PLAN - LAKELAND ELEMENTARY SCHOOL

LITTLE LAKE CITY SCHOOL DISTRICT
 10515 S. PIONEER BLVD.
 SANTA FE SPRINGS, CA 90670

DISTRICT WIDE PAINTING PROJECT
 LAKELAND ELEMENTARY SCHOOL
 11224 BOMBARDIER AVENUE
 NORWALK, CALIFORNIA 90650



SHEET NO.
AS1.0-F