

CHARLESWORTH ROAD

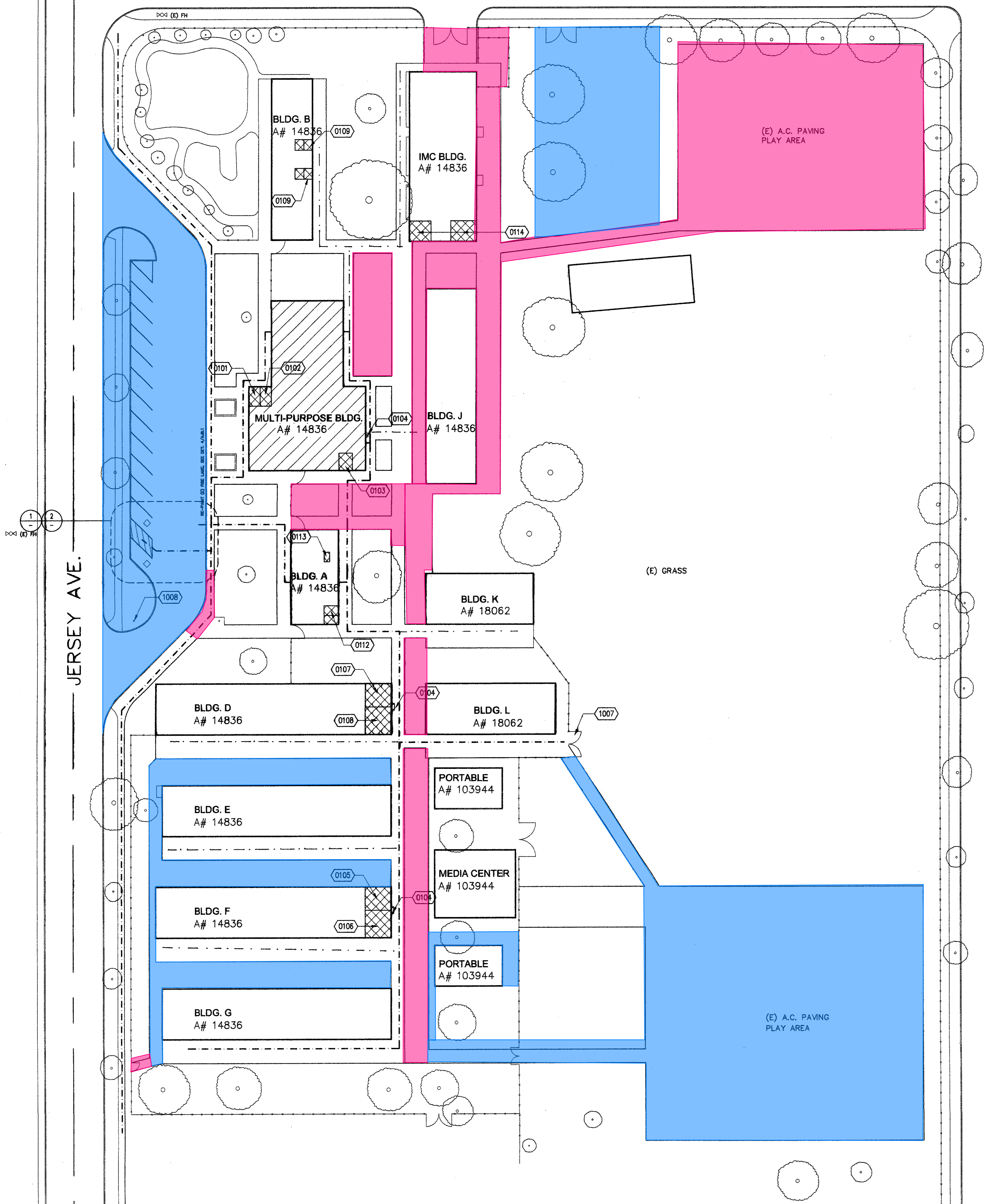

**Blue Area:**

- Contractor to provide 1000' lineal feet of hot crack fill. Contractor to figure the cracks are 2" wide.
- Contractor to provide 750 square feet of random patches of removal and replacement of 6" asphalt and 6" base. prior to slurry seal coat
- Contractor to provide striping to match existing.
- Contractor shall clean existing surface thoroughly prior to applying 1st coat.
- Contractor to provide any grinding needed for new asphalt to transition to existing.
- Contractor shall figure to remove and reinstall all wheel stops and reinstall after completion of slurry coat.
- Contractor shall paint curb to match existing.
- Contractor to provide new redwood header as needed where asphalt doesn't abut to concrete

**Orange Area:**

- Contractor to provide removal of existing 6" asphalt and 6" base.
- Remove any native or imported fill to allow for new asphalt and base to be installed.
- Contractor to provide 4" asphalt over 4" of base.
- Provide all compaction and grading to meet ADA Requirements. Subgrade, base and asphalt to be compacted to 95%
- Contractor shall clean existing surface thoroughly prior to applying 1st coat.
- Contractor to provide any grinding needed for new asphalt to transition to existing
- Contractor to provide striping to match existing.

**Pink Area:**

- Contractor to provide removal of existing 6" asphalt and 6" base.
- Remove any native or imported fill to allow for new concrete to be installed.
- Contractor to provide 5" of concrete over compacted imported fill or native sub soil. sub grade to be compacted to 95%
- Contractor to provide concrete wire mesh for reinforcement and drill, epoxy No. 4's 16" OC to existing concrete.
- Contractor shall provide all compaction to 95% and grading to meet ADA Requirements

**REFERENCE NOTES**

PATH OF TRAVEL (P.O.T.) AS INDICATED IS A BARRIER FREE ACCESS AT LEAST 48" WIDE WITHOUT ANY ABRUPT VERTICAL CHANGES EXCEEDING 1/2" AT 1:12 MAXIMUM SLOPE, EXCEPT THAT LEVEL CHANGES DO NOT EXCEED 1/4" VERTICAL. MAXIMUM CROSS-SLOPE 2% TYPICAL AND SLOPE IN THE DIRECTION OF TRAVEL DOES NOT EXCEED 5%, UNLESS OTHERWISE NOTED. THE CONTRACTOR SHALL VERIFY THAT ALL BARRIERS ON THE INDICATED PATH OF TRAVEL HAVE BEEN REMOVED.

**LEGEND**

PATH OF TRAVEL (P.O.T.) AS INDICATED IS A BARRIER FREE ACCESS AT LEAST 48" WIDE WITHOUT ANY ABRUPT VERTICAL CHANGES EXCEEDING 1/2" AT 1:12 MAXIMUM SLOPE, EXCEPT THAT LEVEL CHANGES DO NOT EXCEED 1/4" VERTICAL. MAXIMUM CROSS-SLOPE 2% TYPICAL AND SLOPE IN THE DIRECTION OF TRAVEL DOES NOT EXCEED 5%, UNLESS OTHERWISE NOTED. THE CONTRACTOR SHALL VERIFY THAT ALL BARRIERS ON THE INDICATED PATH OF TRAVEL HAVE BEEN REMOVED.

**PATH OF TRAVEL**

TOTAL PARKING SPACES = 13	STALL TYPE			TOTAL
	STANDARD	ACCESSIBLE		
ACCESSIBLE PARKING SPACE REQ'D (2001 CBC TABLE 11B-6) = 1	11	1	1	13

**PARKING TABULATION**

3

**JERSEY ELEMENTARY SCHOOL**  
LITTLE LAKE CITY SCHOOL DISTRICT  
SANTA FE SPRINGS, CA

**OVERALL SITE PLAN**

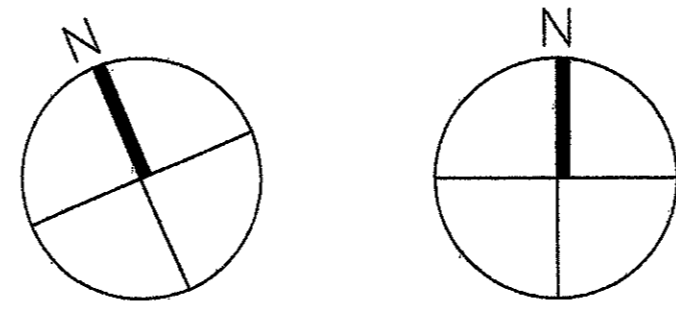

1" = 30'-0" 5 NOT USED

4 NOT USED

NO	DATE	BY	DESCRIPTION

REVISIONS

**OVERALL SITE PLAN**

DRAWING NUMBER : **AJ1.1**

CRESSON ST.

MILANO AVE.

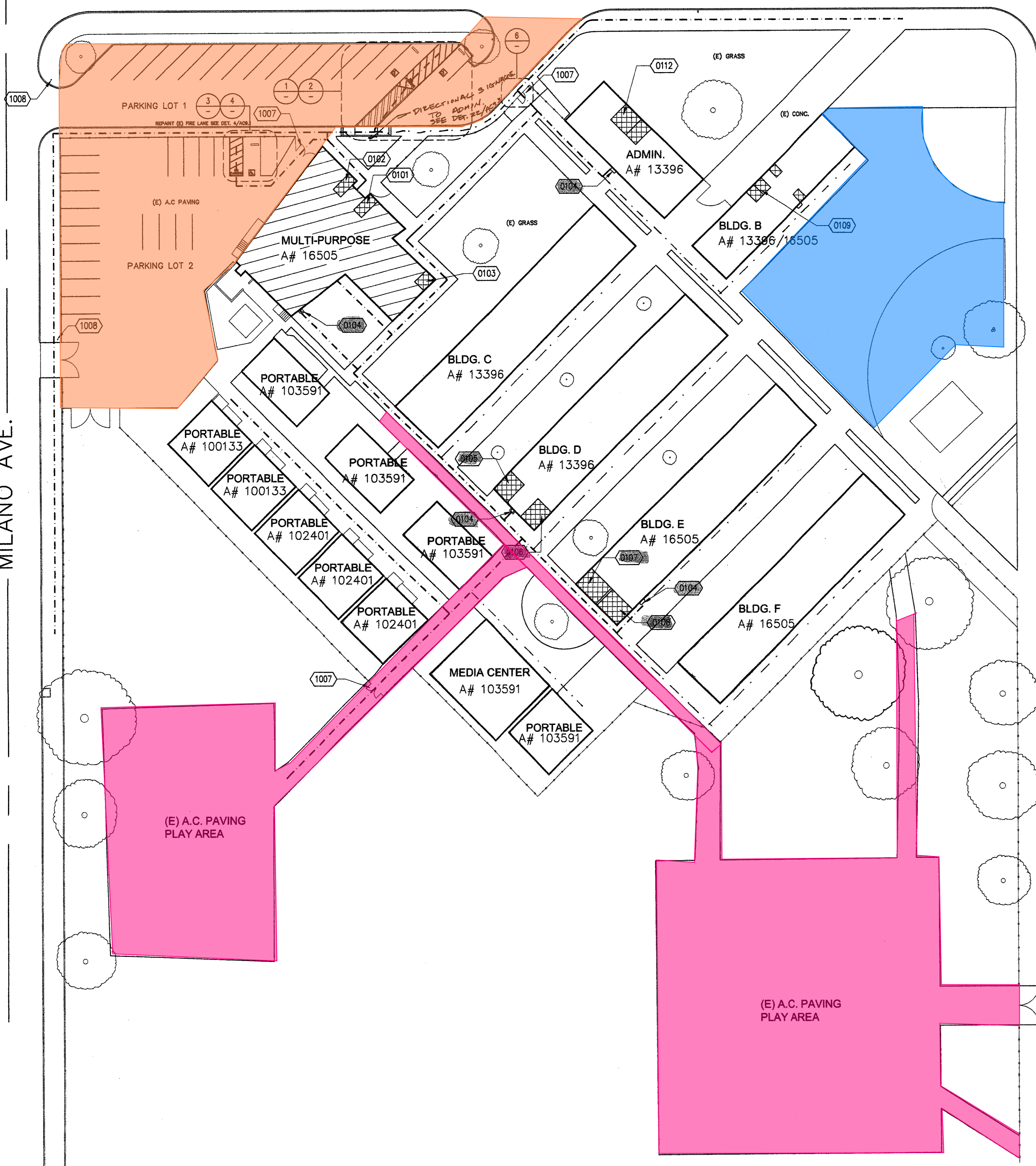

OVERALL SITE PLAN

1" = 30'-0" 5

**Blue Area:**

- Contractor to provide 1000' lineal feet of hot crack fill. Contractor to figure the cracks are 2" wide.
- Contractor to provide 750 square feet of random patches of removal and replacement of 6" asphalt and 6" base. prior to slurry seal coat
- Contractor to provide striping to match existing.
- Contractor shall clean existing surface thoroughly prior to applying 1st coat. -Contractor to provide any grinding needed for new asphalt to transition to existing.
- Contractor shall figure to remove and reinstall all wheel stomps and reinstall after completion of slurry coat.
- Contractor shall paint curb to match existing.
- Contractor to provide new redwood header as needed where asphalt doesn't abut to concrete

**Orange Area:**

- Contractor to provide removal of existing 6" asphalt and 6" base.
- Remove any native or imported fill to allow for new asphalt and base to be installed.
- Contractor to provide 4" asphalt over 4" of base.
- Provide all compaction and grading to meet ADA Requirements. Subgrade, base and asphalt to be compacted to 95%
- Contractor shall clean existing surface thoroughly prior to applying 1st coat.
- Contractor to provide any grinding needed for new asphalt to transition to existing
- Contractor to provide striping to match existing.

**Pink Area:**

- Contractor to provide removal of existing 6" asphalt and 6" base.
- Remove any native or imported fill to allow for new concrete to be installed.
- Contractor to provide 5" of concrete over compacted imported fill or native sub soil. sub grade to be compacted to 95%
- Contractor to provide concrete wire mesh for reinforcement and drill, epoxy No. 4's 16" OC to existing concrete.
- Contractor shall provide all compaction to 95% and grading to meet ADA Requirements

PATH OF TRAVEL (P.O.T.) AS INDICATED IS A BARRIER FREE ACCESS AT LEAST 48" WIDE WITHOUT ANY ABRUPT VERTICAL CHANGES EXCEEDING 1/2" AT 1:12 MAXIMUM SLOPE, EXCEPT THAT LEVEL CHANGES DO NOT EXCEED 1/4" VERTICAL. MAXIMUM CROSS-SLOPE 2% TYPICAL AND SLOPE IN THE DIRECTION OF TRAVEL DOES NOT EXCEED 5% UNLESS OTHERWISE NOTED. THE CONTRACTOR SHALL VERIFY THAT ALL BARRIERS ON THE INDICATED PATH OF TRAVEL HAVE BEEN REMOVED.

PATH OF TRAVEL

PARKING LOT 1		STALL TYPE			
TOTAL PARKING SPACES = 15		STANDARD		ACCESSIBLE	
ACCESSIBLE PARKING SPACE REQ'D (2001 CBC TABLE 11B-6) = 1		STANDARD	VAN	TOTAL	
		13	1	1	15

PARKING LOT 2		STALL TYPE			
TOTAL PARKING SPACES = 19		STANDARD		ACCESSIBLE	
ACCESSIBLE PARKING SPACE REQ'D (2001 CBC TABLE 11B-6) = 1		STANDARD	VAN	TOTAL	
		17	1	1	19

PARKING TABULATION

X			
---	--	--	--

**CRESSON ELEMENTARY SCHOOL**  
 LITTLE LAKE CITY SCHOOL DISTRICT  
 NORWALK, CA

△				
△				
△				
△				
NO	DATE	BY	DESCRIPTION	
REVISIONS				

OVERALL SITE PLAN

DRAWING NUMBER : **AC1.1**

8 NOT USED 7

NOT USED

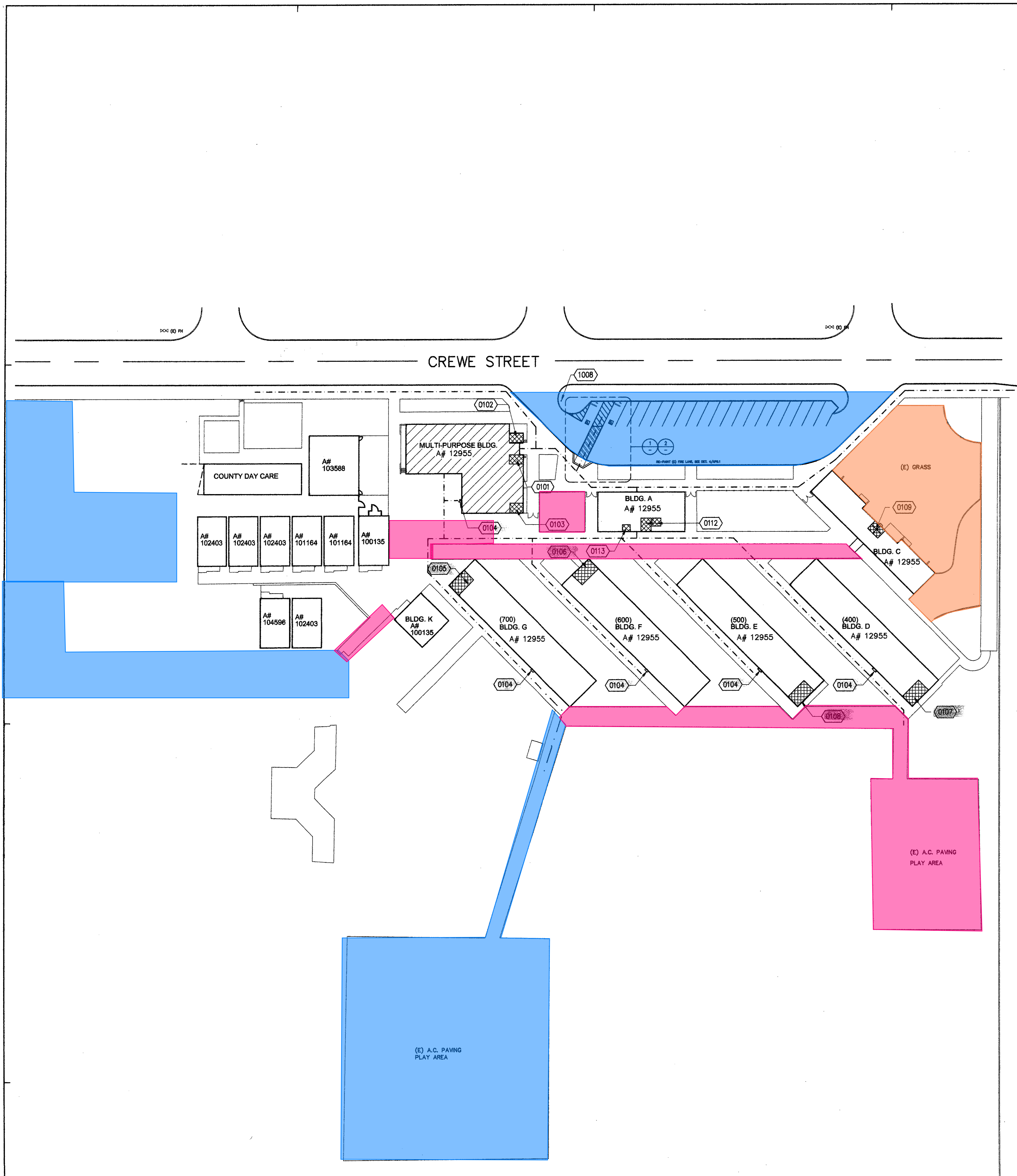

-Contractor to provide 1000' lineal feet of hot crack fill. Contractor to figure the cracks are 2" wide.  
 -Contractor to provide 750 square feet of random patches of removal and replacement of 6" asphalt and 6" base. prior to slurry seal coat  
 -Contractor to provide striping to match existing.  
 -Contractor shall clean existing surface thoroughly prior to applying 1st coat. -Contractor to provide any grinding needed for new asphalt to transition to existing.  
 -Contractor shall figure to remove and reinstall all wheel stumps and reinstall after completion of slurry coat.  
 -Contractor shall paint curb to match existing.  
 -Contractor to provide new redwood header as needed where asphalt doesn't abut to concrete

-Contractor to provide removal of existing 6" asphalt and 6" base.  
 -Remove any native or imported fill to allow for new asphalt and base to be installed.  
 -Contractor to provide 4" asphalt over 4" of base.  
 -Provide all compaction and grading to meet ADA Requirements. Subgrade, base and asphalt to be compacted to 95%  
 -Contractor shall clean existing surface thoroughly prior to applying 1st coat.  
 -Contractor to provide any grinding needed for new asphalt to transition to existing  
 -Contractor to provide striping to match existing.

-Contractor to provide removal of existing 6" asphalt and 6" base.  
 -Remove any native or imported fill to allow for new concrete to be installed.  
 -Contractor to provide 5" of concrete over compacted imported fill or native sub soil. sub grade to be compacted to 95%  
 -Contractor to provide concrete wire mesh for reinforcement and drill, epoxy No. 4's 16" OC to existing concrete.  
 -Contractor shall provide all compaction to 95% and grading to meet ADA Requirements

PATH OF TRAVEL (P.O.T.) AS INDICATED IS A BARRIER FREE ACCESS AT LEAST 48" WIDE WITHOUT ANY ABRUPT VERTICAL CHANGES EXCEEDING 1/2" AT 1:12 MAXIMUM SLOPE, EXCEPT THAT LEVEL CHANGES DO NOT EXCEED 1/4" VERTICAL. MAXIMUM CROSS-SLOPE 2% TYPICAL AND SLOPE IN THE DIRECTION OF TRAVEL DOES NOT EXCEED 5% UNLESS OTHERWISE NOTED. THE CONTRACTOR SHALL VERIFY THAT ALL BARRIERS ON THE INDICATED PATH OF TRAVEL HAVE BEEN REMOVED.

**PATH OF TRAVEL**

TOTAL PARKING SPACES = 20	STALL TYPE			TOTAL
	STANDARD	ACCESSIBLE		
ACCESSIBLE PARKING SPACE REQ'D (2001 CBC TABLE 11B-6) = 2	18	1	1	20

**PARKING TABULATION**

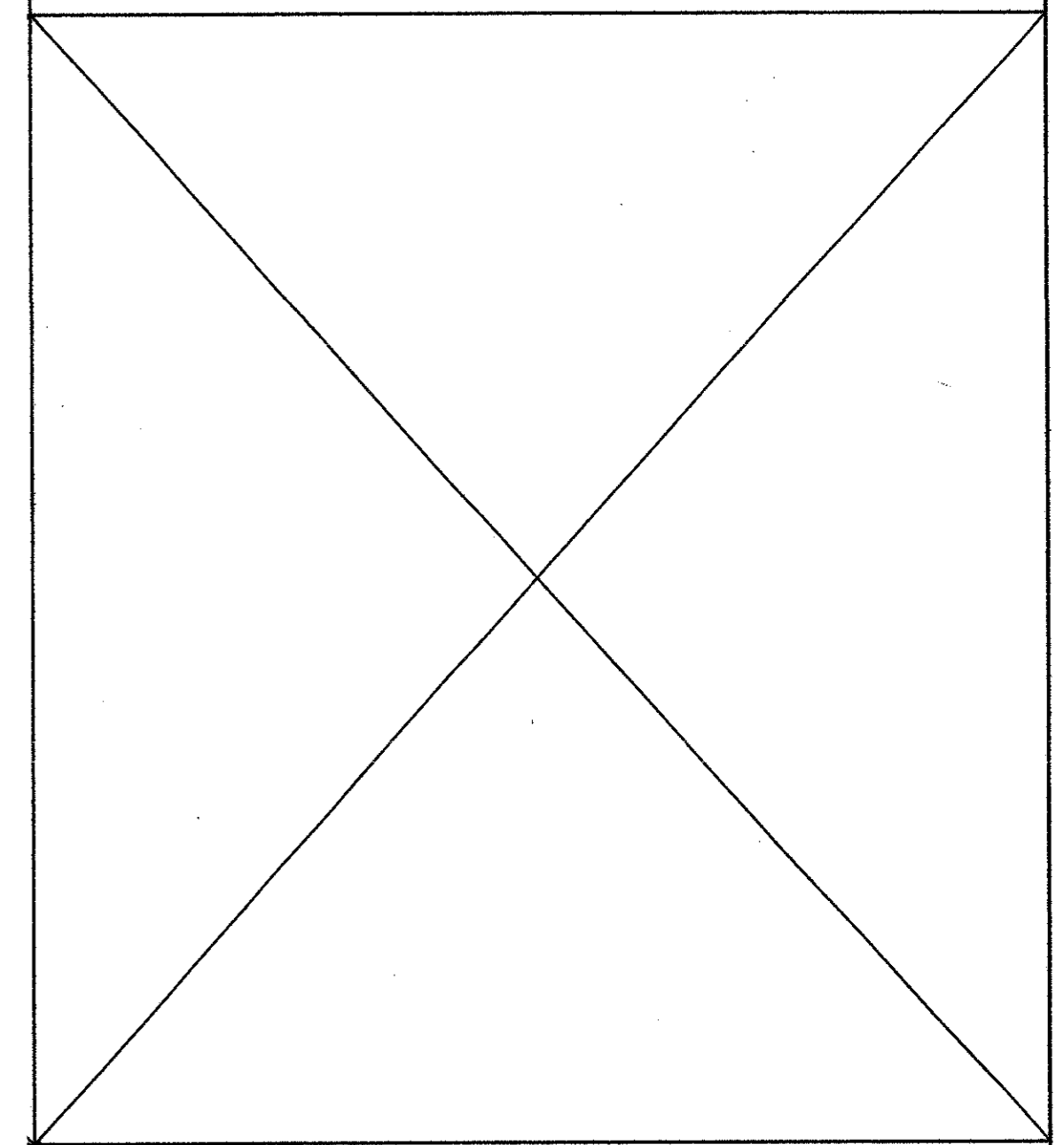

**PADDISON ELEMENTARY SCHOOL**  
 LITTLE LAKE CITY SCHOOL DISTRICT  
 NORWALK, CA

**OVERALL SITE PLAN**

1" = 40'-0" 5

NOT USED

4

NOT USED

NO	DATE	BY	DESCRIPTION

REVISIONS

**OVERALL SITE PLAN**

DRAWING NUMBER: **AP1.1**

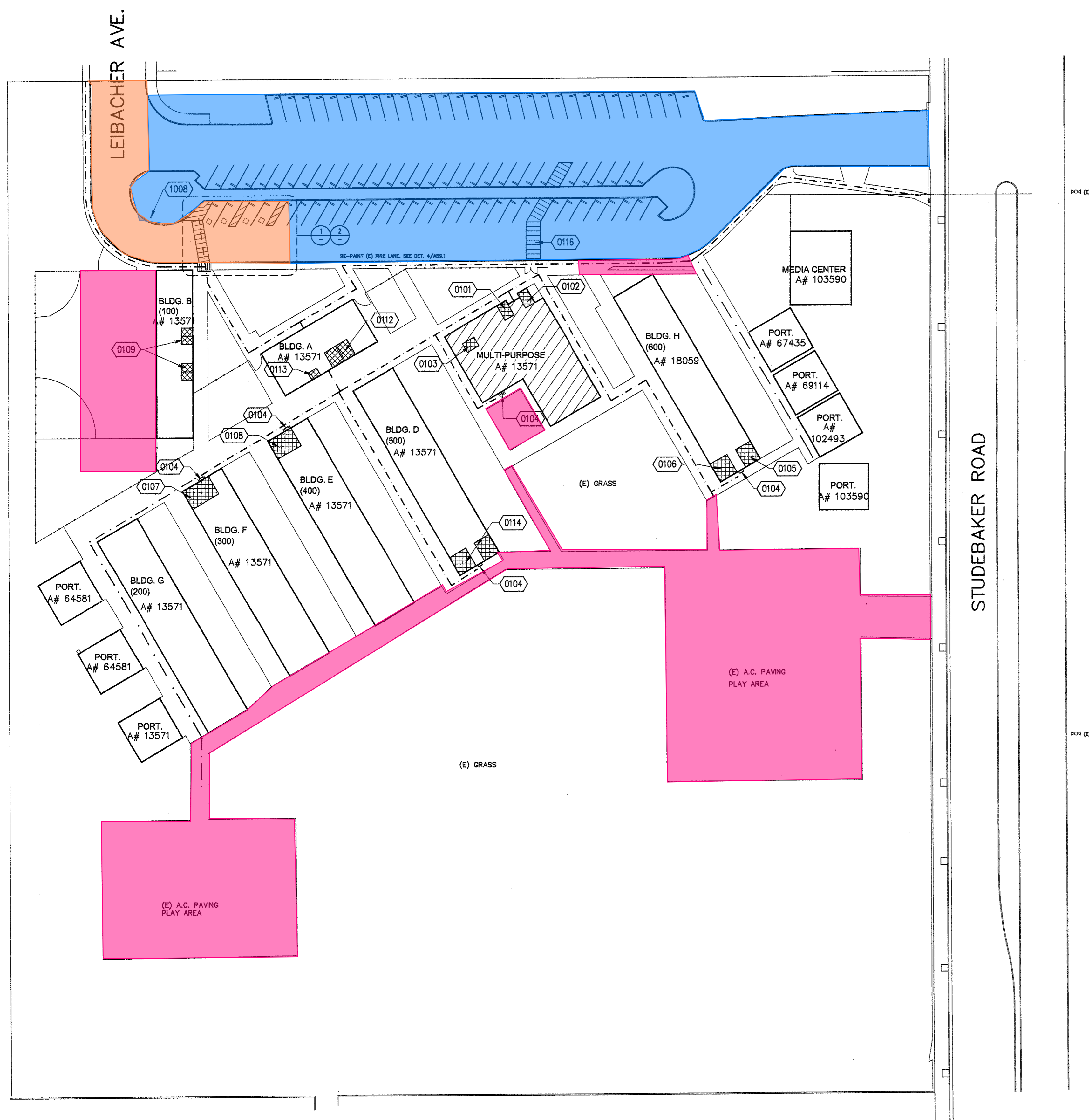

**Blue Area:**

- Contractor to provide 1000' lineal feet of hot crack fill. Contractor to figure the cracks are 2" wide.
- Contractor to provide 750 square feet of random patches of removal and replacement of 6" asphalt and 6" base. prior to slurry seal coat
- Contractor to provide striping to match existing.
- Contractor shall clean existing surface thoroughly prior to applying 1st coat. -Contractor to provide any grinding needed for new asphalt to transition to existing.
- Contractor shall figure to remove and reinstall all wheel stops and reinstall after completion of slurry coat.
- Contractor shall paint curb to match existing.
- Contractor to provide new redwood header as needed where asphalt doesn't abut to concrete

**Orange Area:**

- Contractor to provide removal of existing 6" asphalt and 6" base.
- Remove any native or imported fill to allow for new asphalt and base to be installed.
- Contractor to provide 4" asphalt over 4" of base.
- Provide all compaction and grading to meet ADA Requirements. Subgrade, base and asphalt to be compacted to 95% -Contractor shall clean existing surface thoroughly prior to applying 1st coat. -Contractor to provide any grinding needed for new asphalt to transition to existing
- Contractor to provide striping to match existing.

**Pink Area:**

- Contractor to provide removal of existing 6" asphalt and 6" base.
- Remove any native or imported fill to allow for new concrete to be installed. -Contractor to provide 5" of concrete over compacted imported fill or native sub soil. sub grade to be compacted to 95%
- Contractor to provide concrete wire mesh for reinforcement and drill, epoxy No. 4's 16" OC to existing concrete.
- Contractor shall provide all compaction to 95% and grading to meet ADA Requirements

PATH OF TRAVEL (P.O.T.) AS INDICATED IS A BARRIER FREE ACCESS AT LEAST 48" WIDE WITHOUT ANY ABRUPT VERTICAL CHANGES EXCEEDING 1/2" AT 1:12 MAXIMUM SLOPE, EXCEPT THAT LEVEL CHANGES DO NOT EXCEED 1/4" VERTICAL. MAXIMUM CROSS-SLOPE 2% TYPICAL AND SLOPE IN THE DIRECTION OF TRAVEL DOES NOT EXCEED 5%. UNLESS OTHERWISE NOTED. THE CONTRACTOR SHALL VERIFY THAT ALL BARRIERS ON THE INDICATED PATH OF TRAVEL HAVE BEEN REMOVED.

**PATH OF TRAVEL**

TOTAL PARKING SPACES = 90	STALL TYPE			
ACCESSIBLE PARKING SPACE REQ'D (2001 CBC TABLE 11B-6) = 4	STANDARD	ACCESSIBLE		TOTAL
	86	STANDARD	VAN	90

**PARKING TABULATION**

**STUEBAKER ELEMENTARY SCHOOL**  
LITTLE LAKE CITY SCHOOL DISTRICT  
NORWALK, CA

NO	DATE	BY	DESCRIPTION
REVISIONS			

**OVERALL SITE PLAN**

DRAWING NUMBER : **AS1.1**

**OVERALL SITE PLAN**

1" = 40'-0" 3

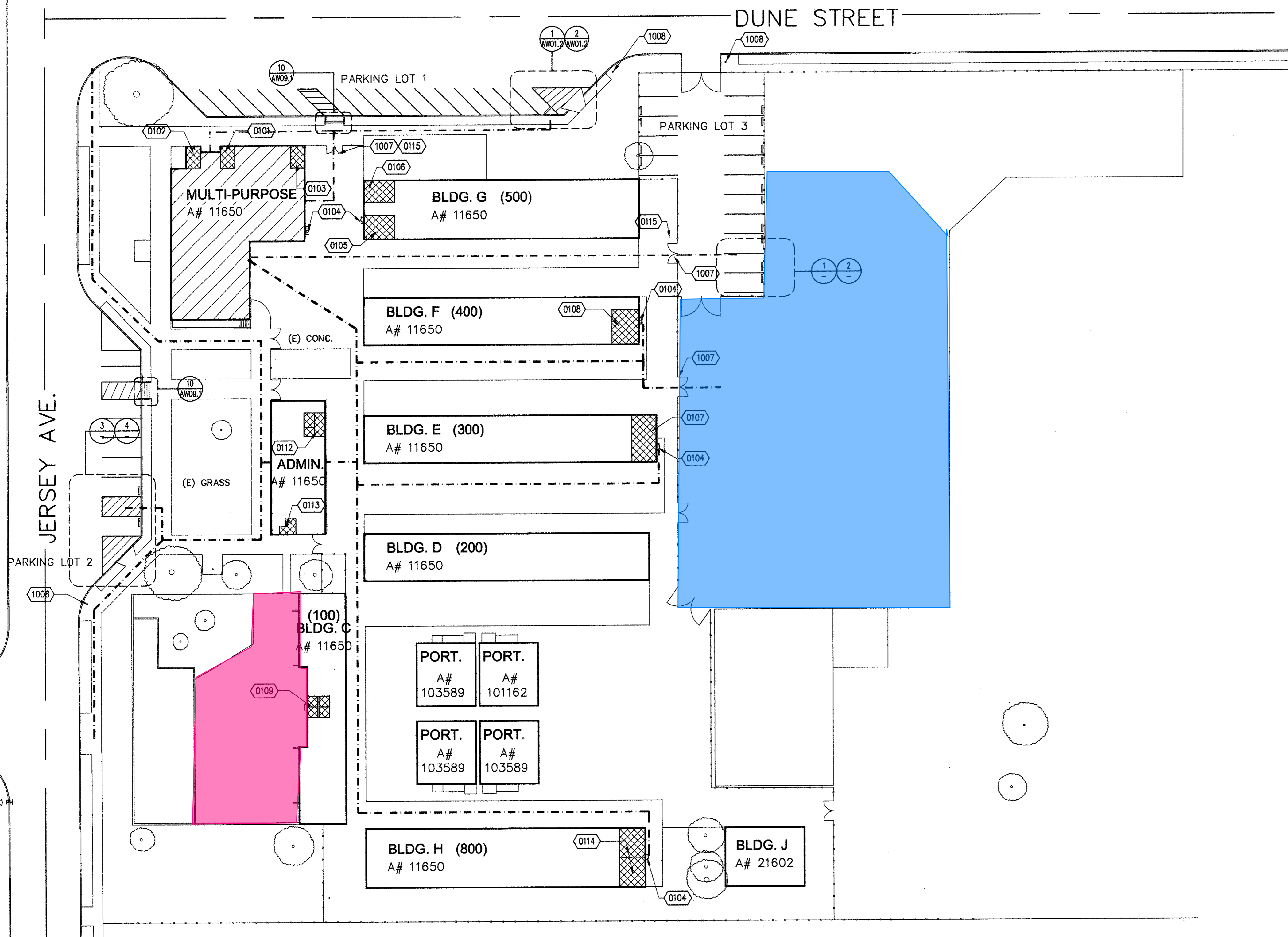

**Blue Area:**

- Contractor to provide 1000' lineal feet of hot crack fill. Contractor to figure the cracks are 2" wide.
- Contractor to provide 750 square feet of random patches of removal and replacement of 6" asphalt and 6" base. prior to slurry seal coat
- Contractor to provide striping to match existing.
- Contractor shall clean existing surface thoroughly prior to applying 1st coat.
- Contractor to provide any grinding needed for new asphalt to transition to existing.
- Contractor shall figure to remove and reinstall all wheel stumps and reinstall after completion of slurry coat.
- Contractor shall paint curb to match existing.
- Contractor to provide new redwood header as needed where asphalt doesn't abut to concrete

**Orange Area:**

- Contractor to provide removal of existing 6" asphalt and 6" base.
- Remove any native or imported fill to allow for new asphalt and base to be installed.
- Contractor to provide 4" asphalt over 4" of base.
- Provide all compaction and grading to meet ADA Requirements. Subgrade, base and asphalt to be compacted to 95%
- Contractor shall clean existing surface thoroughly prior to applying 1st coat.
- Contractor to provide any grinding needed for new asphalt to transition to existing
- Contractor to provide striping to match existing.

**Pink Area:**

- Contractor to provide removal of existing 6" asphalt and 6" base.
- Remove any native or imported fill to allow for new concrete to be installed.
- Contractor to provide 5" of concrete over compacted imported fill or native sub soil. sub grade to be compacted to 95%
- Contractor to provide concrete wire mesh for reinforcement and drill, epoxy No. 4's 16" OC to existing concrete.
- Contractor shall provide all compaction to 95% and grading to meet ADA Requirements

**MULTI-PURPOSE ROOM RENOVATION**  
**WILLIAM ORR ELEMENTARY SCHOOL**  
 LITTLE LAKE CITY SCHOOL DISTRICT  
 NORWALK, CA

NO	DATE	BY	DESCRIPTION

REVISIONS

**OVERALL**  
**SITE**  
**PLAN**

DRAWING NUMBER **AWO1.1**

**OVERALL SITE PLAN**

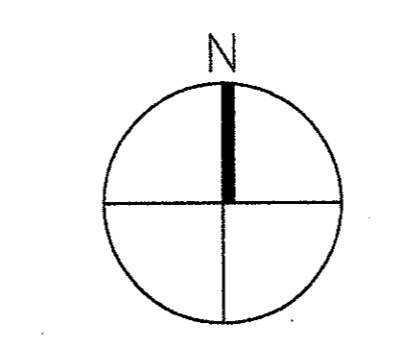

1" = 30'-0" 5

cover the plan per drawing 1/ALL.1.1 on previous page

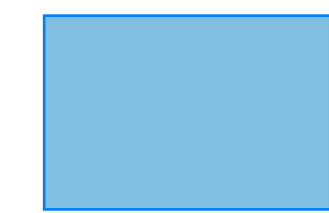

- Contractor to provide 1000' lineal feet of hot crack fill. Contractor to figure the cracks are 2" wide.
- Contractor to provide 750 square feet of random patches of removal and replacement of 6" asphalt and 6" base. prior to slurry seal coat
- Contractor to provide striping to match existing.
- Contractor shall clean existing surface thoroughly prior to applying 1st coat.
- Contractor to provide any grinding needed for new asphalt to transition to existing.
- Contractor shall figure to remove and reinstall all wheel stomps and reinstall after completion of slurry coat.
- Contractor shall paint curb to match existing.
- Contractor to provide new redwood header as needed where asphalt doesn't abut to concrete

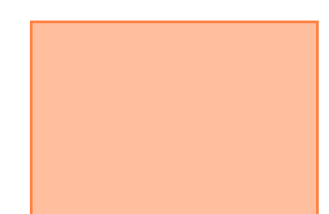

- Contractor to provide removal of existing 6" asphalt and 6" base.
- Remove any native or imported fill to allow for new asphalt and base to be installed.
- Contractor to provide 4" asphalt over 4" of base.
- Provide all compaction and grading to meet ADA Requirements. Subgrade, base and asphalt to be compacted to 95% -Contractor shall clean existing surface thoroughly prior to applying 1st coat. -Contractor to provide any grinding needed for new asphalt to transition to existing
- Contractor to provide striping to match existing.



- Contractor to provide removal of existing 6" asphalt and 6" base.
- Remove any native or imported fill to allow for new concrete to be installed. -Contractor to provide 5" of concrete over compacted imported fill or native sub soil. sub grade to be compacted to 95%
- Contractor to provide concrete wire mesh for reinforcement and drill, epoxy No. 4's 16" OC to existing concrete.
- Contractor shall provide all compaction to 95% and grading to meet ADA Requirements

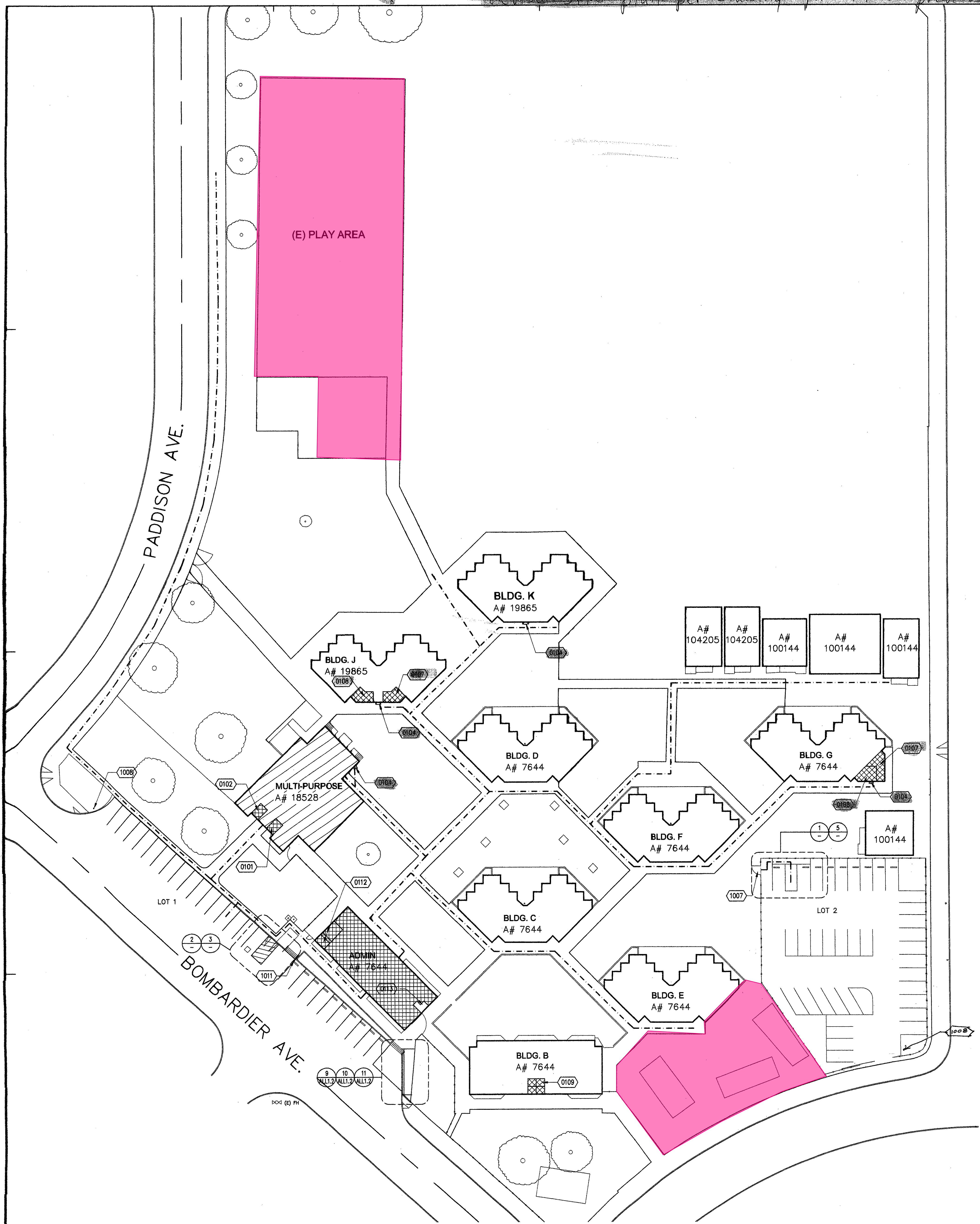

**MULTI-PURPOSE ROOM RENOVATION**  
**LAKELAND ELEMENTARY SCHOOL**  
 LITTLE LAKE CITY SCHOOL DISTRICT  
 NORWALK, CA

NO	DATE	BY	DESCRIPTION

REVISIONS

**OVERALL SITE PLAN**

DRAWING NUMBER : **ALL.1.1**

**OVERALL SITE PLAN**

1" = 30'-0" 6