



ADDENDUM NO. 1

TO: All Registered Bidders
DATE: April 27, 2022
PROJECT: Little Lake City School District
Miscellaneous Hardscape Improvements at Multiple Sites
CONTACT: Milo Oostinga, Ledesma & Meyer Construction Co., Inc.

This Addendum forms a part of the Contract Documents for the Project described above and shall supersede referenced sections of the original Bidding Documents. This Addendum is an integral part of said Bidding Documents and shall be acknowledged in the Contractor’s Bid Proposal form. Failure to acknowledge receipt of this Addendum in the Bid may cause the Bid to be rejected.

INSTRUCTIONS AND PROCEDURES

The following changes, omissions and/or additions to the Bid Specification shall apply to proposals made for and to the execution of the various parts of the work affected thereby, and all other conditions shall remain the same.

Careful note of the Addendum shall be taken by all parties of interest so that the proper allowance may be made in all computations and estimates, and all trades affected shall be fully advised in the performance of the work which will be required of them.

In case of conflict between the Drawings, Specifications, and this Addendum, this Addendum shall govern.

GENERAL NOTES

- 1.1 Add Little Lake City School District AmeriSci PLM Bulk Asbestos Reports listed below in their entirety.
 - a. William Orr ES PLM Bulk Asbestos Report, Dated April 25, 2022.
 - b. Lakeland ES PLM Bulk Asbestos Report, Dated April 25, 2022
 - c. Cresson ES PLM Bulk Asbestos Report, Dated April 26, 2022

BIDDING & PROCUREMENT MANUAL

- 2.1 Reference Specification Section 01011 Work Scope Special Conditions
 - a. Add in its entirety 01011 Work Scope Special Conditions with the attached.
- 3.1 Reference Specification Section 01210 Allowances.
 - a. Paragraph 3.1.1.1, revise to read as follows:
 - i. Jersey ES \$ 60,000.00
 - ii. Cresson ES \$110,000.00
 - iii. Paddison ES \$ 60,000.00
 - iv. Studebaker ES \$110,000.00
 - v. William Oee ES \$ 25,000.00
 - vi. Lakeland ES \$ 85,000.00

- b. Paragraph 3.1.2, revise to read as follows:
Cash allowances shall be "net" amounts. Category contractors shall include all costs associated with the processing of items that may be charged against the designated allowance amount including estimating, project management, supervision, withholding of retention, overhead, profit, insurance and bond costs in their base bid. **The Category Contractor and any Subcontractor shall be permitted to charge only its direct cost plus markup not to exceed 5%.** If any allowance amount (in whole or in part) is deleted by change order at any given point during the project, the Category Contractor shall credit back the full or unused portion of the allowance amount stipulated. The Category Contractor shall not be entitled to withhold any monies for overhead or profit. The use of any allowances is at the sole discretion of the Construction Manager.

4.1 Reference Section 01310 Construction Schedule

- a. Add in its entirety.

5.1 Reference Specification Section 321123 Aggregate Base Course

- a. Add in its entirety Specification Section 321123 Aggregate Base Course with the attached.

6.1 Reference Specification Section 321216 Asphalt Paving

- a. Replace in its entirety Specification Section 321216 Asphalt Paving with the attached.

7.1 Reference Specification Section 321723.13 Painted Pavement Markings

- a. Replace in its entirety Specification Section 321723.13 Painted Pavement Markings with the attached.

DRAWINGS

8.1 Replace the following Sheets with the attached Addendum 1 Sheets

- a. Sheet AJ1.1 Overall Site Plan (Jersey Elementary School)
- b. Sheet AC1.1 Overall Site Plan (Cresson Elementary School)
- c. Sheet AP1.1 Overall Site Plan (Paddison Elementary School)
- d. Sheet AS1.1 Overall Site Plan (Studebaker Elementary School)
- e. Sheet AWO1.1 Overall Site Plan (William Orr Elementary School)
- f. Sheet ALL1.1 Overall Site Plan (Lakeland Elementary School)

END OF ADDENDUM NO. 1



Please Reply To:

AmeriSci Los Angeles

24416 S. Main Street, Ste 308

Carson, California 90745

TEL: (310) 834-4868 • FAX: (310) 834-4772

William Orr ES

LABORATORY ELECTRONIC TRANSMITTAL

To: Yesenia Galeana
Executive Environmental Services Corporatio

From: Dennis Liu

Fax #:

AmeriSci Job #: 922041368

Subject: PLM 5 day Results

Client Project: 22-Z0187-0043; Campus

Email: info@execenv.com, ygaleana@execenv.com

Date: Monday, April 25, 2022

Time: 17:37:00

Comments:

Number of Pages: _____
(including cover sheet)

NOTE: Attached report is to be considered preliminary until final review with accompanying analysis summary letter is issued.

CONFIDENTIALITY NOTICE: Unless otherwise indicated, the information contained in this communication is confidential information intended for use of the individual named above. If the reader of this communication is not the intended recipient, you are hereby notified that any dissemination, distribution or copying of this communication is prohibited. If you have received this communication in error, please immediately notify the sender by telephone and return the original message to the above address via the US Postal Service at our expense. Samples are disposed of in 60 days or unless otherwise instructed by the protocol or special instructions in writing. Thank you.

Certified Analysis Service 24 Hours A Day • 7 Days A Week Competitive Prices
visit our web site - www.amerisci.com

Boston • Los Angeles • New York • Richmond



AmeriSci Los Angeles

24416 S. Main Street, Ste 308
Carson, California 90745
TEL: (310) 834-4868 • FAX: (310) 834-4772

PLM Bulk Asbestos Report

Executive Environmental Services Corpor **Date Received** 04/18/22 **AmeriSci Job #** 922041368
Attn: Yesenia Galeana **Date Examined** 04/23/22 **P.O. #**
310 East Foothill Blvd. **Page** 1 of 3
Suite 200 **RE:** 22-Z0187-0043; Campus
Arcadia, CA 91006

Client No. / HGA	Lab No.	Asbestos Present	Total % Asbestos
2204150043RK-01 Location: Area 1, NE Parking Lot / Asphalt Paving / Area 1 (NE Parking Lot, East Playground, SE Around Portables 901-904 And Library) Analyst Description: Black, Heterogeneous, Non-Fibrous, Asphalt Asbestos Types: Other Material: Non-fibrous 100%	922041368-01	No	NAD (by CVES) by Dennis Liu on 04/23/22
2204150043RK-02 Location: Area 1, North At Playground / Asphalt Paving Analyst Description: Black, Heterogeneous, Non-Fibrous, Asphalt Asbestos Types: Other Material: Non-fibrous 100%	922041368-02	No	NAD (by CVES) by Dennis Liu on 04/23/22
2204150043RK-03 Location: Area 1, NE At Playground / Asphalt Paving Analyst Description: Black, Heterogeneous, Non-Fibrous, Asphalt Asbestos Types: Other Material: Non-fibrous 100%	922041368-03	No	NAD (by CVES) by Dennis Liu on 04/23/22
2204150043RK-04 Location: Area 1, West At Playground / Asphalt Paving Analyst Description: Black, Heterogeneous, Non-Fibrous, Asphalt Asbestos Types: Other Material: Non-fibrous 100%	922041368-04	No	NAD (by CVES) by Dennis Liu on 04/23/22
2204150043RK-05 Location: Area 1, Center At Playground / Asphalt Paving Analyst Description: Black, Heterogeneous, Non-Fibrous, Asphalt Asbestos Types: Other Material: Non-fibrous 100%	922041368-05	No	NAD (by CVES) by Dennis Liu on 04/23/22

Client Name: Executive Environmental Services Corporation

PLM Bulk Asbestos Report

22-Z0187-0043; Campus

Client No. / HGA	Lab No.	Asbestos Present	Total % Asbestos
2204150043RK-06 Location: Area 1, East At Playground / Asphalt Paving	922041368-06	No	NAD (by CVES) by Dennis Liu on 04/23/22
Analyst Description: Black, Heterogeneous, Non-Fibrous, Asphalt			
Asbestos Types:			
Other Material: Non-fibrous 100%			
2204150043RK-07 Location: Area 1, South At Playground / Asphalt Paving	922041368-07	No	NAD (by CVES) by Dennis Liu on 04/23/22
Analyst Description: Black, Heterogeneous, Non-Fibrous, Asphalt			
Asbestos Types:			
Other Material: Non-fibrous 100%			
2204150043RK-08 Location: Area 1, SE-West Of Play Area / Asphalt Paving	922041368-08	No	NAD (by CVES) by Dennis Liu on 04/23/22
Analyst Description: Black, Heterogeneous, Non-Fibrous, Asphalt			
Asbestos Types:			
Other Material: Non-fibrous 100%			
2204150043RK-09 Location: Area 1, SW Near Portables / Asphalt Paving	922041368-09	No	NAD (by CVES) by Dennis Liu on 04/23/22
Analyst Description: Black, Heterogeneous, Non-Fibrous, Asphalt			
Asbestos Types:			
Other Material: Non-fibrous 100%			
2204150043RK-10 Location: Area 2, South / Asphalt Paving / Area 2 (Building 100 Playground)	922041368-10	No	NAD (by CVES) by Dennis Liu on 04/23/22
Analyst Description: Black, Heterogeneous, Non-Fibrous, Asphalt			
Asbestos Types:			
Other Material: Non-fibrous 100%			
2204150043RK-11 Location: Area 2, SE / Asphalt Paving	922041368-11	No	NAD (by CVES) by Dennis Liu on 04/23/22
Analyst Description: Black, Heterogeneous, Non-Fibrous, Asphalt			
Asbestos Types:			
Other Material: Non-fibrous 100%			

PLM Bulk Asbestos Report

22-Z0187-0043; Campus

Client No. / HGA	Lab No.	Asbestos Present	Total % Asbestos
2204150043RK-12 Location: Area 2, West / Asphalt Paving	922041368-12	No	NAD (by CVES) by Dennis Liu on 04/23/22
Analyst Description: Black, Heterogeneous, Non-Fibrous, Asphalt			
Asbestos Types:			
Other Material: Non-fibrous 100%			
2204150043RK-13 Location: Area 2, East / Asphalt Paving	922041368-13	No	NAD (by CVES) by Dennis Liu on 04/23/22
Analyst Description: Black, Heterogeneous, Non-Fibrous, Asphalt			
Asbestos Types:			
Other Material: Non-fibrous 100%			
2204150043RK-14 Location: Area 2, North / Asphalt Paving	922041368-14	No	NAD (by CVES) by Dennis Liu on 04/23/22
Analyst Description: Black, Heterogeneous, Non-Fibrous, Asphalt			
Asbestos Types:			
Other Material: Non-fibrous 100%			

Reporting Notes:

Analyzed by: Dennis Liu
Date: 4/23/2022



Reviewed by: Lateef McIntosh



*NAD = no asbestos detected; Detection Limit <1%; Reporting Limits: CVES = 1%, 400 Pt Ct = 0.25%, 1000 Pt Ct = 0.1%; NA = not analyzed; NA/PS = not analyzed / positive stop; NVA = No Visible Asbestos; PLM (polarized light microscopy) Bulk Asbestos Analysis by EPA 600/R-93/116, including requirements for EPA 600/M4-82-020 per 40 CFR 763 (NVLAP Lab #200346-0); Note: PLM is not consistently reliable in detecting asbestos in floor coverings and similar NOB materials. TEM is currently the only method that can be used to determine if this material can be considered or treated as non-asbestos-containing in New York State (also see EPA Advisory for floor tile, FR 59, 146, 38970, 8/1/94). NIST Accreditation requirements mandate that this report must not be reproduced except in full with the approval of the laboratory. This PLM report relates ONLY to the items tested.



Industrial Hygiene Laboratory Submittal
Asbestos -- PLM

922041868

Originating Office
310 E. Foothill Blvd., Suite 200
Arcadia, CA 91006
Phone: 626.441.7050
Fax: 626.441.0016

Lab Submitted to:
 AmerSci
 EMI Lab (Glendale)
 LA Testing

Routine (5 Working Days)
 RUSH (surcharges may apply)
Circle One hours hours hours hours days

Project #:
22-Z0187-0043

Sampled by:
Rhys Kuzmic

Site Zip Code:
90650

Sample Date:
04/15/2022

Page 1 of 2

The receiving Laboratory is required to complete the following:

- All invoices are to be sent to: 310 E. Foothill Blvd., Suite 200, Arcadia, CA 91006 with a copy of the lab report.
- Analyze all samples by PLM by EPA 600/R-93/116.
- Stop analysis of homogeneous groups at first positive that is greater than or equal to 1.0%
- All lab reports and invoices are to contain the Project Number from above.
- Unsigned and reports marked draft are unacceptable.
- Report to the attention of: Yessenia Galeana, Phone: (562) 889-1327

Optional items to be completed by the laboratory (if check marked): Email Report to: Info@execenv.com Other: ygaleana@execenv.com;

US Mail Report to: Originating office check marked above Other: Alternate billing address:

Sample No.:	Sample Location - Include Room Information where appropriate	Material Description	Homogeneous Location	No.	Quantity	Percent Damaged
-01	Area 1, NE Parking lot	Asphalt pavers	Area 1 CNE parking lot, east playground, SE ground	1	50,000 sq	<1
-02	Area 1, north of playground	↓	Portables 901-904 and Library			
-03	Area 1, NE of playground					
-04	Area 1, West of playground					
-05	Area 1, center of playground					
-06	Area 1, east of playground					
-07	Area 1, south of playground					

Prefix: 2204150043RK

Notes:

Released By, Date, & Time: PLM X 04/15/2022 1:10PM

Received By, Date, & Time: YGR 4/15/2022 8:00

Released By, Date, & Time:



Industrial Hygiene Laboratory Submittal
Asbestos -- PLM

922041868

Originating Office
310 E. Foothill Blvd., Suite 200
Arcadia, CA 91006
Phone: 626.441.7050
Fax: 626.441.0016

Lab Submitted to:
 AmeriSci
 EMLab (Glendale)
 LA Testing

Routine (5 Working Days) RUSH (surcharges may apply) Circle One 6 hours 24 hours 48 hours 3 to 5 days

Project #: 22-20187-0043

Sampled by: Rhys Kuzmic

Site Zip Code: 90650

Sample Date: 04/15/2022

Page 2 of 2

The receiving Laboratory is required to complete the following:

Building Name: Campus

- All invoices are to be sent to: 310 E. Foothill Blvd., Suite 200, Arcadia, CA 91006 with a copy of the lab report.
- Analyze all samples by PLM by EPA 600/R-93/116.
- Stop analysis of homogeneous groups at first positive that is greater than or equal to 1.0%
- All lab reports and invoices are to contain the Project Number from above.
- Unsigned and reports marked draft are unacceptable.
- Report to the attention of: Yesenia Galeana, Phone: (562) 889-1327

Optional items to be completed by the laboratory (if check marked): US Mail Report to: Originating office check marked above Other: Alternate billing address: Email Report to: Info@excecenv.com Other: ygaleana@excecenv.com

Prefix: 2204150043RK

Sample No.:	Sample Location - Include Room information where appropriate	Material Description	Homogeneous Location	No.	Quantity	Percent Damaged
-08	Area 1, SE - West of play area	Asphalt Pavms (concrete)		1		
-09	Area 1, SW near Portables	↓				
-10	Area 2, South	Asphalt Pavms	Area 2 (Building 100 playground)	2	6,500 SF	<1
-11	Area 2, SE					
-12	Area 2, West					
-13	Area 2, East					
-14	Area 2, North					

Notes:

Released By, Date, & Time: PLM 04/15/2022 1:10PM

Received By, Date, & Time: JKR 4/18/2022 8:00

Released By, Date, & Time:

Rev. 1/19 Form: AL-006PLM



Please Reply To:

AmeriSci Los Angeles

24416 S. Main Street, Ste 308

Carson, California 90745

TEL: (310) 834-4868 • FAX: (310) 834-4772

Lakeland ES

LABORATORY ELECTRONIC TRANSMITTAL

To: Yesenia Galeana
Executive Environmental Services Corporatio

From: Dennis Liu

Fax #:

AmeriSci Job #: 922041367

Subject: PLM 5 day Results

Client Project: 22-Z0187-0044; Campus

Email: info@execenv.com, ygaleana@execenv.com

Date: Monday, April 25, 2022

Time: 14:54:52

Comments:

Number of Pages: _____
(including cover sheet)

NOTE: Attached report is to be considered preliminary until final review with accompanying analysis summary letter is issued.

CONFIDENTIALITY NOTICE: Unless otherwise indicated, the information contained in this communication is confidential information intended for use of the individual named above. If the reader of this communication is not the intended recipient, you are hereby notified that any dissemination, distribution or copying of this communication is prohibited. If you have received this communication in error, please immediately notify the sender by telephone and return the original message to the above address via the US Postal Service at our expense. Samples are disposed of in 60 days or unless otherwise instructed by the protocol or special instructions in writing. Thank you.

Certified Analysis Service 24 Hours A Day • 7 Days A Week Competitive Prices
visit our web site - www.amerisci.com

Boston • Los Angeles • New York • Richmond



AmeriSci Los Angeles

24416 S. Main Street, Ste 308
Carson, California 90745
TEL: (310) 834-4868 • FAX: (310) 834-4772

PLM Bulk Asbestos Report

Executive Environmental Services Corpor **Date Received** 04/18/22 **AmeriSci Job #** 922041367
Attn: Yesenia Galeana **Date Examined** 04/23/22 **P.O. #**
310 East Foothill Blvd. **Page** 1 of 3
Suite 200 **RE: 22-Z0187-0044; Campus**
Arcadia, CA 91006

Client No. / HGA	Lab No.	Asbestos Present	Total % Asbestos
2204150044RK-01 Location: Area 1, NW / Asphalt Paving / Area 1 (NW Playground And North Sides Of Building J And K) Analyst Description: Black, Heterogeneous, Non-Fibrous, Asphalt Asbestos Types: Other Material: Non-fibrous 100%	922041367-01	No	NAD (by CVES) by Dennis Liu on 04/23/22
2204150044RK-02 Location: Area 1, NE / Asphalt Paving Analyst Description: Black, Heterogeneous, Non-Fibrous, Asphalt Asbestos Types: Other Material: Non-fibrous 100%	922041367-02	No	NAD (by CVES) by Dennis Liu on 04/23/22
2204150044RK-03 Location: Area 1, NW / Asphalt Paving Analyst Description: Black, Heterogeneous, Non-Fibrous, Asphalt Asbestos Types: Other Material: Non-fibrous 100%	922041367-03	No	NAD (by CVES) by Dennis Liu on 04/23/22
2204150044RK-04 Location: Area 1, NE / Asphalt Paving Analyst Description: Black, Heterogeneous, Non-Fibrous, Asphalt Asbestos Types: Other Material: Non-fibrous 100%	922041367-04	No	NAD (by CVES) by Dennis Liu on 04/23/22
2204150044RK-05 Location: Area 1, West / Asphalt Paving Analyst Description: Black, Heterogeneous, Non-Fibrous, Asphalt Asbestos Types: Other Material: Non-fibrous 100%	922041367-05	No	NAD (by CVES) by Dennis Liu on 04/23/22

Client Name: Executive Environmental Services Corporation

PLM Bulk Asbestos Report

22-Z0187-0044; Campus

Client No. / HGA	Lab No.	Asbestos Present	Total % Asbestos
2204150044RK-06 Location: Area 1, Center East / Asphalt Paving Analyst Description: Black, Heterogeneous, Non-Fibrous, Asphalt Asbestos Types: Other Material: Non-fibrous 100%	922041367-06	No	NAD (by CVES) by Dennis Liu on 04/23/22
2204150044RK-07 Location: Area 1, SE / Asphalt Paving Analyst Description: Black, Heterogeneous, Non-Fibrous, Asphalt Asbestos Types: Other Material: Non-fibrous 100%	922041367-07	No	NAD (by CVES) by Dennis Liu on 04/23/22
2204150044RK-08 Location: Area 1, SW-North Of Building J / Asphalt Paving Analyst Description: Black, Heterogeneous, Non-Fibrous, Asphalt Asbestos Types: Other Material: Non-fibrous 100%	922041367-08	No	NAD (by CVES) by Dennis Liu on 04/23/22
2204150044RK-09 Location: Area 1, SE-North Of Building K / Asphalt Paving Analyst Description: Black, Heterogeneous, Non-Fibrous, Asphalt Asbestos Types: Other Material: Non-fibrous 100%	922041367-09	No	NAD (by CVES) by Dennis Liu on 04/23/22
2204150044RK-10 Location: Area 2, NW / Asphalt Paving / Area (Playground South Of Building E) Analyst Description: Black, Heterogeneous, Non-Fibrous, Asphalt Asbestos Types: Other Material: Non-fibrous 100%	922041367-10	No	NAD (by CVES) by Dennis Liu on 04/23/22
2204150044RK-11 Location: Area 2, North / Asphalt Paving Analyst Description: Black, Heterogeneous, Non-Fibrous, Asphalt Asbestos Types: Other Material: Non-fibrous 100%	922041367-11	No	NAD (by CVES) by Dennis Liu on 04/23/22

PLM Bulk Asbestos Report

22-Z0187-0044; Campus

Client No. / HGA	Lab No.	Asbestos Present	Total % Asbestos
2204150044RK-12 Location: Area 2, NE / Asphalt Paving	922041367-12	No	NAD (by CVES) by Dennis Liu on 04/23/22
Analyst Description: Black, Heterogeneous, Non-Fibrous, Asphalt			
Asbestos Types:			
Other Material: Non-fibrous 100%			
2204150044RK-13 Location: Area 2, SW / Asphalt Paving	922041367-13	No	NAD (by CVES) by Dennis Liu on 04/23/22
Analyst Description: Black, Heterogeneous, Non-Fibrous, Asphalt			
Asbestos Types:			
Other Material: Non-fibrous 100%			
2204150044RK-14 Location: Area 2, SE / Asphalt Paving	922041367-14	No	NAD (by CVES) by Dennis Liu on 04/23/22
Analyst Description: Black, Heterogeneous, Non-Fibrous, Asphalt			
Asbestos Types:			
Other Material: Non-fibrous 100%			

Reporting Notes:

Analyzed by: Dennis Liu
Date: 4/23/2022



Reviewed by: Lateef McIntosh



*NAD = no asbestos detected; Detection Limit <1%; Reporting Limits: CVES = 1%, 400 Pt Ct = 0.25%, 1000 Pt Ct = 0.1%; NA = not analyzed; NA/PS = not analyzed / positive stop; NVA = No Visible Asbestos; PLM (polarized light microscopy) Bulk Asbestos Analysis by EPA 600/R-93/116, including requirements for EPA 600/M4-82-020 per 40 CFR 763 (NVLAP Lab #200346-0); Note: PLM is not consistently reliable in detecting asbestos in floor coverings and similar NOB materials. TEM is currently the only method that can be used to determine if this material can be considered or treated as non-asbestos-containing in New York State (also see EPA Advisory for floor tile, FR 59, 146, 38970, 8/1/94). NIST Accreditation requirements mandate that this report must not be reproduced except in full with the approval of the laboratory. This PLM report relates ONLY to the items tested.



Industrial Hygiene Laboratory Submittal
Asbestos -- PLM

Originating Office
310 E. Foothill Blvd., Suite 200
Arcadia, CA 91006
Phone: 626.441.7050
Fax: 626.441.0016

Lab Submitted to:
 AmeriSci
 EMI Lab (Glendale)
 LA Testing

Routine (5 Working Days)
 RUSH (surcharges may apply)
Circle One hours hours hours hours
3 to 5 days

Project #:
22-Z0187-0044

Sampled by:
Rhys Kuzmick

Site Zip Code:
90650

Sample Date:
04/15/2022

Page 1 of 2

The receiving Laboratory is required to complete the following:

- All invoices are to be sent to: 310 E. Foothill Blvd., Suite 200, Arcadia, CA 91006 with a copy of the lab report.
- Analyze all samples by PLM by EPA 600/R-93/116.
- Stop analysis of homogeneous groups at first positive that is greater than or equal to 1.0%
- All lab reports and invoices are to contain the Project Number from above.
- Unsigned and reports marked draft are unacceptable.
- Report to the attention of: Yesenia Galeana, Phone: (562) 889-1327

Optional items to be completed by the laboratory (if check marked): Email Report to: info@execenrv.com Other: ygaleana@execenrv.com

US Mail Report to: Originating office check marked above Other: Alternate billing address:

Sample No.:	Sample Location - Include Room information where appropriate	Material Description	Homogeneous Location	No.	Quantity	Percent Damaged
-01	Area 1, NW	Asphalt Pavings	Area 1 CNW playground and north side of Buildings (Sample K)	1	28,000 SF	< 1
-02	Area 1, NE					
-03	Area 1, NW					
-04	Area 1, NE					
-05	Area 1, West					
-06	Area 1, Center-east					
-07	Area 1, SE					

Prefix: 2204150044RK

Notes:

Released By, Date, & Time: Rm Ky 04/15/2022 1:10PM

Received By, Date, & Time: RH 4-18-22 8:00

Released By, Date, & Time:



Industrial Hygiene Laboratory Submittal
Asbestos -- PLM

922041367

Originating Office

Lab Submitted to:

310 E. Foothill Blvd., Suite 200
Arcadia, CA 91006
Phone: 626.441.7050
Fax: 626.441.0016

AmeriSci
 EMLab (Glendale)
 LA Testing

Routine (5 Working Days)
 RUSH (surcharges may apply)
Circle One hours hours hours hours 3 to 5 days

Project #:
22-Z0187-0044

Sampled by:
Rhys Kuzmick

Site Zip Code:
90650

Sample Date:
04/15/2022

Page 2 of 2

The receiving Laboratory is required to complete the following:

- All invoices are to be sent to: 310 E. Foothill Blvd., Suite 200, Arcadia, CA 91006 with a copy of the lab report.
- Analyze all samples by PLM by EPA 600/R-93/116.
- Stop analysis of homogeneous groups at first positive that is greater than or equal to 1.0%
- All lab reports and invoices are to contain the Project Number from above.
- Unsigned and reports marked draft are unacceptable.
- Report to the attention of: Yessia Galeana, Phone: (562) 889-1327

Optional items to be completed by the laboratory (if check marked): Email Report to: Info@execenv.com Other: ygaleana@execenv.com

US Mail Report to: Originating office check marked above Other: Alternate billing address:

Sample No.:	Sample Location - Include Room information where appropriate	Material Description	Homogeneous Location	No.	Quantity	Percent Damaged
-08	Area 2, SW - north of Building T	Asphalt Pavement (continued)		1		
-09	Area 2, SE - north of Building R	↓		↓		↓
-10	Area 2, NW	Asphalt Pavement	Area 2 (Playground south of Building E)	2	5,000 SF	CA
-11	Area 2, North					
-12	Area 2, NE					
-13	Area 2, SW					
-14	Area 2, SE	↓		↓		↓

Prefix: 2204150044RK

Notes:

Released By, Date, & Time: Jim King 04/15/2022 11:05PM

Received By, Date, & Time: JEK 4-18-22 @ 8:00

Released By, Date, & Time: _____



Please Reply To:

AmeriSci Los Angeles

24416 S. Main Street, Ste 308

Carson, California 90745

TEL: (310) 834-4868 • FAX: (310) 834-4772

Cresson ES

LABORATORY ELECTRONIC TRANSMITTAL

To: Yesenia Galeana
Executive Environmental Services Corporatio

From: Dennis Liu

Fax #:

AmeriSci Job #: 922041374

Subject: PLM 5 day Results

Client Project: 22-Z0187-0045; Campus

Email: info@execenv.com, ygaleana@execenv.com

Date: Tuesday, April 26, 2022

Time: 11:15:22

Comments:

Number of Pages: _____
(including cover sheet)

NOTE: Attached report is to be considered preliminary until final review with accompanying analysis summary letter is issued.

CONFIDENTIALITY NOTICE: Unless otherwise indicated, the information contained in this communication is confidential information intended for use of the individual named above. If the reader of this communication is not the intended recipient, you are hereby notified that any dissemination, distribution or copying of this communication is prohibited. If you have received this communication in error, please immediately notify the sender by telephone and return the original message to the above address via the US Postal Service at our expense. Samples are disposed of in 60 days or unless otherwise instructed by the protocol or special instructions in writing. Thank you.

Certified Analysis Service 24 Hours A Day • 7 Days A Week Competitive Prices
visit our web site - www.amerisci.com

Boston • Los Angeles • New York • Richmond



AmeriSci Los Angeles

24416 S. Main Street, Ste 308
Carson, California 90745
TEL: (310) 834-4868 • FAX: (310) 834-4772

PLM Bulk Asbestos Report

Executive Environmental Services Corpor	Date Received 04/18/22	AmeriSci Job # 922041374
Attn: Yesenia Galeana	Date Examined 04/25/22	P.O. #
310 East Foothill Blvd.		Page 1 of 6
Suite 200	RE: 22-Z0187-0045; Campus	
Arcadia, CA 91006		

Client No. / HGA	Lab No.	Asbestos Present	Total % Asbestos
2204180045RK-01 Location: Area 1, West / Asphalt Paving / Area 1 (Building B Playground)	922041374-01	No	NAD (by CVES) by Dennis Liu on 04/25/22
Analyst Description: Black, Heterogeneous, Non-Fibrous, Asphalt Asbestos Types: Other Material: Non-fibrous 100%			
2204180045RK-02 Location: Area 1, North / Asphalt Paving	922041374-02	No	NAD (by CVES) by Dennis Liu on 04/25/22
Analyst Description: Black, Heterogeneous, Non-Fibrous, Asphalt Asbestos Types: Other Material: Non-fibrous 100%			
2204180045RK-03 Location: Area 1, Near Center / Asphalt Paving	922041374-03	No	NAD (by CVES) by Dennis Liu on 04/25/22
Analyst Description: Black, Heterogeneous, Non-Fibrous, Asphalt Asbestos Types: Other Material: Non-fibrous 100%			
2204180045RK-04 Location: Area 1, SW / Asphalt Paving	922041374-04	No	NAD (by CVES) by Dennis Liu on 04/25/22
Analyst Description: Black, Heterogeneous, Non-Fibrous, Asphalt Asbestos Types: Other Material: Non-fibrous 100%			
2204180045RK-05 Location: Area 1, SE / Asphalt Paving	922041374-05	No	NAD (by CVES) by Dennis Liu on 04/25/22
Analyst Description: Black, Heterogeneous, Non-Fibrous, Asphalt Asbestos Types: Other Material: Non-fibrous 100%			

Client Name: Executive Environmental Services Corporation

PLM Bulk Asbestos Report

22-Z0187-0045; Campus

Client No. / HGA	Lab No.	Asbestos Present	Total % Asbestos
2204180045RK-06	922041374-06	No	NAD
Location: Area 2, NE At Walkway / Asphalt Paving / Area 2 (SE Playground And Associated Walkways + Driveways)			(by CVES) by Dennis Liu on 04/25/22
Analyst Description: Black, Heterogeneous, Non-Fibrous, Asphalt			
Asbestos Types:			
Other Material: Non-fibrous 100%			
2204180045RK-07	922041374-07	No	NAD
Location: Area 2, NE At Playground / Asphalt Paving			(by CVES) by Dennis Liu on 04/25/22
Analyst Description: Black, Heterogeneous, Non-Fibrous, Asphalt			
Asbestos Types:			
Other Material: Non-fibrous 100%			
2204180045RK-08	922041374-08	No	NAD
Location: Area 2, East Driveway / Asphalt Paving			(by CVES) by Dennis Liu on 04/25/22
Analyst Description: Black, Heterogeneous, Non-Fibrous, Asphalt			
Asbestos Types:			
Other Material: Non-fibrous 100%			
2204180045RK-09	922041374-09	No	NAD
Location: Area 2, SE At Playground / Asphalt Paving			(by CVES) by Dennis Liu on 04/25/22
Analyst Description: Black, Heterogeneous, Non-Fibrous, Asphalt			
Asbestos Types:			
Other Material: Non-fibrous 100%			
2204180045RK-10	922041374-10	No	NAD
Location: Area 2, SW At Playground / Asphalt Paving			(by CVES) by Dennis Liu on 04/25/22
Analyst Description: Black, Heterogeneous, Non-Fibrous, Asphalt			
Asbestos Types:			
Other Material: Non-fibrous 100%			
2204180045RK-11	922041374-11	No	NAD
Location: Area 2, Near Playground Center / Asphalt Paving			(by CVES) by Dennis Liu on 04/25/22
Analyst Description: Black, Heterogeneous, Non-Fibrous, Asphalt			
Asbestos Types:			
Other Material: Non-fibrous 100%			

Client Name: Executive Environmental Services Corporation

PLM Bulk Asbestos Report

22-Z0187-0045; Campus

Client No. / HGA	Lab No.	Asbestos Present	Total % Asbestos
2204180045RK-12 Location: Area 2, West At Playground / Asphalt Paving	922041374-12	No	NAD (by CVES) by Dennis Liu on 04/25/22
Analyst Description: Black, Heterogeneous, Non-Fibrous, Asphalt Asbestos Types: Other Material: Non-fibrous 100%			
2204180045RK-13 Location: Area 2, NW At Playground / Asphalt Paving	922041374-13	No	NAD (by CVES) by Dennis Liu on 04/25/22
Analyst Description: Black, Heterogeneous, Non-Fibrous, Asphalt Asbestos Types: Other Material: Non-fibrous 100%			
2204180045RK-14 Location: Area 2, NW Walkway / Asphalt Paving	922041374-14	No	NAD (by CVES) by Dennis Liu on 04/25/22
Analyst Description: Black, Heterogeneous, Non-Fibrous, Asphalt Asbestos Types: Other Material: Non-fibrous 100%			
2204180045RK-15 Location: Area 3, NW At Playground / Asphalt Paving / Area 3 (SW Playground And Associated Walkways)	922041374-15	No	NAD (by CVES) by Dennis Liu on 04/25/22
Analyst Description: Black, Heterogeneous, Non-Fibrous, Asphalt Asbestos Types: Other Material: Non-fibrous 100%			
2204180045RK-16 Location: Area 3, North At Playground / Asphalt Paving	922041374-16	No	NAD (by CVES) by Dennis Liu on 04/25/22
Analyst Description: Black, Heterogeneous, Non-Fibrous, Asphalt Asbestos Types: Other Material: Non-fibrous 100%			
2204180045RK-17 Location: Area 3, NE Walkway / Asphalt Paving	922041374-17	No	NAD (by CVES) by Dennis Liu on 04/25/22
Analyst Description: Black, Heterogeneous, Non-Fibrous, Asphalt Asbestos Types: Other Material: Non-fibrous 100%			

PLM Bulk Asbestos Report

22-Z0187-0045; Campus

Client No. / HGA	Lab No.	Asbestos Present	Total % Asbestos
2204180045RK-18 Location: Area 3, East At Playground / Asphalt Paving	922041374-18	No	NAD (by CVES) by Dennis Liu on 04/25/22
Analyst Description: Black, Heterogeneous, Non-Fibrous, Asphalt Asbestos Types: Other Material: Non-fibrous 100%			
2204180045RK-19 Location: Area 3, SE At Playground / Asphalt Paving	922041374-19	No	NAD (by CVES) by Dennis Liu on 04/25/22
Analyst Description: Black, Heterogeneous, Non-Fibrous, Asphalt Asbestos Types: Other Material: Non-fibrous 100%			
2204180045RK-20 Location: Area 3, Near Center Of Playground / Asphalt Paving	922041374-20	No	NAD (by CVES) by Dennis Liu on 04/25/22
Analyst Description: Black, Heterogeneous, Non-Fibrous, Asphalt Asbestos Types: Other Material: Non-fibrous 100%			
2204180045RK-21 Location: Area 3, SW At Playground / Asphalt Paving	922041374-21	No	NAD (by CVES) by Dennis Liu on 04/25/22
Analyst Description: Black, Heterogeneous, Non-Fibrous, Asphalt Asbestos Types: Other Material: Non-fibrous 100%			
2204180045RK-22 Location: Area 4, NW / Asphalt Paving / Area 4 (Parking Lot West Of MPR Building)	922041374-22	No	NAD (by CVES) by Dennis Liu on 04/25/22
Analyst Description: Black, Heterogeneous, Non-Fibrous, Asphalt Asbestos Types: Other Material: Non-fibrous 100%			
2204180045RK-23 Location: Area 4, North / Asphalt Paving	922041374-23	No	NAD (by CVES) by Dennis Liu on 04/25/22
Analyst Description: Black, Heterogeneous, Non-Fibrous, Asphalt Asbestos Types: Other Material: Non-fibrous 100%			

Client Name: Executive Environmental Services Corporation

PLM Bulk Asbestos Report

22-Z0187-0045; Campus

Client No. / HGA	Lab No.	Asbestos Present	Total % Asbestos
2204180045RK-24 Location: Area 4, NE / Asphalt Paving	922041374-24	No	NAD (by CVES) by Dennis Liu on 04/25/22
Analyst Description: Black, Heterogeneous, Non-Fibrous, Asphalt Asbestos Types: Other Material: Non-fibrous 100%			
2204180045RK-25 Location: Area 4, SE / Asphalt Paving	922041374-25	No	NAD (by CVES) by Dennis Liu on 04/25/22
Analyst Description: Black, Heterogeneous, Non-Fibrous, Asphalt Asbestos Types: Other Material: Non-fibrous 100%			
2204180045RK-26 Location: Area 4, SW / Asphalt Paving	922041374-26	No	NAD (by CVES) by Dennis Liu on 04/25/22
Analyst Description: Black, Heterogeneous, Non-Fibrous, Asphalt Asbestos Types: Other Material: Non-fibrous 100%			
2204180045RK-27 Location: Area 5, SW / Asphalt Paving / Area 5 (NW Parking Lot)	922041374-27	No	NAD (by CVES) by Dennis Liu on 04/25/22
Analyst Description: Black, Heterogeneous, Non-Fibrous, Asphalt Asbestos Types: Other Material: Non-fibrous 100%			
2204180045RK-28 Location: Area 5, North / Asphalt Paving	922041374-28	No	NAD (by CVES) by Dennis Liu on 04/25/22
Analyst Description: Black, Heterogeneous, Non-Fibrous, Asphalt Asbestos Types: Other Material: Non-fibrous 100%			
2204180045RK-29 Location: Area 5, Near Center / Asphalt Paving	922041374-29	No	NAD (by CVES) by Dennis Liu on 04/25/22
Analyst Description: Black, Heterogeneous, Non-Fibrous, Asphalt Asbestos Types: Other Material: Non-fibrous 100%			

PLM Bulk Asbestos Report

22-Z0187-0045; Campus

Client No. / HGA	Lab No.	Asbestos Present	Total % Asbestos
2204180045RK-30 Location: Area 5, South / Asphalt Paving	922041374-30	No	NAD (by CVES) by Dennis Liu on 04/25/22
Analyst Description: Black, Heterogeneous, Non-Fibrous, Asphalt Asbestos Types: Other Material: Non-fibrous 100%			
2204180045RK-31 Location: Area 5, NE / Asphalt Paving	922041374-31	No	NAD (by CVES) by Dennis Liu on 04/25/22
Analyst Description: Black, Heterogeneous, Non-Fibrous, Asphalt Asbestos Types: Other Material: Non-fibrous 100%			

Reporting Notes:

Analyzed by: Dennis Liu
Date: 4/25/2022



Reviewed by: Laurie A. Noble



*NAD = no asbestos detected; Detection Limit <1%; Reporting Limits: CVES = 1%, 400 Pt Ct = 0.25%, 1000 Pt Ct = 0.1%; NA = not analyzed; NA/PS = not analyzed / positive stop; NVA = No Visible Asbestos; PLM (polarized light microscopy) Bulk Asbestos Analysis by EPA 600/R-93/116, including requirements for EPA 600/M4-82-020 per 40 CFR 763 (NVLAP Lab #200346-0); Note: PLM is not consistently reliable in detecting asbestos in floor coverings and similar NOB materials. TEM is currently the only method that can be used to determine if this material can be considered or treated as non-asbestos-containing in New York State (also see EPA Advisory for floor tile, FR 59, 146, 38970, 8/1/94). NIST Accreditation requirements mandate that this report must not be reproduced except in full with the approval of the laboratory. This PLM report relates ONLY to the items tested.



Industrial Hygiene Laboratory Submittal Asbestos -- PLM

922041374

Originating Office
 310 E. Foothill Blvd., Suite 200
 Arcadia, CA 91006
 Phone: 626.441.7050
 Fax: 626.441.0016

Lab Submitted to:
 AmeriSci
 EMLab (Glendale)
 LA Testing

Project #: 22-Z0187-0045
Sampled by: Rhys Kuzmic

Sample Date: 04/18/2022
Site Zip Code: 90650
Page 1 of 5

Routine (5 Days)
 RUSH (surcharges may apply)
 Circle 6 hours 24 hours 48 hours 3 to 5 days

The receiving Laboratory is required to complete the following:

- All invoices are to be sent to: 310 E. Foothill Blvd., Suite 200, Arcadia, CA 91006 with a copy of the lab report.
- Analyze all samples by PLM by EPA 600/R-93/116.
- Stop analysis of homogeneous groups at first positive that is greater than or equal to 1.0%

Optional items to be completed by the laboratory (if check marked): Email Report to: Info@execenv.com Other: ygaleana@execenv.com;
 US Mail Report to: Originating office check marked above Other:
 Alternate billing address:

Sample No.:	Sample Location - Include Room information where appropriate	Material Description	Homogeneous Location	No.	Quantity	Percent Damaged
-01	Area 2, West	Asphalt pavings	Area 1 (Building B playground)	1	8,000 SF	< 1
-02	Area 2, North					
-03	Area 2, Near Center					
-04	Area 2, SW					
-05	Area 2, SE					

Prefix: 2204180045RK

Notes:

Released By, Date, & Time: Rhys 04/18/2022 2:20PM
 Received By, Date, & Time: RJK 4-18-22 14:20
 Released By, Date, & Time:

922041374

Originating Office
 310 E. Foothill Blvd., Suite 200
 Arcadia, CA 91006
 Phone: 626.441.7050
 Fax: 626.441.0016

Lab Submitted to:
 AmeriSci
 EMLab (Glendale)
 LA Testing

Project #:
22-Z0187-0045

Sampled by:
Rhys Kuzmick

Sample Date:
04/18/2022

Site Zip Code:
90650

Building Name: Camp 45

Industrial Hygiene Laboratory Submittal
Asbestos -- PLM

EXECUTIVE ENVIRONMENTAL
 HEALTH & SAFETY SIMPLIFIED

Routine (5 Days)
 RUSH (surcharges may apply)
 Circle 6 24 48 3 to 5
 One hours hours days

The receiving Laboratory is required to complete the following:

- All invoices are to be sent to: 310 E. Foothill Blvd., Suite 200, Arcadia, CA 91006 with a copy of the lab report.
- Analyze all samples by PLM by EPA 600/R-93/116.
- Stop analysis of homogeneous groups at first positive that is greater than or equal to 1.0%

Optional items to be completed by the laboratory (if check marked): Email Report to: info@execenv.com Other: ygalearna@execenv.com;
 US Mail Report to: Originating office check marked above Other: Alternate billing address:

Sample No.:	Sample Location - Include Room information where appropriate	Material Description	Homogeneous Location	No.	Quantity	Percent Damaged
-06	Area 2, NE at walkway	Asphalt paving	Area 2 - CSE playground and associated walkways & driveway	2	25,000 SF	<1
-07	Area 2, NE at playground					
-08	Area 2, east driveway					
-09	Area 2, SE at playground					
-10	Area 2, SW at playground					
-11	Area 2, near playground center					
-12	Area 2, west at playground					

Prefix: 2204180045RK

Notes:

Received By, Date, & Time: [Signature] 04/18/2022 2:20PM

Released By, Date, & Time: [Signature] 4.18.2022 14:20

Received By, Date, & Time: [Signature] 4.18.2022 14:20

Released By, Date, & Time: [Signature] 4.18.2022 14:20

Rev. 1/19 ©Copyright 2019 All Rights Reserved Form: AL-006PLM

922041374



**Industrial Hygiene Laboratory Submittal
Asbestos -- PLM**

Originating Office
 310 E. Foothill Blvd., Suite 200
 Arcadia, CA 91006
 Phone: 626.441.7050
 Fax: 626.441.0016

Lab Submitted to:
 AmeriSci
 EMLab (Glendale)
 LA Testing

Project #: 22-Z0187-0045
Sampled by: Rhys Kuzmic
Sample Date: 04/18/2022
Site Zip Code: 90650
Page 3 of 5

The receiving Laboratory is required to complete the following:

- All invoices to be sent to: 310 E. Foothill Blvd., Suite 200, Arcadia, CA 91006 with a copy of the lab report.
- Analyze all samples by PLM by EPA 600/R-93/116.
- Stop analysis of homogeneous groups at first positive that is greater than or equal to 1.0%

Optional Items to be completed by the laboratory (if check marked): Email Report to: Info@execenv.com Other: ygaleana@execenv.com;
 US Mail Report to: Originating office check marked above Other:
 Alternate billing address:

Sample No.:	Sample Location - Include Room information where appropriate	Material Description	Homogeneous Location	No.	Quantity	Percent Damaged
-13	Area 2, NW at playground	Asphalt Pavms (continued)		↓	↓	↓
-14	Area 2, NW walkway	↓		↓	↓	↓
-15	Area 3, NW at playground	Asphalt Pavms	Area 3 CSW playground and associated walkways	3	11,000 SF	< 1
-16	Area 3, north at playground					
-17	Area 3, NE walkway					
-18	Area 3, east at playground					
-19	Area 3, SE at playground					

Prefix: 2204180045RK

Notes:

Released By, Date: Ryan 04/18/2022 2:28 PM
 Received By, Date: Rhys 4.18.22 14:20
 Released By, Date, & Time: [Blank]
 Received By, Date, & Time: [Blank]

922071374



Industrial Hygiene Laboratory Submittal Asbestos -- PLM

Originating Office
 310 E. Foothill Blvd., Suite 200
 Arcadia, CA 91006
 Phone: 626.441.7050
 Fax: 626.441.0016

Lab Submitted to:
 AmeriSci
 EMLab (Glendale)
 LA Testing

Routine (5 Days) Working
 RUSH (surcharges may apply)
 Circle 6 24 48 hours hours hours days
 3 to 5 days

Project #: 22-Z0187-0045
Sampled by: Rhys Kuzmic

Site Zip Code: 90650
Sample Date: 04/18/2022
 Page 4 of 5

Building Name: Campb/s

The receiving Laboratory is required to complete the following:

- All invoices are to be sent to: 310 E. Foothill Blvd., Suite 200, Arcadia, CA 91006 with a copy of the lab report.
- Analyze all samples by PLM by EPA 600/R-93/116.
- Stop analysis of homogeneous groups at first positive that is greater than or equal to 1.0%

Optional items to be completed by the laboratory (if check marked): Email Report to: Info@execenv.com Other: ygalearna@execenv.com;
 US Mail Report to: Originating office check marked above Other:
 Alternate billing address:

Sample No.:	Sample Location - Include Room information where appropriate	Material Description	Homogeneous Location	No.	Quantity	Percent Damaged
-20	Area 3, near center of playground	Asphalt paving (continued)				
-21	Area 3, SW at playground	↓		↓	↓	↓
-22	Area 4, NW	Asphalt paving	Area 4 (Paving lot west of MPR Building)	4	9,000 SF	< 1
-23	Area 4, North					
-24	Area 4, NE					
-25	Area 4, SE					
-26	Area 4, SW					

Prefix: 2204180045RK

Notes:

Received By, Date: [Signature] 04/18/2022 2:20PM
 Released By, Date: [Signature] 4/18/2022 14:20
 Received & Time: [Signature] 4/18/2022 14:20
 Released By, Date: [Signature] 4/18/2022 14:20

22041374



Industrial Hygiene Laboratory Submittal Asbestos -- PLM

Originating Office
 310 E. Foothill Blvd., Suite 200
 Arcadia, CA 91006
 Phone: 626.441.7050
 Fax: 626.441.0016

Lab Submitted to:
 AmeriSci
 EMLab (Glendale)
 LA Testing

Routine (5 Days)
 RUSH (surcharges may apply)
 Circle 6 24 48 3 to 5
 One hours hours hours days

Project #:
 22-Z0187-0045

Sampled by:
 Rhys Kuzmic

Site Zip Code:
 90650

Sample Date:
 04/18/2022

The receiving Laboratory is required to complete the following:

- All invoices are to be sent to: 310 E. Foothill Blvd., Suite 200, Arcadia, CA 91006 with a copy of the lab report.
- Analyze all samples by PLM by EPA 600/R-93/116.
- Stop analysis of homogeneous groups at first positive that is greater than or equal to 1.0%

Building Name: Campyus

Optional items to be completed by the laboratory (if check marked): Email Report to: Info@execenv.com Other: ygalearna@execenv.com;
 US Mail Report to: Originating office check marked above Other: Alternate billing address:

Sample No.:	Sample Location - Include Room information where appropriate	Material Description	Homogeneous Location	No.	Quantity	Percent Damaged
-27	Area 5, SW	Asphalt paving	Area 5 (NW Parking Lot)	5	9,300 SF	CA
-28	Area 5, north					
-29	Area 5, near center					
-30	Area 5, south					
-31	Area 5, NE					

Prefix: 2204180045RK

Notes:
 Released By, Date, & Time:
 Received By, Date, & Time:

Rhys KA 04/18/2022 2:20PM

Rhys KA 4.18.2024:20

LITTLE LAKE CITY SCHOOL DISTRICT - MISCELLANEOUS HARDSCAPE IMPROVMENTS AT MULTIPLE SITES

WORK SCOPE SPECIAL CONDITIONS

CONTRACTOR CATEGORY NUMBER		
ITEM:	DESCRIPTION:	2
1	LMCCI has implemented Trimble Project Sight as the mandatory project documentation and processing program. Each awarded Category Contractor will be required to sign up for the free account in order to use the program to view documents through links forwarded by LMCCI, input Dailies, RFI's, etc. The program is free of charge and required for use on this project. Upon award of the contract an email will be sent to appropriate company contacts with a link to follow to join and create your account.	yes
2	Category Contractor shall not interfere with the normal, regular, or existing school hours and or school activities.	yes
3	Provide all project submittals no later than ten (10) calendar days after receipt of Notice of Award regardless of what any other particular specification may otherwise indicate. Category Contractor will need to provide at minimum (1) electronic PDF copy of each submittal submitted	
4	This Category Contractor shall provide and install a 6' high temporary fence on stands with green wind screen around the areas receiving site work prior to the start of construction. Continuously maintain temporary fencing for the duration of the project along with removal of fencing as directed by the Construction Manager. All costs associated with the installation, maintenance, monthly rental and removals (whether it be partial removals or entire removals) shall be included within your base bid.	yes
5	Properly protect existing improvements scheduled to remain when performing work within this category.	yes
6	Properly & completely coordinate all work through the Construction Manager to ensure that all work is properly and efficiently installed per the construction documents.	yes
7	All daily reports shall be turned into the Construction Manager on a daily basis.	yes
8	All deliveries, materials or equipment being moved between construction areas/sites, shall be coordinated and approved by the Construction Manager prior to commencement.	yes
9	Category Contractor shall include all site visits as requested by the Construction Manager with the purpose of coordinating.	yes
10	Utilize suitable equipment for traversing the site, hauling or relocating of materials, and/or erection of items within this trade regardless of soils conditions or grades at no additional cost or delay to the	yes
11	This Category Contractor shall be responsible for export of any spoils produced within their work scope. This shall include all labor, machinery, equipment, trucking, fees and clean up. This shall be in this Category Contractors base bid.	yes

LITTLE LAKE CITY SCHOOL DISTRICT - MISCELLANEOUS HARDSCAPE IMPROVMENTS AT MULTIPLE SITES

WORK SCOPE SPECIAL CONDITIONS

CONTRACTOR CATEGORY NUMBER		
ITEM:	DESCRIPTION:	2
12	This Category Contractor shall be responsible for export and proper disposal of any asphalt with felt within the demolition lines of the Contract Documents. This shall include ALL demo, export, machinery, labors and any fees associated with disposal.	yes
13	This Category Contractor shall be responsible for demolition of existing plywood on both sides of the existing ball wall. Procurement and Installation of new 3/4" ACX PT Plywood (12 sheets total), associated accessories, one coat of primer and two coats of finish paint (color TBD) for both sides of the ball wall shall be included within this Category Contractors base bid. This shall apply at Cresson ES, Paddison ES, Studebaker ES, William Orr ES and Lakeland ES.	yes
14	This Category Contractor shall be responsible for new parking lot and pavement markings/stripping to match existing.	yes
15	This Category Contractor shall be responsible for careful removal and re-installation of any existing vehicle signage at all site locations. All cost for labor, equipment and material needed for removal and re-installation shall be a part of this category Contractors base bid.	yes
16	Contractors within this category shall pay and maintain cell phone numbers for their project foreman throughout the duration of this project.	yes
17	Provide all job verification and field measuring as needed and/or required to ensure that the work is coordinated and properly installed.	yes
18	Repair any and all finishes damaged as a result of the execution of the work in this Contractor	yes
19	Provide daily site clean up to insure a clean, safe & accessible work environment. This applies to all sites within the project documents.	yes
20	Contractor to provide a minimum of two (2) 55 gallon trash cans with liners to properly dispose of waste, trash, lunch trash and debris. This shall also include procurement of all hauling permits and/or dump fees which may be required daily. This applies equally to any/all subcontractors employed by the Prime Contractor daily.	yes
21	Category Contractor shall provide protection/prevention of wind damage to incomplete work or on-site stored materials.	yes
22	The protection against and prevention of heat damage to incomplete work or on-site stored materials is the responsibility of this Category Contractor	yes

LITTLE LAKE CITY SCHOOL DISTRICT - MISCELLANEOUS HARDSCAPE IMPROVMENTS AT MULTIPLE SITES

WORK SCOPE SPECIAL CONDITIONS

CONTRACTOR CATEGORY NUMBER		
ITEM:	DESCRIPTION:	2
23	Work scheduled shall consist of a (6) day (48) hour work week during the Summer 2022 and District holiday weekends. Construction work hours shall be between the hours of 7:00 AM and 4:00 PM (no access will be allowed on site before or after work hours) and shall constitute as a work day at the applicable prevailing wage rate(s). All weekends, holidays or irregular hours worked must be supervised by the Construction Manager and be in compliance with local ordinances. This Category Contractor shall be responsible for any costs incurred for District's supervision, repairs, tests and inspections (if required) if This Category Contractor's actions cause damages requiring District's remediation. The District nor the Construction Manager will be held responsible for these violations.	yes
24	This Category Contractor shall demo, prep and patch Asphalt/Concrete as shown within the Construction Documents and per Industry Standards.	yes
25	At no time will any contractor or sub contractor's drive or park on any concrete flatwork without the consent of the Construction Manager. It will be the contractor's responsibility to keep his employees, subcontractors, suppliers and company vehicles off said concrete. Any damages, tire marks or cracking found at anytime after the violation of this rule, will be full responsibility of this Category Contractor.	yes
26	Parking areas shall be designated by the Construction Manager.	yes
27	The Construction Manager will review and approve the placement of all temporary storage containers, trailers and stored materials.	yes
28	It shall be established that any materials delivered "Freight on Board" (FOB) shall be unloaded by the Category Contractor that is receiving these items, any discrepancy in quantities or any damage to any items must be acknowledged at the time of delivery. Any discrepancy in quantity or damage that goes unreported shall be the responsibility of the receiving Category Contractor to replace and/or repair.	yes
29	Provide all barricades, warning lights and signs & safety measures etc. required for the execution of the work within this Category. Provide all parking lot closures 48 hours in advanced to the Construction Manager.	yes
30	Provide adequate and proper fugitive dust control during all operations within this contract as required be applicable codes and/or ordinances. Comply with the South Coast Air Quality Management District (SCAQMD) for the Santa Fe Springs Western Region area. This includes but is not limited to	yes

LITTLE LAKE CITY SCHOOL DISTRICT - MISCELLANEOUS HARDSCAPE IMPROVMENTS AT MULTIPLE SITES

WORK SCOPE SPECIAL CONDITIONS

CONTRACTOR CATEGORY NUMBER		
ITEM:	DESCRIPTION:	2
31	All Contractors shall be familiar and comply with the South Coast Air Quality Management District (SCAQMD) standards for the Santa Fe Springs Western Region for the duration of the project.	yes
32	ALL references to "Architect" throughout the Project Manual and or Construction Documents shall be replaced with "Construction Manager".	yes
33	Provide all demo of the existing assemblies indicated to be demolished as per the Construction	yes
34	Provide and maintain all temporary chemical toilets and temporary had wash stations for the duration of the project. A minimum of 2 toilets and 1 hand wash station for each of the sites shall be provided and may be adjusted based upon the quantity of manpower present on the jobsite and or as directed by the Construction Manager. Provide twice a week cleaning. Coordinate locations of temp toilets and hand wash stations with the Construction Manager.	yes
35	This Contractor shall verify and keep all existing systems fully operational as they execute the scope of work within this contract.	yes
36	This Category Contactor, when pouring concrete, shall be responsible for the protection of all Building walls, finishes, finish products, grates, manholes and cleanout covers. Any concrete or residue from protective tape shall be completely removed by this Category Contractor.	yes
37	This Category Contractor shall repair any adjacent grades and/or finishes damaged as a result of the execution of this Category Contractor scope of work.	yes
38	Provide all Best Management Practices (BMP's) as required to meet all requirements for the Regional Storm Water Pollution Prevention and local governing jurisdiction, included but not limited to concrete wash out containers, drain inlet protection, erosion control, etc.	yes
39	Saw cut existing concrete & paving to provide a smooth edge for patching and/or adjoining new work to existing improvements as required for work to be performed by this Category Contractor.	yes
40	Protect all existing wheel stops, traffic, direction signage, truncated domes etc. that impedes any of this new work within the project documents.	yes
41	This Category Contractor is the project General Contractor and shall be solely responsible for ALL work as required for the complete project as specified within the Drawings, Specifications and Addenda's.	yes

LITTLE LAKE CITY SCHOOL DISTRICT - MISCELLANEOUS HARDSCAPE IMPROVMENTS AT MULTIPLE SITES

WORK SCOPE SPECIAL CONDITIONS

CONTRACTOR CATEGORY NUMBER		
ITEM:	DESCRIPTION:	2
42	If required, carefully remove and reinstall any chain link, ornamental iron and/or temporary fencing encountered while installing work and/or obtaining access to the work area in this category to the satisfaction of the Construction Manager. Fencing shall be repaired, relocated, and replaced on a daily basis to ensure continual site security and safety.	yes
42	It shall be this Category Contractors responsibility to fully fill 1000' lineal feet of asphalt/paving cracks with specified crack filler as denoted on the drawings and as per the specification guidelines.	yes
43	It shall be the responsibility of this Category Contractor to apply seal coat onto all new asphalt paving as per the drawings, specifications and related Construction Documents.	yes
44	It shall be responsibility of this Category Contractor to provide 750' sqft (at multiple locations) of Asphalt demo and patch back as directed by the Construction Manger. Legal disposal, permits and export transportation shall also be included within this Category Contractors base bid.	yes
45	It shall be this Category Contractor responsibility to provide demo and legal disposal of 500'sqft of additional asphalt and concrete at all six (6) sites. Also within this Category Contractors base bid shall be all labor and material/equipment necessary for pour back of 500'sqft of Asphalt/concrete as directed by the Construction Manager/District, for all six (6) sites.	yes
46	It shall be responsibility of this Category Contractor to grind any areas where new and existing work do not provide a smooth transition. All new and existing asphalt shall be pressure washed and thoroughly cleaned prior to striping and or sealing.	yes
47	Its shall be responsibility of this Category Contractor to fully procure and install wire mesh reinforcement at new concrete locations. Epoxy dowls shall be installed at concrete areas where new work impinges against existing and or as needed to satisfy codes.	yes
48	It shall be responsibility of this Category Contractor to be sure that all sub grades prior to pours meet or exceed he noted 95% compaction UNO within the project documents.	yes

Activity ID	Activity Name	Start	Finish	Original Duration	2022											
					Jan	Feb	Mar	May	Jun	Jul	Aug	Sep	Oct	Nov		
Miscellaneous Hardscape Improvements at Multiple Sites																
General Project Information																
GP-00-00	Bids Due & Opened (5.5.22)	05-May-22*	05-May-22	1												
GP-00-01	Board Approval (5.24.22)	24-May-22*	24-May-22	1												
GP-00-02	Notice of Award (5.25.22)	25-May-22*	25-May-22	1												
GP-00-03	Notice to Proceed (6.1.22)	01-Jun-22*	01-Jun-22	1												
GP-00-04	Construction Start (6.10.22)	10-Jun-22*	10-Jun-22	1												
Material Procurement																
MP-00-00	Produce & Approve Submittals	26-May-22	08-Jun-22	10												
MP-00-1	Place Orders	09-Jun-22	07-Jul-22	20												
MP-00-2	Product On Site	08-Jul-22	08-Jul-22	1												
Construction																
Jersey Avenue Elementary School																
JAES-00-01	Mobilize & Temp Services	13-Jun-22	13-Jun-22	1												
JAES-00-02	Layout & Sawcut Area of Work	14-Jun-22	16-Jun-22	3												
JAES-00-03	Demolition	17-Jun-22	30-Jun-22	10												
JAES-00-04	Rough & Fine Grading	01-Jul-22	08-Jul-22	5												
JAES-00-05	Set Up, Form & Pour Concrete	11-Jul-22	15-Jul-22	5												
JAES-00-06	Asphalt 1st & 2nd Lifts	18-Jul-22	22-Jul-22	5												
JAES-00-07	Vehicle Signage	25-Jul-22	25-Jul-22	1												
JAES-00-08	Slurry Coats	26-Jul-22	01-Aug-22	5												
JAES-00-09	Stripping	02-Aug-22	08-Aug-22	5												
JAES-00-10	Incomplete Work List/Punch List	09-Aug-22	11-Aug-22	3												
Paddison Elementary School																
JAES-00-11	Mobilize & Temp Services	14-Jun-22	14-Jun-22	1												
JAES-00-12	Layout & Sawcut Area of Work	15-Jun-22	17-Jun-22	3												
JAES-00-13	Demolition	20-Jun-22	24-Jun-22	5												
JAES-00-14	Rough & Fine Grading	27-Jun-22	01-Jul-22	5												
JAES-00-15	Set Up, Form & Pour Concrete	05-Jul-22	18-Jul-22	10												
JAES-00-16	Asphalt 1st & 2nd Lifts	19-Jul-22	25-Jul-22	5												
JAES-00-17	Vehicle Signage	26-Jul-22	26-Jul-22	1												
JAES-00-18	Slurry Coats	27-Jul-22	02-Aug-22	5												
JAES-00-19	Stripping	03-Aug-22	09-Aug-22	5												
JAES-00-20	Incomplete Work List/Punch List	10-Aug-22	12-Aug-22	3												
Studebaker Elementary School																
JAES-00-21	Mobilize & Temp Services	15-Jun-22	15-Jun-22	1												
JAES-00-22	Layout & Sawcut Area of Work	16-Jun-22	20-Jun-22	3												
JAES-00-23	Demolition	21-Jun-22	27-Jun-22	5												
JAES-00-24	Rough & Fine Grading	28-Jun-22	05-Jul-22	5												
JAES-00-25	Set Up, Form & Pour Concrete	06-Jul-22	19-Jul-22	10												
JAES-00-26	Asphalt 1st & 2nd Lifts	20-Jul-22	26-Jul-22	5												
JAES-00-27	Vehicle Signage	27-Jul-22	27-Jul-22	1												
JAES-00-28	Slurry Coats	28-Jul-22	03-Aug-22	5												
JAES-00-29	Stripping	04-Aug-22	10-Aug-22	5												
JAES-00-30	Incomplete Work List/Punch List	11-Aug-22	15-Aug-22	3												
Cresson Elementary School																
JAES-00-31	Mobilize & Temp Services	16-Jun-22	16-Jun-22	1												
JAES-00-32	Layout & Sawcut Area of Work	17-Jun-22	21-Jun-22	3												

Second Baseline
 Remaining Work
 Actual Work
 Critical Remaining Work
 Milestone

Miscellaneous Hardscape Improvements at Multiple Sites
Ledesma & Meyer Construction Co. Inc.
 Page 1 of 2

Construction Bid Schedule			
Date	Revision	Checked	Approved
	Addendum 1		

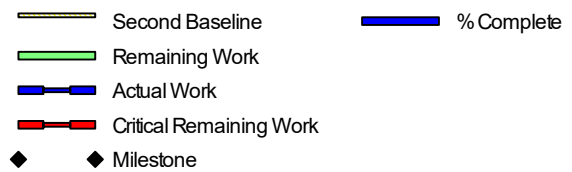
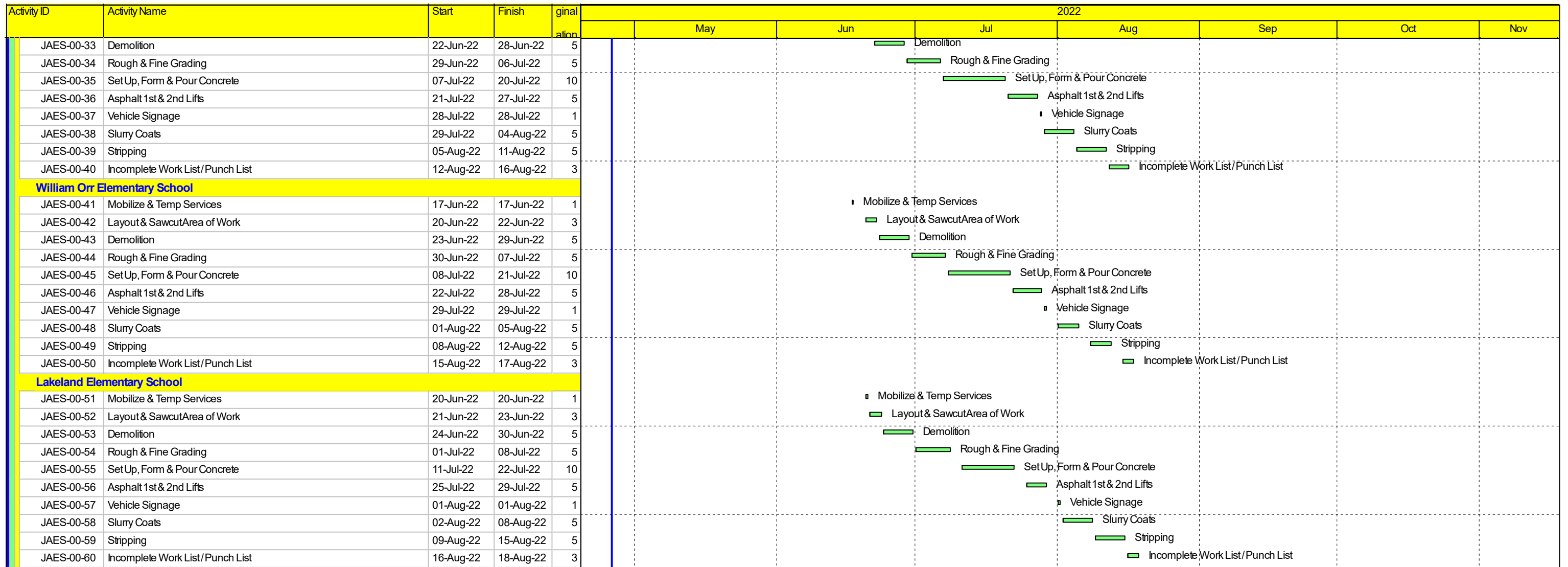

Miscellaneous Hardscape Improvements at Multiple Sites
Ledesma & Meyer Construction Co. Inc.
 Page 2 of 2

Construction Bid Schedule			
Date	Revision	Checked	Approved
	Addendum 1		

SECTION 32 11 23
AGGREGATE BASE COURSES

PART 1 GENERAL

1.01 SECTION INCLUDES

- A. Aggregate base course.
- B. Paving aggregates.
- C. Soil sterilization.

1.02 RELATED REQUIREMENTS

- ~~A. Section 31 22 00 - Grading: Preparation of site for base course.~~
- ~~B. Section 31 23 23 - Fill: Topsoil fill at areas adjacent to aggregate base course.~~
- ~~C. Section 31 23 23 - Fill: Compacted fill under base course.~~
- D. Section 32 12 16 - Asphalt Paving.**
- ~~E. Section 32 13 13 - Concrete Paving: Finish concrete surface course.~~
- ~~F. Section 32 17 13 - Parking Bumpers: Concrete bumpers.~~
- ~~G. Section 33 41 00 - Subdrainage: Filter aggregate and filter fabric for foundation drainage systems.~~

1.03 REFERENCE STANDARDS

- A. AASHTO T 180 - Standard Specification for Moisture-Density Relations of Soils Using a 4.54-kg (10-lb) Rammer and a 457-mm (18 in.) Drop; 2017.
- B. ASTM D698 - Standard Test Methods for Laboratory Compaction Characteristics of Soil Using Standard Effort (12,400 ft-lbf/ft³ (600 kN-m/m³)); 2012.
- C. ASTM D1556/D1556M - Standard Test Method for Density and Unit Weight of Soil in Place by the Sand-Cone Method; 2015.
- D. ASTM D1557 - Standard Test Methods for Laboratory Compaction Characteristics of Soil Using Modified Effort (56,000 ft-lbf/ft³ (2,700 kN m/m³)); 2012.
- E. ASTM D2487 - Standard Practice for Classification of Soils for Engineering Purposes (Unified Soil Classification System); 2011.
- F. ASTM D6938 - Standard Test Methods for In-Place Density and Water Content of Soil and Soil-Aggregate by Nuclear Methods (Shallow Depth); 2015.
- G. SSPWC - Greenbook: Standard Specifications for Public Works Construction; latest adopted edition.

1.04 SUBMITTALS

- A. See Section 01 30 00 - Administrative Requirements, for submittal procedures.
- B. Samples: 10 lb sample of each type of aggregate; submit in air-tight containers to testing laboratory.
- C. Materials Sources: Submit name of imported materials source.

- D. Certificates of Conformance: Aggregate and sterilant materials.
- E. Aggregate Composition Test Reports: Results of laboratory tests on proposed and actual materials used.
- F. Compaction Density Test Reports.

1.05 QUALITY ASSURANCE

- A. Regulatory Requirements: Where reference is made to Standard Specifications, the following shall apply.
 - 1. Perform off-site Work in public rights-of-way in accordance with requirements of authorities having jurisdiction, including SSPWC. For conditions not indicated otherwise on Contract Drawings, conform to Standard Details adopted by authorities having jurisdiction.
 - 2. Perform on-site Work as indicated and referenced on Contract Drawings and as specified herein.
- B. The quantity of volatile organic compounds (VOC) used in weed killer, tack coat, primer and other materials shall not exceed limits permitted under current regulations of:
 - 1. South Coast Air Quality Management District (AQMD).
- C. Source Quality Control: Obtain materials from one source throughout.

1.06 DELIVERY, STORAGE, AND HANDLING

- A. When necessary, store materials on site in advance of need.
- B. When aggregate materials need to be stored on site, locate where directed by District.
- C. Aggregate Storage, General:
 - 1. Separate differing materials with dividers or stockpile separately to prevent intermixing.
 - 2. Prevent contamination.
 - 3. Protect stockpiles from erosion and deterioration of materials.

PART 2 PRODUCTS

2.01 MATERIALS

- A. Sub-Base Material: Existing or imported materials as recommended in geotechnical report. Refer to Document 00 31 00 - Available Project Information.
- B. Aggregate Type Class II: Coarse or crushed aggregate, conforming to Municipality, SSPWC Section 200-2.2.
- C. Coarse Aggregate: Pit run washed stone; free of shale, clay, friable material and debris.
 - 1. Graded in accordance with ASTM D2487 Group Symbol GW.
- D. Herbicide: Comply with all applicable environmental protection and hazardous materials laws and regulations .
 - 1. Comply with current EPA acceptable standard and the California Department of Pesticide Regulations for soils sterilant.
 - 2. Sterilant: Selected as appropriate for the environment in which is it to be placed.

3. Contractor shall be licensed with the State of California to apply sterilant.
4. Sterilant: Commercial grade for commercial application.
5. Payment for soil sterilization: Include full compensation for application and all materials and incidental work required.
6. Application Rate: 7 lbs. per acre. If another manufacturer is used follow their recommendations.
7. Basis of Design Product: Spike 80DF as manufactured by Dow AgroSciences; www.dowagro.com, or approved equal.

2.02 SOURCE QUALITY CONTROL

- A. See Section 01 40 00 - Quality Requirements, for general requirements for testing and analysis of aggregate materials.
- B. Where aggregate materials are specified using ASTM D2487 classification, testing of samples for compliance shall be provided before delivery to site.
- C. If tests indicate materials do not meet specified requirements, change material and retest.
- D. Provide materials of each type from same source throughout the Work.

PART 3 EXECUTION

3.01 EXAMINATION

- A. Establishment of Grades
 1. Set grade stakes per Section 01 70 00 - Execution and Closeout Requirements.
 2. All work shall conform to the lines, elevations, and grades shown on the Drawings.
 - a. Use three consecutive points set on the same slope together so that any variation from a straight grade can be detected.
 - b. Report any such variation to the Architect. Contractor shall be responsible for any error in the grade of the finished work.
 3. Grade or location stakes lost or disturbed, shall be reset by the Surveyor at no additional expense to District.
 4. Areas having drainage gradients of 2 percent or more, provide elevation stakes, set with instrument, at grid intervals of 25 feet.
 - a. Intermediate stakes may be set by using a tightly-drawn string line over the tops of adjacent stakes.
 - b. Grade stakes must be set at all grade breaks, grade changes, etc.
 5. Areas having drainage gradients of less than 2 percent; provide elevation stakes, set with instrument, at 10 foot intervals.
 - a. Grade stakes must be set at all grade breaks, grade changes, etc.
- B. Verify that survey bench marks and intended elevations for the work are as indicated.
- C. Verify substrate has been inspected, gradients and elevations are correct, and is dry.

3.02 PREPARATION

- A. Stockpiling:
 - 1. Clear and level storage sites prior to stockpiling of material.
 - 2. Stockpile all materials, including approved material available from excavation and grading, in the manner and at the locations designated.
 - 3. Aggregates shall be stockpiled on the cleared and leveled areas designated by the Construction Manager to prevent segregation.
 - 4. Materials obtained from different sources shall be stockpiled separately.
- B. Soil Sterilant:
 - 1. Sterilize soil areas to receive paving.
 - 2. Apply soil sterilant in accordance with manufacturer's instructions and applicable environmental regulations.
 - 3. Take care to confine application to the areas to be paved. Sterilant shall not be applied within 2 feet of planting areas.
- C. Correct irregularities in substrate gradient and elevation by scarifying, reshaping, and re-compacting.
- D. Do not place aggregate on soft, muddy, or frozen surfaces.

3.03 INSTALLATION

- A. Place and compact aggregate base material in accordance with SSPWC, Subsection 301-2. Place aggregate base below curbs and gutters and paving also, compacted to 95 percent at vehicular traffic and 90 percent at pedestrian-only traffic.
- B. Application of Base Course:
 - 1. After preparing the subgrade, Avoid all vehicular or machine traffic on the subgrade.
 - a. Should it be necessary to haul over the prepared subgrade, drag and roll the traveled way as frequently as may be necessary to remove ruts, cuts, and breaks in the surface.
 - b. Rake and hand tamp all cuts, ruts, and breaks in the surface of the subgrade that are not removed by the above operations.
 - c. Equip with pneumatic tires all equipment used for transporting materials over the prepared subgrade.
 - 2. Do not permit continued use of sections of prepared subgrade for hauling, so as to cut up or deform it from the true cross-section. Protect the prepared subgrade from all traffic.
 - 3. Maintain the surface in its finished condition until the succeeding layer is placed.
- C. Under Bituminous Concrete Paving:
 - 1. It is required that areas of exterior asphalt pavement be underlain by a layer of aggregate base material which meets the requirements, Thickness of base layer is as shown on the Drawings and varies per the Usage Type area.

- a. It is required that the upper 12 inches of soils below asphalt pavement base material be over-excavated and consist predominantly of satisfactory soil materials and/or approved imported fill.
 - 1) Engineered Fill: See Section 31 23 23 - Fill.
- b. It is required that the exposed bottom surface soils, below overexcavation, be scarified to the recommended depth of 8 inches, moisture conditioned to achieve optimum moisture content, but not higher than 2 percent above optimum, and then re-compacted to a minimum 90 percent relative compaction before any fill materials are placed.
- 2. The above subgrade preparation recommendations are based on the assumption that soils encountered during field exploration are representative of soils throughout the site.
 - a. However, there can be unforeseen and unanticipated variations in soils between points of subsurface exploration. For this reason, the actual subgrade preparation will have to be determined on the basis of in-grading observations and testing performed by representatives of the project geotechnical consultant.
- 3. Provide grade stakes and elevations by a California Licensed Surveyor (LS) for the Geotechnical Engineer.
 - a. Verify that the over-excavation depths, shown on the construction drawings for asphalt concrete pavement structural sections, have been achieved prior to re-compaction.
- 4. Correct irregularities by dressing down or filling as may be required, to bring areas to true subgrade elevations.
- 5. Where filling is required, scarify the subgrade to bond the new material to the in place material; use additional material as required at no additional cost. Subject to the approval of the Architect.
- 6. Remove excess material from the site to a legal disposal area.
- D. Under Portland Cement Concrete Paving:
 - 1. Compact as indicated on Drawings up to 95 percent of maximum dry density and 90 percent at pedestrian-only traffic.
- E. Place aggregate in maximum 4 inch layers and roller compact to specified density.
- F. Level and contour surfaces to elevations and gradients indicated.
- G. Add small quantities of fine aggregate to coarse aggregate as appropriate to assist compaction.
- H. Add water to assist compaction. If excess water is apparent, remove aggregate and aerate to reduce moisture content.
- I. Use mechanical tamping equipment in areas inaccessible to compaction equipment.
- J. Apply herbicide to finished surface.

3.04 TOLERANCES

- A. Subgrade Tolerances:
 - 1. Subgrade for Pavement: Do not vary more than 0.02 ft..
 - 2. Subgrade for Subbase or Base Material: Do not vary more than 0.04 ft..

- 3. Variations within the above specified tolerances shall be compensating so that the average grade and cross section specified are met.
- B. Flatness: Maximum variation of 1/4 inch measured with 10 foot straight edge.
- C. Scheduled Compacted Thickness: Within 1/4 inch.
- D. Variation From Design Elevation: Within 1/2 inch.

3.05 FIELD QUALITY CONTROL

- A. See Section 01 40 00 - Quality Requirements, for general requirements for field inspection and testing.
- B. Compaction density testing shall be performed on compacted aggregate base course in accordance with ASTM D1556 or ASTM D6938.
- C. Results will be evaluated in relation to compaction curve determined by testing uncompacted material in accordance with AASHTO T 180, ASTM D698 ("standard Proctor"), or ASTM D1557 ("modified Proctor").
- D. If tests indicate work does not meet specified requirements, remove work, replace and retest.
- E. Proof roll compacted aggregate at surfaces that are under slabs-on-grade and paving.

3.06 CLEANING

- A. Remove unused stockpiled materials, leave area in a clean and neat condition. Grade stockpile area to prevent standing surface water.
- B. Leave borrow areas in a clean and neat condition. Grade to prevent standing surface water.

END OF SECTION

SECTION 32 12 16
ASPHALT PAVING

PART 1 GENERAL

1.01 SECTION INCLUDES

- A. Single course bituminous concrete paving.
- B. Double course bituminous concrete paving.
- C. Surface sealer.
- D. This section compliments and shall be coordinated with Civil Drawing specifications / requirements. The most stringent requirements shall be utilized.
- E. Asphaltic concrete paving for vehicular traffic and curbs, including necessary patching and repair of damaged new and existing paving.
- F. Patching and repair of existing asphaltic concrete paving for previous damage, for underground utility work and where damaged by new construction.

1.02 RELATED REQUIREMENTS

- ~~A. Section 31 22 00 - Grading: Preparation of site for paving and base.~~
- ~~B. Section 31 23 23 - Fill: Compacted subgrade for paving.~~
- C. Section 32 11 23 - Aggregate Base Courses: Aggregate base course.**
- ~~D. Section 32 13 13 - Concrete Paving: Concrete curbs.~~
- ~~E. Section 32 17 13 - Parking Bumpers: Concrete bumpers.~~
- F. Section 32 17 23.13 - Painted Pavement Markings: Concrete bumpers.**
 - 1. Parking and Traffic Control Pavement Markings.

1.03 REFERENCE STANDARDS

- A. AI MS-2 - Mix Design Methods for Asphalt Concrete and Other Hot-Mix Types; 2015.
- B. AI MS-19 - A Basic Asphalt Emulsion Manual; Fourth Edition.
- C. ASTM D946 - Standard Specification for Penetration-Graded Asphalt Cement for Use in Pavement Construction; 2009a.
- D. SSPWC - Greenbook: Standard Specifications for Public Works Construction; latest adopted edition.
 - 1. Standard Specifications shall be as amended and adopted by authorities having jurisdiction, including the Little Lake City District.
 - 2. Where reference is made to Standard Details, such reference shall be to the Standard Details accompanying the Standard Specifications, as amended and adopted by the authorities having jurisdiction.
 - 3. Wherever term "Agency" occurs in Standard Specifications, it shall be understood to mean District for purposes of the Contract.
 - 4. Wherever term "Engineer" occurs in Standard Specifications, it shall be understood to mean Architect for purposes of the Contract.

1.04 SUBMITTALS

- A. Materials List: List source and quality standard for all asphaltic concrete materials.
- B. Mix Design:
 - 1. Formulate a job-mix formula using the Hveem method in accordance with SSPWC Section 203-6.2 and submit for approval.
 - 2. Submit designs for asphaltic concrete prepared by a materials laboratory under direct supervision of a Civil Engineer licensed in the State of California or a standard mix design proven in actual performance.
 - 3. Resultant Mixture: Hveem properties conforming to SSPWC Section 203-6.4.3.
- C. Certifications:
 - 1. Weighmaster's Certificates or certified delivery tickets for each truckload of bituminous material delivered to site.
 - 2. Certificates of Conformance: Asphalt, aggregate and sterilant materials.
 - a. 20 days prior to the delivery of aggregates, asphalt materials, and paving mixes to the project site, submit certificates and test results of compliance of such materials with these specifications.
 - b. Submit certificates of compliance from the supplier for bituminous materials for paint binder, asphaltic concrete, and seal coat.
 - c. Submit weigh master's certificates or certified delivery tickets for each truck load of asphaltic material delivered to the project site.
 - d. Upon completion of the weed control treatment, and as a condition for final acceptance, furnish a written certificate stating the brand name of the sterilant and the manufacturer, and that the sterilant used had at least the minimum required concentration, and that the rate and method of application complied in every respect with the conditions and standards contained herein.
- D. Samples:
 - 1. Prior to the delivery of specified aggregate to the site, submit samples of the material for the Inspector's acceptance in accordance with SSPWC Section 4-1.4. Samples shall be typical of materials to be furnished from the proposed source and in conformance with the specified requirements.
 - 2. Provide aggregate base gradation and quality certifications, dated within 30 days of submittal.

1.05 QUALITY ASSURANCE

- A. Perform Work in accordance with locally adopted SSPWC.
- B. Mixing Plant: Conform to Locally adopted SSPWC.
 - 1. Asphaltic Concrete Producers Qualifications: Use only materials furnished by a bulk asphaltic concrete producer regularly engaged in production of hot mix, hot laid bituminous concrete.
 - 2. Applicator Qualifications: Paving machine and roller operators shall be fully trained and experienced in the installation of asphaltic concrete paving on projects of similar size and complexity.

- C. Testing and analysis of granular base material and asphaltic concrete paving mix shall be performed under provisions of Division 1.
- D. Obtain materials from same source throughout.

1.06 REGULATORY REQUIREMENTS

- A. Conform to applicable code for paving work on public property.
- B. Where reference is made to SSPWC, the following shall apply.
 - 1. For conditions not indicated otherwise on Contract Drawings, conform to Standard Details adopted by authorities having jurisdiction, including Standard Details for Public Works Construction, as amended and adopted by those authorities.
 - 2. Perform on-site Work as indicated and referenced on Contract Drawings and as specified herein.
- C. The quantity of volatile organic compounds (VOC) used in weed killer, seal coat, tack coat, primer, and other materials shall not exceed limits permitted under current regulations of South Coast Air Quality Management District (AQMD).

1.07 FIELD CONDITIONS

- A. Do not place asphalt when ambient air or base surface temperature is less than 40 degrees F, or surface is wet or frozen; or when rain is imminent.
 - 1. Tack Coats: Minimum surface temperature of 60 deg F.
 - 2. Asphalt Base Course: Minimum surface temperature of 40 deg F and rising at time of placement.
 - 3. Asphalt Surface Course: Minimum surface temperature of 60 deg F at time of placement.
- B. Place bitumen mixture when temperature is not more than 15 F degrees below bitumen supplier's bill of lading and not more than maximum specified temperature.

PART 2 PRODUCTS

2.01 MATERIALS

- A. General: Aggregate base, prime coat paint binder, bituminous surface course and other materials shall be as noted on the Contract Drawings and shall comply with requirements of authorities having jurisdiction.
- B. Asphalt Cement: ASTM D 946.
- C. Aggregate for Base Course: See Section 32 11 23 - Aggregate Base Course.
- D. Asphalt Concrete Materials: SSPWC, Subsection 203-6.
- E. Mineral Filler: Finely ground particles of limestone, hydrated lime or other mineral dust, free of foreign matter.
- F. Crack Filler:
 - 1. Cracks less than 1/2 inch in width: GuardTop Crackfiller or equal.
 - 2. Cracks 1/2 inch or greater in width: #4 Sheet mix asphalt.
- G. Primer: In accordance with locally adopted SSPWC.

- H. Tack Coat: Homogeneous, medium curing, liquid asphalt.
- I. Seal Coat: AI MS-19, slurry type.
 - 1. Asphalt Emulsion, www.aema.org, SS1-h, per SSPWC Section 203-9.
 - 2. Acceptable Manufacturers:
 - a. Asphalt Coating Engineering; Sure Seal.
 - b. Diversified Asphalt Product; Over Kote: www.diversifiedasphalt.com.
 - c. SealMaster Pavement Products & Equipment; MasterSeal: sealmaster.net.
 - d. Vulcan Materials Company; GuardTop: www.vulcanmaterials.com.
 - e. Western Colloid Products; Park Top: www.westerncolloid.com.
 - f. Satin Seal by Blue Diamond Co., Long Beach, CA.
 - g. Substitutions: See Section 01 60 00 - Product Requirements.

2.02 ASPHALT PAVING MIXES AND MIX DESIGN

- A. Asphalt Surfacing Materials: Provide asphalt surfacing meeting the following requirement, furnished from a commercial asphalt central mixing plant.
- B. Asphalt Paving Mix:
 - 1. Standard Specifications, C2-PG-64-10.
- C. Use dry material to avoid foaming. Mix uniformly.
- D. Base Course: 4.5 to 5.8 percent of asphalt cement by weight in mixture in accordance with SSPWC Section 203-6.4.3, Type B.
- E. Binder Course: 4.5 to 6 percent of asphalt cement by weight in mixture in accordance with AI MS-2.
 - 1. CSS-1 h and conform to the requirements of SSPWC, Section 203-3 Emulsified Asphalt.
- F. Parking Lot Wearing Course: 4.6 to 6.0 percent of asphalt cement by weight in mixture in accordance with SSPWC, Section 203-6.4.3, Type C2.
 - 1. Provide at least two courses of asphalt when Type C2 asphalt pavement is greater than 3 inches.
 - 2. Surface Course Minimum Thickness: 1 inch and a maximum of 2 inches.
- G. Playground Area Wearing Course: 4.8 to 6.5 percent of asphalt cement by weight in mixture in accordance with SSPWC, Section 203-6.4.3, Type D2.
 - 1. Provide at least two courses of asphalt when Type D2 asphalt pavement is greater than 1-1/2 inches.
 - 2. Surface Course Minimum Thickness: 1 inch and a maximum of 1-1/2 inches.
- H. Submit proposed mix design of each class of mix for review prior to beginning of work.

2.03 SOURCE QUALITY CONTROL

- A. Test mix design and samples in accordance with AI MS-2.
- B. Submit asphaltic concrete mix design proposed by the Contractor to the Engineer for review.
- C. Proposed mix to be tested for conformance with the specifications, including grading, asphalt content and stability.

2.04 ACCESSORIES

- A. Headers and Stakes:
 - 1. 2 x 6 inch nominal Redwood, Construction Heart Grade, or preservative treated douglas fir (PTDF), except at curves provide laminated 1 x 6 inch nominal PTDF., unless indicated otherwise on Drawings
 - 2. Stakes: 2 x 4 x 18 inch long Redwood, or 2 x 3 x 18 inch long PTDF; at 48 inch on center maximum.
 - 3. Nails: Common, use hot dipped galvanized only, 12d minimum.
- B. Pavement Reinforcing Fabric: Non-woven polypropylene fabric conforming to SSPWC, Subsection 213-1.
 - 1. Basis of Design Product: Petromat as manufactured by Propex Fabrics inc.; www.geotextile.com, or approved equal.

PART 3 EXECUTION

3.01 EXAMINATION

- A. Refer to geotechnical report referenced in section 8 - 8, provided under separate cover, notes on Contract Drawings, and requirements of authorities having jurisdiction.
- B. Verify that compacted subgrade and granular base is dry and ready to support paving and imposed loads.
- C. Verify gradients and elevations of base are correct.
- D. Fine grading, checking, shaping, and compacting of subgrade shall be complete before start of asphaltic concrete Work.
- E. Soil Sterilant: Sterilize soil areas to receive asphaltic concrete paving. Apply soil sterilant in accordance with manufacturer's instructions and applicable environmental regulations. Take care to confine application to the areas to be paved. See Section 32 11 23 - Aggregate Base Courses for product information.
- F. Curbs and Gutters: Gutters shall be in place and cured prior to start of asphaltic concrete Work. Provide lumber ramping at all locations where rolling equipment or vehicles cross new concrete paving, curbs and gutters.
- G. Headers: Place headers with tops flush with finish asphaltic concrete surfaces. Back headers with stakes.
 - 1. Install headers along edge of bituminous surfacing abutting turf, earth, or planting area, unless indicated otherwise.
 - 2. Install headers so the bottom surface has continuous bearing on solid grade. Where excavation for headers is undercut, thoroughly tamp soil under the header. Compact backfill on both sides of header to the density of adjacent undisturbed earth.
 - 3. Fasten headers in place with redwood or Douglas fir stakes of length necessary to extend into solid grade a minimum of 12 inches. Stakes shall be of sound material, neatly pointed, driven vertically, and securely nailed to headers. Space stakes, not to exceed 4 feet on centers with top of stakes set one inch below top of header. Provide a minimum of 2-12d galvanized common nails through each stake.

4. Remove existing headers where new surfacing is installed adjacent to existing surfacing.
 5. Install temporary headers at transverse joints of paving where continuous paving operations are not maintained.
 6. Provide additional stakes and anchorage as required to fasten headers in place
- H. Do not asphalt concrete on any surface, which contains ponded water or excessive moisture in the opinion of the Architect or consulting engineer.
1. If paving operations are in progress and rain or fog forces a shut down, loaded trucks in transit shall return to the plant, and no compensation will be allowed therefore.
 2. Provide canvas tarpaulins to cover all loads of asphalt from the time that the mixture is loaded until it is discharged from the delivery vehicle, unless otherwise directed in writing.

3.02 BASE COURSE

- A. See Section 32 11 23.
- B. Inspector will examine the base before the paving has begun. Correct any deficiencies before the paving is started.
- C. Wherever asphaltic pavement does not terminate against a curb, gutter, or another pavement, provide and install a redwood or pressure treated Douglas fir header at the line of termination.

3.03 PREPARATION - PRIMER

- A. Apply primer in accordance with manufacturer's instructions.
- B. Apply primer on aggregate base or subbase at uniform rate of 0.25 gal/sq yd.
- C. Apply primer to contact surfaces of curbs, gutters.
- D. Use clean sand to blot excess primer.

3.04 PREPARATION - TACK COAT

- A. Apply tack coat in accordance with SSPWC Section 302-5.4.
- B. Apply tack coat on asphalt or concrete surfaces over subgrade surface at uniform rate of 0.10 gal/sq yd.
- C. Apply tack coat to contact surfaces of curbs, gutters and previously placed or existing paving.
- D. Joining Pavement: Expose, cut and clean edges of existing pavement to straight, vertical surfaces for full depth of existing pavement.
 1. Paint edge with asphalt emulsion before placing new asphaltic concrete.
 2. Joints in New Paving: In accordance with SSPWC.

3.05 PLACING ASPHALT PAVEMENT - SINGLE COURSE

- A. Install Work in accordance with SSPWC Subsection 302-5.
- B. Asphalt concrete of the class indicated in Part 2 shall be laid in courses conforming to SSPWC Table 302-5.5(A), unless otherwise stated herein.
- C. Place asphalt within 24 hours of applying primer or tack coat.

- D. Place thickness as indicated on Civil Drawings to minimum 1 inch compacted thickness.
 - 1. Asphalt concrete work shall include full depth patching and variable thick asphalt concrete transition areas.
 - 2. Provide daily the Inspector, with copies of certificates of weight for all materials delivered to the job site and/or incorporated in the work.
 - 3. At no time shall the coarse aggregate that has segregated from the mix be scattered across the paved mat.
- E. Install gutter drainage grilles and frames and manhole frames in correct position and elevation.
- F. Compact pavement by rolling to specified density. Do not displace or extrude pavement from position.
 - 1. Compact (roll) asphaltic concrete in accordance with SSPWC, Subsection 302-5.6, using machine rollers.
 - a. Compaction by vehicular traffic is prohibited.
 - b. Compact areas inaccessible to rolling equipment with machine-powered tamper.
- G. Perform rolling with consecutive passes to achieve even and smooth finish without roller marks.

3.06 PLACING ASPHALT PAVEMENT - DOUBLE COURSE

- A. Provide at least two courses of asphalt when Type D2 asphalt pavement is greater than 1-1/2 inches. The surface course shall be a minimum thickness of 1 inch and a maximum of 1-1/2 inches.
- B. Provide at least two courses of asphalt when Type C2 asphalt pavement is greater than 3 inches. The surface course shall be a minimum thickness of 1 inch and a maximum of 2 inches.
- C. Install Work in accordance with SSPWC Subsection 302-5.
- D. Place asphalt binder course within 24 hours of applying primer or tack coat.
- E. Place binder course to thickness as indicated on Civil Drawings, minimum 1 inch compacted thickness.
- F. Place wearing course within two hours of placing and compacting binder course.
- G. Place wearing course to thickness as indicated on Civil Drawings, minimum 1 inch compacted thickness.
- H. Install gutter drainage grilles and frames and manhole frames in correct position and elevation.
- I. Compact pavement by rolling to specified density. Do not displace or extrude pavement from position.
 - 1. Compact (roll) asphaltic concrete in accordance with SSPWC, Subsection 302-5.6, using machine rollers.
 - a. Compaction by vehicular traffic is prohibited.
 - b. Compact areas inaccessible to rolling equipment with machine-powered tamper.
- J. Perform rolling with consecutive passes to achieve even and smooth finish, without roller marks.

3.07 SEAL COAT

- A. Apply seal coat after surface course application, in accordance with manufacturer's recommendations.
- B. Apply seal coat to surface course and asphalt curbs in accordance with SSPWC, Subsection 302-8.2.
- C. Add water to specified seal coat material. When air temperatures of 90 degrees F or more are encountered during application, consult manufacturer for recommendations.
- D. If pavement surface exhibits imperfections of roller marks, rock pockets, ridges or depressions as determined by the Architect, the addition of sand aggregate to seal coat, and amounts thereof, shall be as recommended by the manufacturer.
- E. A second application shall be made after first coat has dried to the touch. When sand is added to the first seal coat, two additional coats without extra sand shall be applied.
- F. Allow seal coat to dry before permitting traffic or striping.

3.08 PAVEMENT REPAIR AND PAVING

- A. Preparation of existing pavement: Where indicated, remove loose asphaltic concrete, cleanout "pot holes" and cracks, remove dirt, oil and other foreign materials.
- B. Repair holes with full paving section as specified. Repair "alligating" with asphalt "skin-patch". Fill all cracks larger than 1/4 inch wide with asphalt emulsion slurry.
- C. Tack Coat: Apply asphalt oil AR-4000 or AR-8000, as required for jobsite condition, at metered application rate of no less than a range from .2 to .3 gallons per square yard of fabric or as directed by manufacturer and to provide 100 percent fabric saturation and ample bonding for paving section.
- D. Overlay Asphalt: Place single course asphalt, 1-1/2 inch compacted thickness, in conformance with specified standards in this section.

3.09 TOLERANCES

- A. Flatness: Maximum variation of 1/4 inch measured with 10 foot straight edge.
- B. Compacted Thickness: Within 1/4 inch of specified or indicated thickness.
- C. Variation from True Elevation: Within 1/2 inch.

3.10 FIELD QUALITY CONTROL

- A. See Section 01 40 00 - Quality Requirements, for general requirements for quality control.
- B. Provide field inspection and testing. Take samples and perform tests in accordance with AI MS-2.
- C. Pavement at all longitudinal joints shall have a Field Density of 95%, as described in SSPWC Section 302-5.6.2.
 - 1. When the test results of the field cores are less than 95% Relative Compaction, remove a 1 foot wide section on each side of the longitudinal joint.
 - 2. Replace the removed pavement with an asphalt mix that meets the job specification at no additional cost to the District.
- D. Test: Flood test all paving to demonstrate positive drainage.

1. Before acceptance, water test all pavements to ensure proper drainage as directed by the Inspector.
2. The Contractor shall provide water for this purpose.
3. Flooding Method: By water tank truck.
4. Fill depressions where the water ponds to a depth of more than 1/8 inch; or the slope corrected to provide proper drainage.
5. The edges of the fill shall be feathered and smoothed so that the joint between the fill and the original surface is invisible.
6. No standing water shall remain 1-hour after test.

3.11 PROTECTION

- A. Immediately after placement, protect pavement from mechanical injury for 2 days or until surface temperature is less than 140 degrees F.
 1. After final rolling, prohibit all traffic on asphaltic concrete until mix has fully cooled and set. Minimum time, in all cases shall be 6 hours.

3.12 CLEANING

- A. After completion of paving operations, clean all existing and new improvements that have been soiled, especially by oil tracking from asphalt tanks or placement in general.
- B. For Substantial Completion review, broom clean and wash paving with hoses. Clean residue from landscaping installation.

END OF SECTION

SECTION 32 17 23.13
PAINTED PAVEMENT MARKINGS

PART 1 GENERAL

1.01 SECTION INCLUDES

- A. Parking lot markings, including parking bays, crosswalks, arrows, accessibility symbols, and curb markings.
- B. "No Parking" curb painting.
- C. Playground markings.

1.02 RELATED REQUIREMENTS

- A. **Section 32 12 16 - Asphalt Paving.**
- B. ~~Section 32 13 13 - Concrete Paving.~~
- C. ~~Section 32 17 26 - Tactile Warning Surfacing: Plastic tactile and detectable warning tiles for pedestrian walking surfaces.~~

1.03 REFERENCE STANDARDS

- A. ADA Standards - Americans with Disabilities Act (ADA) Standards for Accessible Design; 2010.
- B. FED-STD-595C - Colors Used in Government Procurement (Fan Deck); 2008 (Chg Notice 1).
- C. FS TT-B-1325 - Beads (Glass Spheres); Retro-Reflective; Rev. D, 2007.
- D. FS TT-P-1952 - Paint, Traffic Black, and Airfield Marking, Waterborne; Rev. E, 2007.
- E. SSPWC - Greenbook: Standard Specifications for Public Works Construction; latest adopted edition.
- F. MPI (APL) - Master Painters Institute Approved Products List; Master Painters and Decorators Association; current edition, www.paintinfo.com.
- G. FHWA MUTCD - Manual on Uniform Traffic Control Devices for Streets and Highways; U.S. Department of Transportation, Federal Highway Administration; Current Edition.
- H. SCAQMD 1113 - South Coast Air Quality Management District Rule No.1113; current edition.

1.04 SUBMITTALS

- A. See Section 01 30 00 - Administrative Requirements, for submittal procedures.
- B. Product Data: Manufacturer's data sheets on each product to be used, including:
 - 1. Preparation instructions and recommendations.
 - 2. Storage and handling requirements and recommendations.
 - 3. Installation methods.
- C. Certificates: Submit for each batch of paint and glass beads stating compliance with specified requirements.
- D. Maintenance Materials: Furnish the following for District's use in maintenance of project.
 - 1. See Section 01 60 00 - Product Requirements, for additional provisions.
 - 2. Extra Paint: 2 containers, 1 gallon size, of each type and color.

1.05 QUALITY ASSURANCE

- A. Regulatory Requirements:
 - 1. See Section 01 61 16 - Volatile Organic Compound (VOC) Content Restrictions regarding CalGreen requirements.
 - a. Comply at time of installation with Air Quality standards of:
 - 1) South Coast Air Quality Management District, SCAQMD 1113.
 - 2) California Air Resources Board (CARB).
 - 3) Local Air Quality Management District (AQMD).
 - 2. For accessibility markings see Part 3 Article "Installation".
 - 3. Conform to State of California, Department of Transportation (CALTRANS) Standard Specifications, Section 84, Traffic Control Markings, as amended and adopted by authorities having jurisdiction.
 - 4. Where reference is made to Standard Specifications, the following shall apply.
 - a. Perform off-site Work in public rights-of-way in accordance with requirements of authorities having jurisdiction. For conditions not indicated otherwise on Contract Drawings, conform to Standard Details adopted by authorities having jurisdiction, including SSPWC.
 - b. Perform on-site Work as indicated and referenced on the Contract Drawings and as specified herein.
- B. Applicator Qualifications: Company regularly engaged in pavement marking, well-experienced in use of machine-applied painted stripes and other markings, with three years of verifiable experience.

1.06 DELIVERY, STORAGE, AND HANDLING

- A. Deliver paint in containers of at least 5 gallons accompanied by batch certificate.
- B. Deliver glass beads in containers suitable for handling and strong enough to prevent loss during shipment accompanied by batch certificate.
- C. Store products in manufacturer's unopened packaging until ready for installation.
- D. Store and dispose of solvent-based materials, and materials used with solvent-based materials, in accordance with requirements of local authorities having jurisdiction.

1.07 FIELD CONDITIONS

- A. Do not install products under environmental conditions outside paint manufacturer's absolute limits.
 - 1. Do not apply marking paint when weather is foggy or rainy, or when ambient or pavement temperatures are below 40 degrees F., or when such conditions are anticipated within eight hours of application.
- B. Do not apply marking paint when wind velocity causes uncontrollable overspray or excessively rapid drying.
- C. Sequence and Schedule: Apply pavement markings after asphaltic concrete and portland cement concrete and interlocking concrete paving Work are complete and properly cured

and, if applicable, sealer has been applied to asphaltic concrete and landscaping Work is complete.

PART 2 PRODUCTS

2.01 MATERIALS

- A. General: Provide standard factory-mixed, quick drying and non-bleeding colors, conforming to Standard Specifications, as amended and adopted by the AHJ, City, and County, as applicable.
- B. Line and Zone Marking Paint: Rapid Dry, Oil Base, VOC Compliant, MPI No. 97 Latex Traffic Marking Paint; color(s) as indicated.
 - 1. Parking Lots: Fast-dry type. If required by authorities having jurisdiction for Work in public rights-of-way, include reflective material in paint. Paint for marking curbs shall not require reflective material. See Color Schedule in Part 3.
 - 2. Accessibility Symbols: Blue shall conform to Color No. 15090, FED-STD-595C.
 - 3. Substitutions: See Section 01 60 00 - Product Requirements.
- C. Recreational Area Paint:
 - 1. Paint: Water emulsion-based traffic paint; FS TT-P-1952.
 - 2. Color: To be selected by Architect from full range.
 - 3. Basis of Design Product: 6700 100%Acrylic Traffic Marking Paint as manufactured by Vista Paint, or approved equal.
 - 4. Products:
 - a. Behr: www.behr.com.
 - b. Dunn Edwards: www.dunnedwards.com.
 - c. Sherwin Williams; 2 Coats of SW Armorseal 8100 with Armorseal High Wear Additive in second coat: www.sherwin.com.
 - d. Vista Paint Corporation: www.vistapaint.com.
 - e. Substitutions: See Section 01 60 00 - Product Requirements.
- D. Paint For Obliterating Existing Markings: FS TT-P-1952; black for bituminous pavements, gray for portland cement pavements.
- E. Reflective Glass Beads: FS TT-B-1325, Type I (low index of refraction), Gradation A (coarse, drop-on); with silicone or other suitable waterproofing coating to ensure free flow.
 - 1. Comply with CALTRANS State Specification No. 8010-51J-22, Type II, and CBC Section 11B-502.6 Identification.
- F. Temporary Marking Tape: Preformed, reflective, pressure sensitive adhesive tape in color(s) required; Contractor is responsible for selection of material of sufficient durability as to perform satisfactorily during period for which its use is required.
- G. Tactile Warning Surfaces: See Section 32 17 26.
- H. Raised Reflective Pavement Markers
 - 1. Specified Manufacturer: Pac-Tec, Inc., Heath, OH (800) 848-7025; local source Western Highway Products (800) 479-3783.
 - 2. Ray-O-Lite Raised Reflective Pavement Markers:

- a. Molded optic grade Methyl Methacrylate conforming to ASTM D4802 with fill material consisting of thermosetting compound designed for impact and wear resistance.
- b. Optical Performance: Reflective intensity of reflecting surface at 1/5 degree divergence angle shall be not less than the following when the incident light is parallel.

<u>Horiz. Eng. Angle</u>	<u>Blue</u>
0 Degrees	3.0
20 Degrees	1.5

PART 3 EXECUTION

3.01 EXAMINATION

- A. Do not begin installation until substrates have been properly prepared.
- B. If substrate preparation is the responsibility of another installer, notify Architect of unsatisfactory preparation before proceeding.

3.02 PREPARATION

- A. Allow new pavement surfaces to cure for a period of not less than 14 days before application of marking materials.
- B. Prepare surfaces using the methods recommended by the manufacturer for achieving the best result for the substrate under the project conditions.
- C. Clean surfaces thoroughly prior to installation.
 - 1. Remove dust, dirt, and other granular surface deposits by sweeping, blowing with compressed air, rinsing with water, or a combination of these methods.
 - 2. Completely remove rubber deposits, existing paint markings, and other coatings adhering to the pavement, by scraping, wire brushing, sandblasting, mechanical abrasion, or approved chemicals.
- D. Where oil or grease are present, scrub affected areas with several applications of trisodium phosphate solution or other approved detergent or degreaser, and rinse thoroughly after each application; after cleaning, seal oil-soaked areas with cut shellac to prevent bleeding through the new paint.
- E. Establish survey control points to determine locations and dimensions of markings; provide templates to control paint application by type and color at necessary intervals.
 - 1. Lay out markings as shown on Drawings. Use guide lines, templates and forms for precise edges and spacings.
 - a. At off-site and on-site public rights-of-way, obtain review and approval of layout by authorities having jurisdiction.
- F. Temporary Pavement Markings: When required or directed by Architect, apply temporary markings of the color(s), width(s) and length(s) as indicated or directed.

1. After temporary marking has served its purpose, remove temporary marking by carefully controlled sandblasting, approved grinding equipment, or other approved method so that surface to which the marking was applied will not be damaged.
2. At Contractor's option, temporary marking tape may be used in lieu of temporary painted marking; remove unsatisfactory tape and replace with painted markings at no additional cost to District.

3.03 INSTALLATION

A. Regulatory Accessibility Requirements for Installation:

1. Pavement markings for disability requirements shall meet requirements of California Building Code (CBC), Title 24, Part 2, Chapter 11B and ADA Accessibility Guidelines for Buildings and Facilities, per latest amendments.
 - a. Accessible parking spaces serving a particular building or facility shall be located, and dispersed if serving more than one accessible entrance, on the shortest accessible route to an entrance or to multiple accessible entrances. CBC Sections 11B-208.3.1
 - b. Accessible parking spaces in a parking facility not serving a particular building or facility shall be located on the shortest accessible route to an accessible pedestrian entrance of the parking facility. CBC Sections 11B-208.3.1
 - c. Minimum number of required accessible parking spaces shall be provided in accordance with CBC Table 11B-208.2 for each parking facility provided.
 - d. For every six or fraction of six accessible parking spaces, at least one shall be an accessible van parking space. CBC Section 11B-208.2.4
 - e. Accessible parking spaces and access aisles shall comply with CBC Section 11B-502 and shall be dimensioned to the centerline of the marked lines as follows:
 - 1) Parking spaces and access aisles shall be marked according to CBC Figures 11B-502.2, 11B-502.3, and 11B-502.3.3.
 - (a) Their surfaces shall comply with CBC Section 11B-302 and shall be at the same level with slopes not steeper than 1:48 in any direction. CBC Section 11B-502.4.
 - 2) Parking spaces shall be 9 x 18 feet minimum and van parking spaces shall be 12 x 18 feet minimum with an adjacent access aisle of 5 x 18 feet minimum.
 - (a) Access aisles shall be placed on either side of the parking spaces except be located on the passenger side for van parking spaces.
 - (b) Van parking spaces shall be permitted to be 9 x 18 feet minimum where the access aisle is 8 x 18 feet minimum.
 - 3) Access aisles shall be marked by a blue painted borderline around their perimeter.
 - (a) The area within the blue borderlines shall be marked with hatched lines a maximum of 36 inches on center in a color contrasting with that of the aisle surface, preferably blue or white.
 - (b) Access aisle markings may extend beyond the minimum required length. CBC Section 11B-502.3.3
 - 4) Access aisles (parking spaces as well- similar application) shall not overlap the vehicular way. CBC Section 11B-502.3.4

- 5) A vertical clearance of 98 inches minimum shall be provided for accessible parking spaces, access aisles, and vehicular routes serving them. CBC Section 11B-502.5
2. At least one passenger loading zone shall be provided in every continuous 100 linear feet of loading zone space, or fraction thereof, complying with CBC Sections 11B-209 and 11B-503 as follows:
 - a. Vehicle pull-up spaces shall be 9 x 20 feet minimum.
 - 1) Access aisles shall be 5 x 20 feet minimum and shall be adjacent and parallel to the vehicular pull-up spaces.
 - 2) They shall be at the same level with slopes not steeper than 1:48 in any direction. CBC Section 11B-503.4
 - b. Access aisles for passenger drop-off and loading zone shall be marked with a painted borderline around their perimeter.
 - 1) The area within the borderlines shall be marked with hatched lines a maximum of 36 inches on center in a color contrasting with that of the aisle surface. CBC Section 11B-503.3
 - c. A vertical clearance of 114 inches minimum shall be provided for vehicle pull-up spaces, access aisles, and a vehicular route serving them connecting a vehicular entrance and a vehicular exit. CBC Section 11B-503.5
 3. Bus loading zones and bus stops shall comply with CBC Sections 11B-209 and 11B-810.2 as follows:
 - a. Boarding and alighting areas shall be of 8 x 5 feet minimum, with 8 feet measured perpendicular to the curb or vehicle roadway edge, and with 5 feet measured parallel to the vehicle roadway.
 - 1) Slopes in 8 foot direction shall be 1:48 maximum.
 - 2) Slopes in 5 foot direction shall be the same as that of the roadway, to the maximum extent practicable. CBC Figure 11B-810.2.2.
 - b. Bus shelters shall provide a minimum 30 x 48 inches clear floor or ground space (36 x 48 inches or 36 x 60 inches as applicable in an alcove), with slopes not steeper than 1:48 in any direction, entirely within the shelter complying with CBC Section 11B-305.
 - c. Bus shelters shall be connected by an accessible route complying with CBC Section 11B-402 to a boarding and alighting area complying with CBC Section 11B-810.2; CBC Figure 11B-810.3.
- B. General: Using proper masking, stencils and application equipment, apply marking paint at rate recommended by paint manufacturer or approximately one gallon per 150 square feet (equivalent to approximately one gallon for 450 lineal feet of 4-inch wide stripe), whichever is greater.
1. Equipment shall be capable of operating at 125 psi air pressure, agitate paint constantly and hold exactly to the alignment.
 2. Equipment used for applying reflectorized striping shall be equipped with a bead dispenser capable of applying beads at the specified rate.
- C. Begin pavement marking as soon as practicable after surface has been cleaned and dried.

- D. Do not apply paint if temperature of surface to be painted or the atmosphere is less than 50 degrees F or more than 95 degrees F.
- E. Apply in accordance with manufacturer's instructions using an experienced technician that is thoroughly familiar with equipment, materials, and marking layouts.
- F. Comply with FHWA MUTCD manual (<http://mutcd.fhwa.dot.gov>) for details not shown.
- G. Apply markings in locations determined by measurement from survey control points; preserve control points until after markings have been accepted.
- H. Apply uniformly painted markings of color(s), lengths, and widths as indicated on the drawings true, sharp edges and ends.
 - 1. Apply paint in one coat only.
 - 2. Wet Film Thickness: 0.015 inch, minimum.
 - 3. Length Tolerance: Plus or minus 3 inches.
 - 4. Width Tolerance: Plus or minus 1/8 inch.
- I. Curbs: Paint full vertical face and first 6-inches of horizontal plane at top of curb or combination curb/paving. Provide minimum 2 coats paint.
 - 1. Provide stenciled text in the height, spacing and typeface as indicated on Drawings.
- J. Parking Lots: Apply parking space lines, entrance and exit arrows, painted curbs, and other markings indicated on drawings.
 - 1. Mark the International Symbol of Accessibility at indicated parking spaces.
 - a. Accessibility Logo: Provide minimum of 2 coats paint.
 - 1) Comply with CBC Figure 11B-703.7.2.1.
 - b. Stall Marking:
 - 1) Use single-line style striping between parking stalls, unless otherwise indicated.
 - 2) Comply with local agency regulatory requirements.
 - 3) Accessible Stalls: Comply with ADA Standards and local agency regulatory requirements.
 - (a) Painted lines and markings on pavement shall be minimum 3 inches wide, color as indicated on Drawings
 - (b) Tactile warning lines shall comply with CBC Section 11B-705.1.2.5 Hazardous Vehicular Areas.
 - (c) Tactile warning devices shall comply with CBC, see Section 32 17 26 - Tactile Warning Surfacing.
 - c. Hatching: Provide hatching in parking areas, including accessible parking stalls, as indicated on Contract Drawings or as required by Standard Details. Should Contract Drawings and Standard Details conflict, comply with the more stringent.
 - 2. Hand application by pneumatic spray is acceptable.
- K. Symbols: Use a suitable template that will provide a pavement marking with true, sharp edges and ends, of the design and size indicated.
- L. Speed Bumps: Provide minimum 2 coats paint on raised portion.
- M. Recreational Areas: Provide minimum 2 coats paint.

3.04 DRYING, PROTECTION, AND REPLACEMENT

- A. Protect newly painted markings so that paint is not picked up by tires, smeared, or tracked.
 - 1. Prevent construction activities over completed markings, except light vehicular and pedestrian traffic.
- B. Provide barricades, warning signs, and flags as necessary to prevent traffic crossing newly painted markings.
- C. Allow paint to dry at least the minimum time specified by the applicable paint standard and not less than that recommended by the manufacturer.
- D. Touch-up paint as required to provide clean, straight lines and full coverage of surfaces.
- E. Remove and replace markings that are applied at less than minimum material rates; deviate from true alignment; exceed length and width tolerances; or show light spots, smears, or other deficiencies or irregularities.
- F. Remove markings in manner to avoid damage to the surface to which the marking was applied, using carefully controlled sand blasting, approved grinding equipment, or other approved method.
- G. Replace removed markings at no additional cost to District.
 - 1. Clean up all oil, paint splatters and other stains from surfaces in preparation for Substantial Completion review.

3.05 COLOR SCHEDULE

- A. Parking and Roadways

Location	Color	Reflectance**
Driving lane striping	White	82%
Parking space striping	White	82%
Accessible Parking and zone markings	Blue No. 15090 per Federal Standard 595C	52%
Accessible loading and cross-hatching	White with Blue perimeter at Asphalt Paving. Blue at Concrete Paving*	82% / 52%
Text: "NO PARKING", "LOADING ZONE", and "FIRE LANE", etc.	White	82%
Firelanes/No Parking zone markings Special Use Markings	Red No. 31136 per Federal Standard 595C	52%
Loading zone markings	Yellow No. 33538 per Federal Standard 595C	52%
Directional arrows	White	82%
Speed Bumps	Yellow No. 33538 per Federal Standard 595C	52%

CHARLESWORTH ROAD

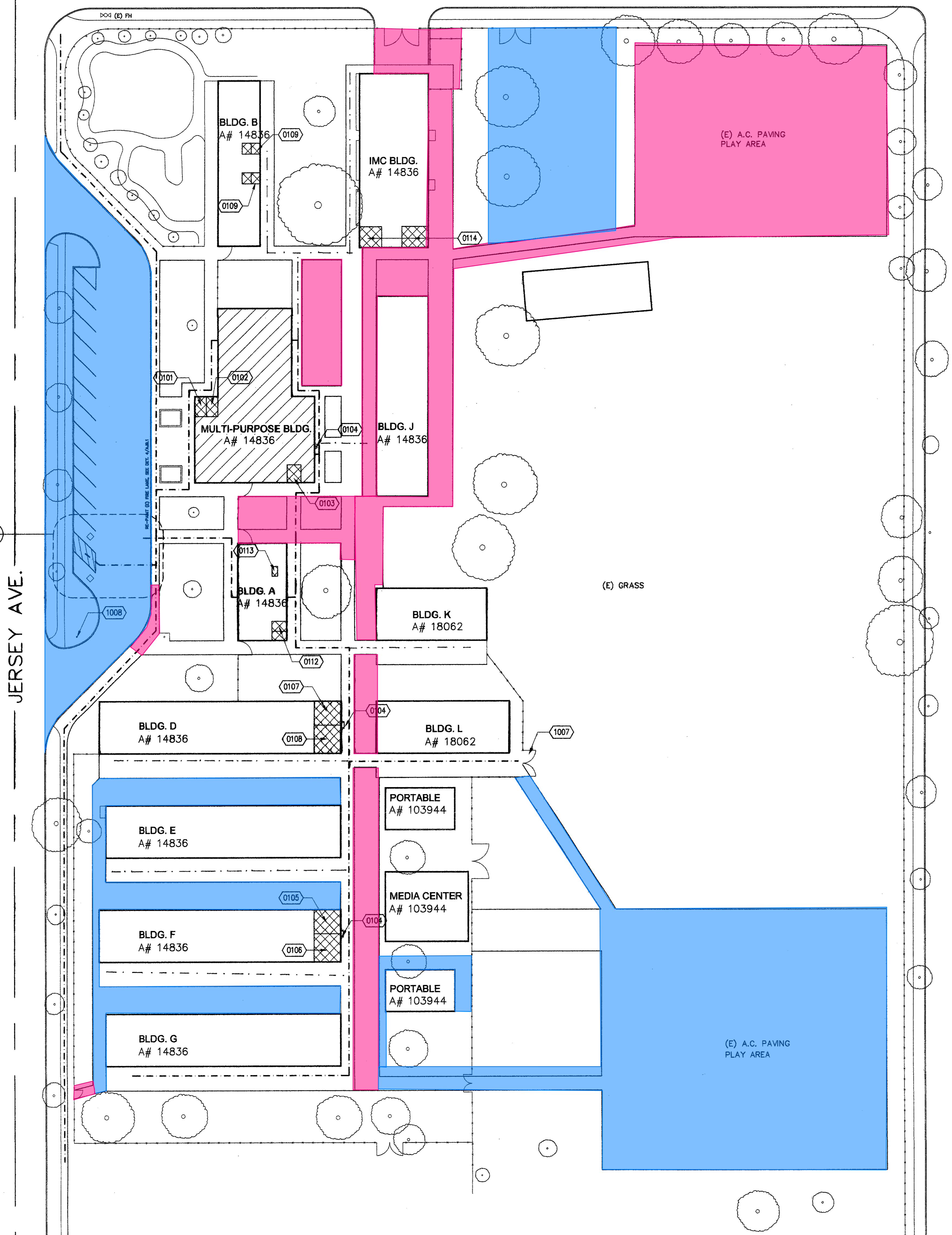

1

-Contractor to provide 1000' lineal feet of hot crack fill as specified. Contractor to figure the cracks are *minimum 2"* wide.
 - Contractor to provide 750' square feet of *demo and patch back* of 6" asphalt and 6" base as *directed by the Construction Manager. Contractor to figure 5 different locations.*
 - Contractor to provide striping to match existing.
 - Contractor shall clean existing surface thoroughly prior to applying 1st coat.
 - Contractor to provide any grinding needed for *smooth transition from new asphalt to existing.*
 - Contractor shall figure to remove all wheel stops and reinstall after completion of slurry coat as *specified.*
 - Contractor shall paint curbs to match existing.
 - Contractor to provide new redwood headers as needed where asphalt doesn't abut to concrete
 - Contractor to provide two coats of slurry as *specified within the specifications.*

-Contractor to provide removal of existing 6" asphalt and 6" base UNO.
 - Remove any native or imported fill to allow for new asphalt and base to be installed.
 - Contractor to provide 6" of asphalt over 6" of base.
 - Provide all compaction and grading to meet ADA Requirements and (E) adjacent grades. Sub grade, base to be compacted to 95% - Contractor shall clean existing surface thoroughly prior to applying seal coat. - Contractor to provide any grinding needed for smooth transition from new asphalt to existing
 - Contractor to provide striping to match existing.
 - Contractor to provide two coats of slurry as *specified within the specifications.*

-Contractor to provide removal of existing 6" asphalt and 6" base UNO.
 - Remove any native or imported fill to allow for new concrete to be installed.
 - Contractor to provide 6" of concrete over 6" of compacted base fill. Sub grade to be compacted to 95%
 - Contractor to provide reinforcement concrete wire mesh and drill, epoxy No. 4's 16" OC, 6" min into existing concrete.
 - Contractor shall provide all compaction to 95% and grading to meet ADA Requirements. New grading shall meet E) adjacent grades.

REFERENCE NOTES

Blank space for reference notes.

LEGEND

PATH OF TRAVEL (P.O.T.) AS INDICATED IS A BARRIER FREE ACCESS AT LEAST 48" WIDE WITHOUT ANY ABRUPT VERTICAL CHANGES EXCEEDING 1/2" AT 1:12 MAXIMUM SLOPE, EXCEPT THAT LEVEL CHANGES DO NOT EXCEED 1/4" VERTICAL. MAXIMUM CROSS-SLOPE 2% TYPICAL AND SLOPE IN THE DIRECTION OF TRAVEL DOES NOT EXCEED 5%, UNLESS OTHERWISE NOTED. THE CONTRACTOR SHALL VERIFY THAT ALL BARRIERS ON THE INDICATED PATH OF TRAVEL HAVE BEEN REMOVED.

PATH OF TRAVEL

Blank space for path of travel notes.

TOTAL PARKING SPACES = 13	STALL TYPE		
	STANDARD	ACCESSIBLE	TOTAL
ACCESSIBLE PARKING SPACE REQ'D (2001 CBC TABLE 11B-6) = 1	11	1	13

PARKING TABULATION

3

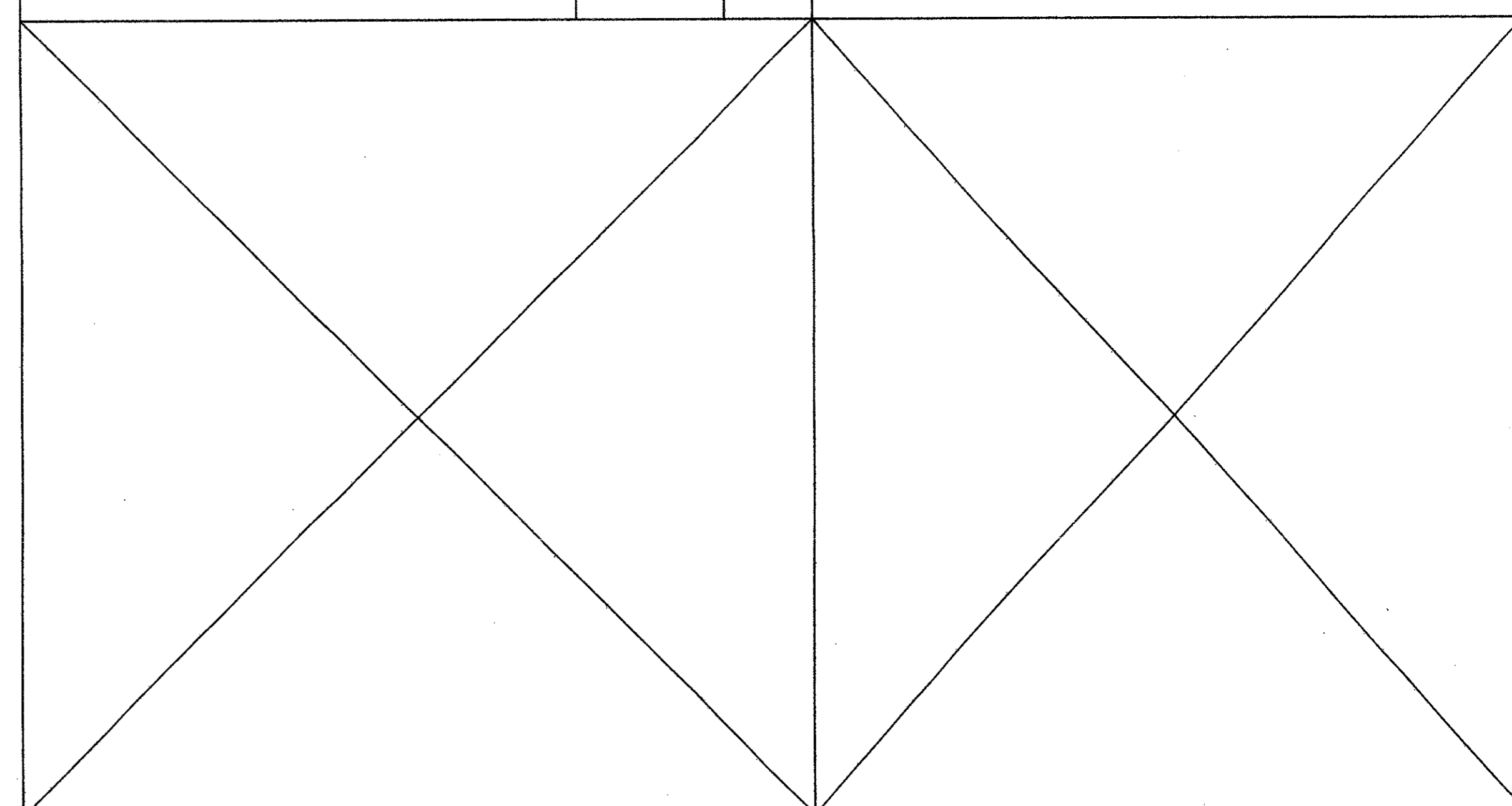

JERSEY ELEMENTARY SCHOOL
 LITTLE LAKE CITY SCHOOL DISTRICT
 SANTA FE SPRINGS, CA

OVERALL SITE PLAN

1" = 30'-0" 5 NOT USED

4 NOT USED

NO	DATE	BY	DESCRIPTION

REVISIONS

OVERALL SITE PLAN

DRAWING NUMBER : AJ1.1

CRESSON ST.

MILANO AVE.

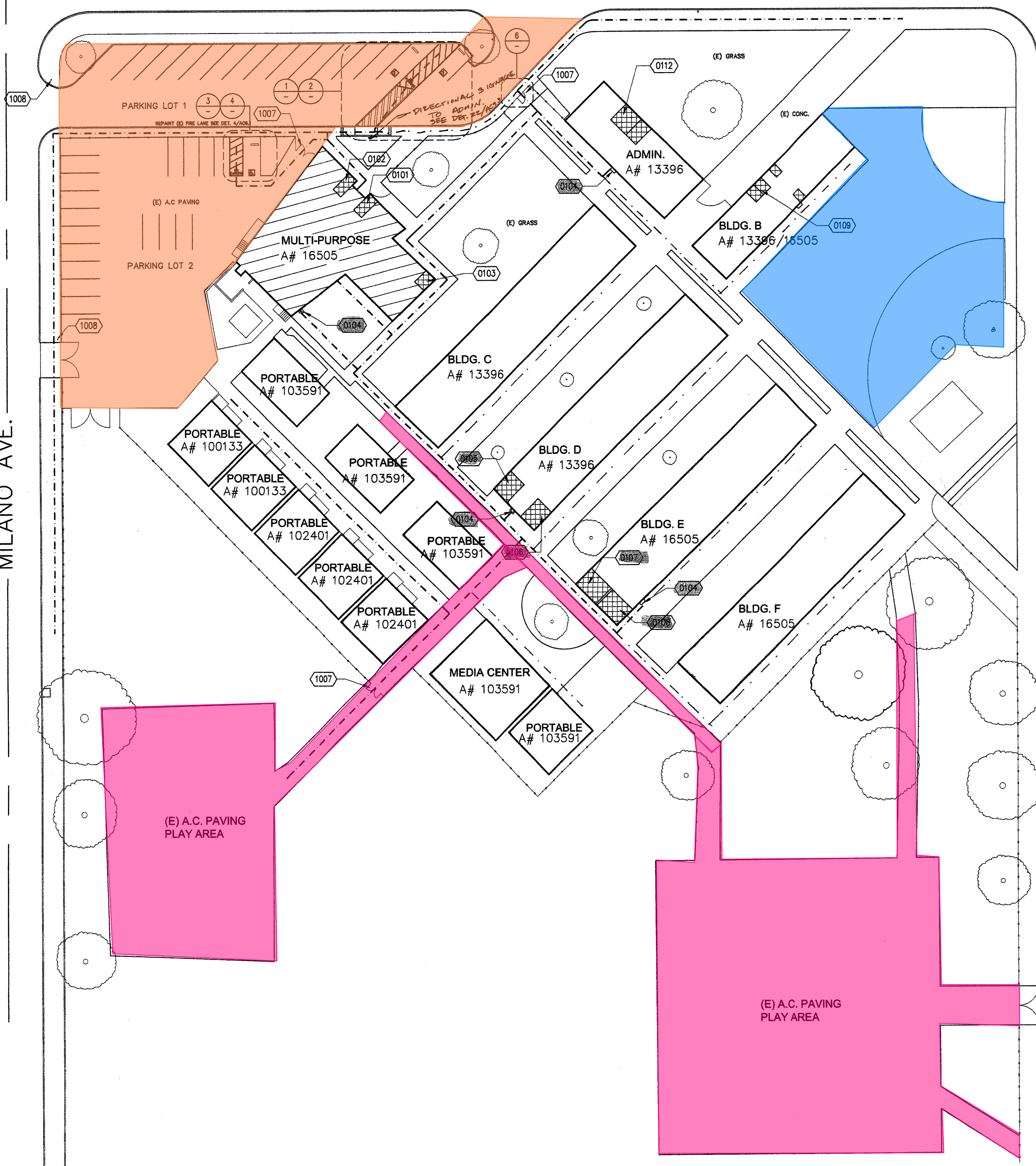

1

-Contractor to provide 1000' lineal feet of hot crack fill as specified. Contractor to figure the cracks are *minimum* 2" wide.
 - Contractor to provide 750' square feet of *demo and patch* back of 6" asphalt and 6" base as directed by the Construction Manager. Contractor to figure 5 different locations.
 - Contractor to provide striping to match existing.
 - Contractor shall clean existing surface thoroughly prior to applying 1st coat.
 - Contractor to provide any grinding needed for smooth transition from new asphalt to existing.
 - Contractor shall figure to remove all wheel stops and reinstall after completion of slurry coat as specified.
 - Contractor shall paint curbs to match existing.
 - Contractor to provide new redwood headers as needed where asphalt doesn't abut to concrete
 - Contractor to provide two coats of slurry as specified within the specifications.

-Contractor to provide removal of existing 6" asphalt and 6" base UNO.
 - Remove any native or imported fill to allow for new asphalt and base to be installed.
 - Contractor to provide 6" of asphalt over 6" of base.
 - Provide all compaction and grading to meet ADA Requirements and (E) adjacent grades. Sub grade, base to be compacted to 95% - Contractor shall clean existing surface thoroughly prior to applying seal coat. - Contractor to provide any grinding needed for smooth transition from new asphalt to existing
 - Contractor to provide striping to match existing.
 - Contractor to provide two coats of slurry as specified within the specifications.

-Contractor to provide removal of existing 6" asphalt and 6" base UNO.
 - Remove any native or imported fill to allow for new concrete to be installed.
 - Contractor to provide 6" of concrete over 6" of compacted base fill. Sub grade to be compacted to 95%
 - Contractor to provide reinforcement concrete wire mesh and drill, epoxy No. 4's 16" OC, 6" min into existing concrete.
 - Contractor shall provide all compaction to 95% and grading to meet ADA Requirements. New grading shall meet E) adjacent grades.

PATH OF TRAVEL (P.O.T.) AS INDICATED IS A BARRIER FREE ACCESS AT LEAST 48" WIDE WITHOUT ANY ABRUPT VERTICAL CHANGES EXCEEDING 1/2" AT 1:12 MAXIMUM SLOPE, EXCEPT THAT LEVEL CHANGES DO NOT EXCEED 1/4" VERTICAL. MAXIMUM CROSS-SLOPE 2% TYPICAL AND SLOPE IN THE DIRECTION OF TRAVEL DOES NOT EXCEED 5%, UNLESS OTHERWISE NOTED. THE CONTRACTOR SHALL VERIFY THAT ALL BARRIERS ON THE INDICATED PATH OF TRAVEL HAVE BEEN REMOVED.

PATH OF TRAVEL

PARKING LOT 1		STALL TYPE			
TOTAL PARKING SPACES = 15		STANDARD	ACCESSIBLE		
ACCESSIBLE PARKING SPACE REQ'D (2001 CBC TABLE 11B-6) = 1			STANDARD	VAN	TOTAL
		13	1	1	15

PARKING LOT 2		STALL TYPE			
TOTAL PARKING SPACES = 19		STANDARD	ACCESSIBLE		
ACCESSIBLE PARKING SPACE REQ'D (2001 CBC TABLE 11B-6) = 1			STANDARD	VAN	TOTAL
		17	1	1	19

CRESSON ELEMENTARY SCHOOL
 LITTLE LAKE CITY SCHOOL DISTRICT
 NORWALK, CA

OVERALL SITE PLAN

1" = 30'-0" 5

PARKING TABULATION

△	04.21.2022		Addendum 1- Scope Clarification
△			
△			
△			
NO	DATE	BY	DESCRIPTION
REVISIONS			

OVERALL SITE PLAN

DRAWING NUMBER : **AC1.1**

8 NOT USED 7

NOT USED

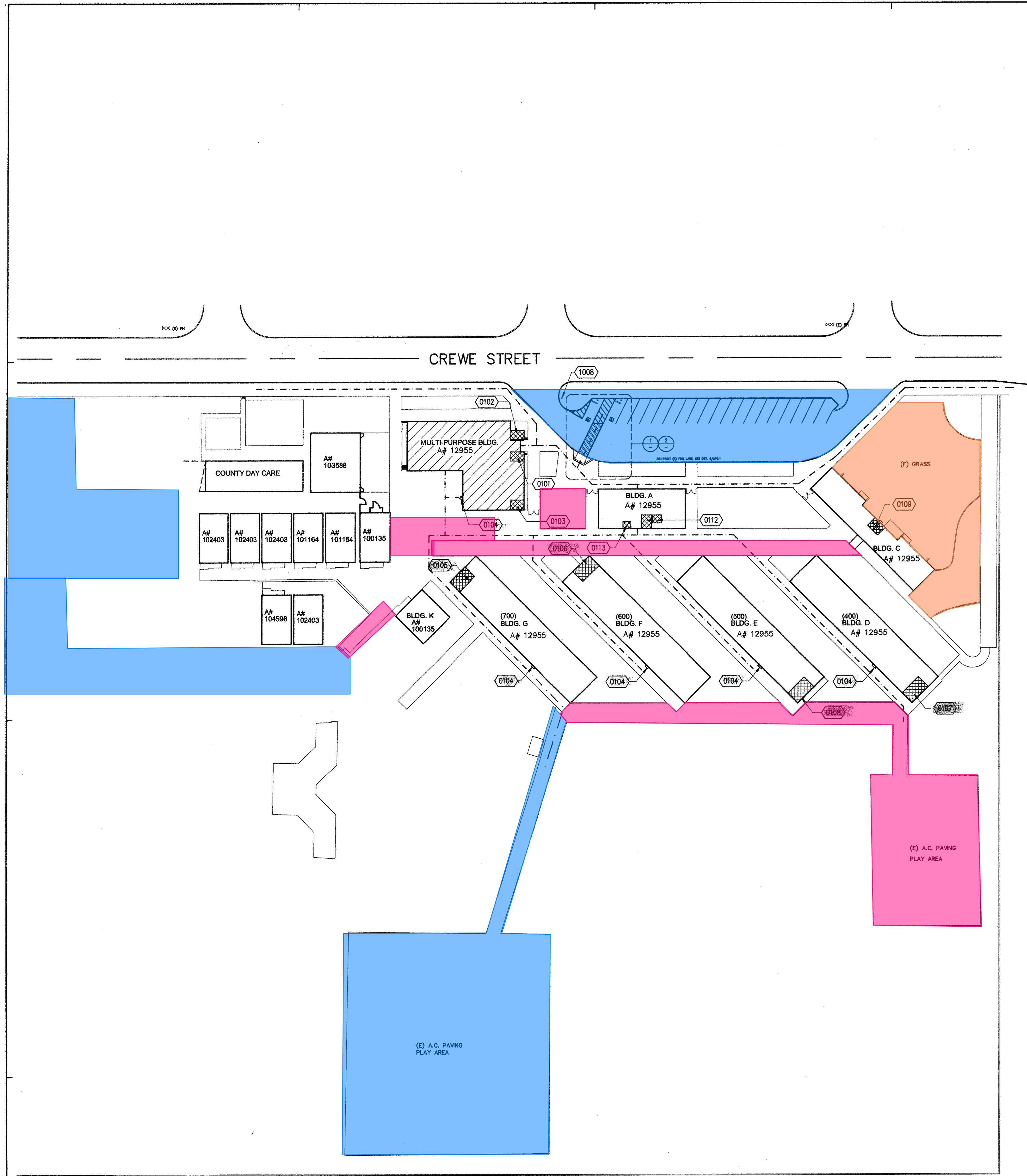

- Contractor to provide 1000' lineal feet of hot crack fill as specified. Contractor to figure the cracks are *minimum 2" wide*.
 - Contractor to provide 750' square feet of *demo and patch back of 6" asphalt and 6" base as directed by the Construction Manager. Contractor to figure 5 different locations.*
 - Contractor to provide striping to match existing.
 - Contractor shall clean existing surface thoroughly prior to applying 1st coat.
 - Contractor to provide any grinding needed for *smooth transition from new asphalt to existing.*
 - Contractor shall figure to remove all wheel stops and reinstall after completion of slurry coat as *specified.*
 - Contractor shall paint curbs to match existing.
 - Contractor to provide new redwood headers as needed where asphalt doesn't abut to concrete
 - Contractor to provide two coats of slurry as specified within the specifications.

- Contractor to provide removal of existing 6" asphalt and 6" base *UNO.*
 - Remove any native or imported fill to allow for new asphalt and base to be installed.
 - Contractor to provide 6" of asphalt over 6" of base.
 - Provide all compaction and grading to meet ADA Requirements and (E) adjacent grades. Sub grade, base to be compacted to 95% -Contractor shall clean existing surface thoroughly prior to applying seal coat. -Contractor to provide any grinding needed for smooth transition from new asphalt to existing
 - Contractor to provide striping to match existing.
 - Contractor to provide two coats of slurry as specified within the specifications.

- Contractor to provide removal of existing 6" asphalt and 6" base *UNO.*
 - Remove any native or imported fill to allow for new concrete to be installed.
 - Contractor to provide 6" of concrete over 6" of compacted base fill. Sub grade to be compacted to 95%
 - Contractor to provide reinforcement concrete wire mesh and drill, epoxy No. 4's 16" OC, 6" min into existing concrete.
 - Contractor shall provide all compaction to 95% and grading to meet ADA Requirements. *New grading shall meet E) adjacent grades.*

LEGEND

PATH OF TRAVEL (P.O.T.) AS INDICATED IS A BARRIER FREE ACCESS AT LEAST 48" WIDE WITHOUT ANY ABRUPT VERTICAL CHANGES EXCEEDING 1/2" AT 1:12 MAXIMUM SLOPE, EXCEPT THAT LEVEL CHANGES DO NOT EXCEED 1/4" VERTICAL. MAXIMUM CROSS-SLOPE 2% TYPICAL AND SLOPE IN THE DIRECTION OF TRAVEL DOES NOT EXCEED 5% UNLESS OTHERWISE NOTED. THE CONTRACTOR SHALL VERIFY THAT ALL BARRIERS ON THE INDICATED PATH OF TRAVEL HAVE BEEN REMOVED.

PATH OF TRAVEL

TOTAL PARKING SPACES = 20	STALL TYPE			
	STANDARD	ACCESSIBLE		
ACCESSIBLE PARKING SPACE REQ'D (2001 CBC TABLE 11B-6) = 2		STANDARD	VAN	TOTAL
	18	1	1	20

3		PARKING TABULATION	

PADDISON ELEMENTARY SCHOOL
 LITTLE LAKE CITY DISTRICT
 12100 CREW ST NORWALK CA, 90650

NO	DATE	BY	DESCRIPTION

REVISIONS

OVERALL SITE PLAN

DRAWING NUMBER: **AP1.1**

OVERALL SITE PLAN

1" = 40'-0" 5

NOT USED

4 NOT USED

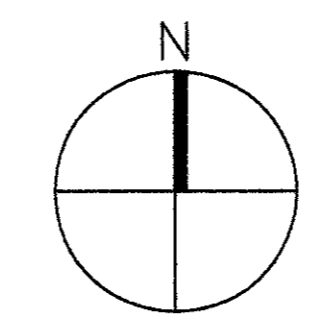

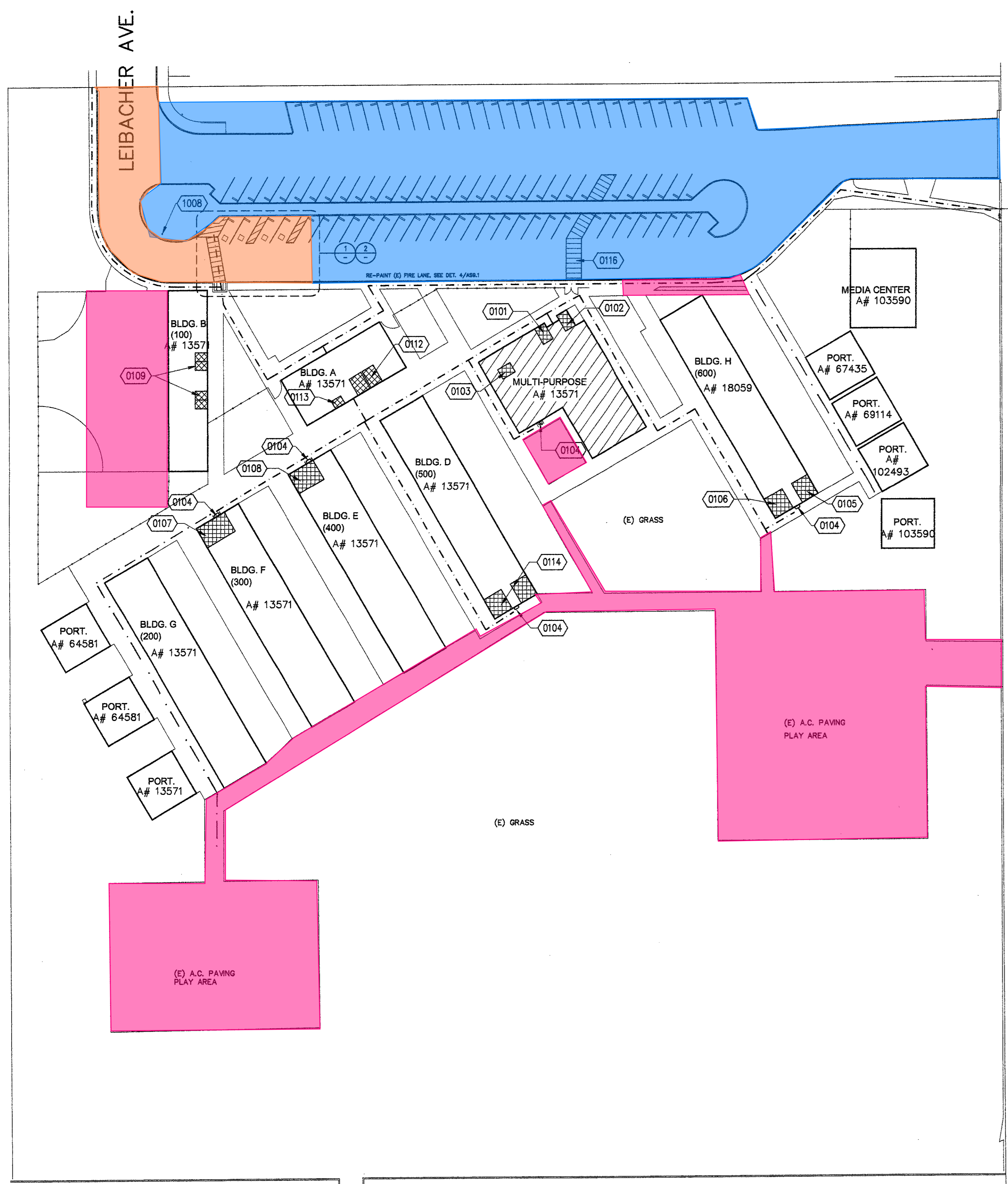

1

- Contractor to provide 1000' lineal feet of hot crack fill as specified. Contractor to figure the cracks are *minimum* 2" wide.
- Contractor to provide 750' square feet of *demo and patch back* of 6" asphalt and 6" base as directed by the Construction Manager. Contractor to figure 5 different locations.
- Contractor to provide striping to match existing.
- Contractor shall clean existing surface thoroughly prior to applying 1st coat.
- Contractor to provide any grinding needed for smooth transition from new asphalt to existing.
- Contractor shall figure to remove all wheel stops and reinstall after completion of slurry coat as specified.
- Contractor shall paint curbs to match existing.
- Contractor to provide new redwood headers as needed where asphalt doesn't abut to concrete
- Contractor to provide two coats of slurry as specified within the specifications.

- Contractor to provide removal of existing 6" asphalt and 6" base UNO.
- Remove any native or imported fill to allow for new asphalt and base to be installed.
- Contractor to provide 6" of asphalt over 6" of base.
- Provide all compaction and grading to meet ADA Requirements and (E) adjacent grades. Sub grade, base to be compacted to 95%
- Contractor shall clean existing surface thoroughly prior to applying seal coat. -Contractor to provide any grinding needed for smooth transition from new asphalt to existing
- Contractor to provide striping to match existing.
- Contractor to provide two coats of slurry as specified within the specifications.

- Contractor to provide removal of existing 6" asphalt and 6" base UNO.
- Remove any native or imported fill to allow for new concrete to be installed.
- Contractor to provide 6" of concrete over 6" of compacted base fill. Sub grade to be compacted to 95%
- Contractor to provide reinforcement concrete wire mesh and drill, epoxy No. 4's 16" OC, 6" min into existing concrete.
- Contractor shall provide all compaction to 95% and grading to meet ADA Requirements. New grading shall meet E) adjacent grades.

PATH OF TRAVEL (P.O.T.) AS INDICATED IS A BARRIER FREE ACCESS AT LEAST 48" WIDE WITHOUT ANY ABRUPT VERTICAL CHANGES EXCEEDING 1/2" AT 1:12 MAXIMUM SLOPE, EXCEPT THAT LEVEL CHANGES DO NOT EXCEED 1/4" VERTICAL. MAXIMUM CROSS-SLOPE 2% TYPICAL AND SLOPE IN THE DIRECTION OF TRAVEL DOES NOT EXCEED 5%, UNLESS OTHERWISE NOTED. THE CONTRACTOR SHALL VERIFY THAT ALL BARRIERS ON THE INDICATED PATH OF TRAVEL HAVE BEEN REMOVED.

PATH OF TRAVEL

TOTAL PARKING SPACES = 90	STALL TYPE			
ACCESSIBLE PARKING SPACE REQ'D (2001 CBC TABLE 11B-6) = 4	STANDARD	ACCESSIBLE		TOTAL
	86	STANDARD	VAN	
		3	1	90

PARKING TABULATION

STUEBAKER ELEMENTARY SCHOOL
LITTLE LAKE CITY SCHOOL DISTRICT
NORWALK, CA

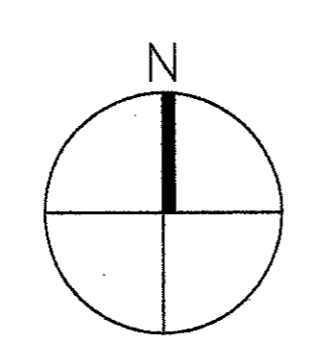

OVERALL SITE PLAN

1" = 40'-0" 3

△	04.21.2022		Addendum 1- Scope Clarification
△			
△			
△			
NO	DATE	BY	DESCRIPTION
REVISIONS			

OVERALL SITE PLAN

DRAWING NUMBER : AS1.1

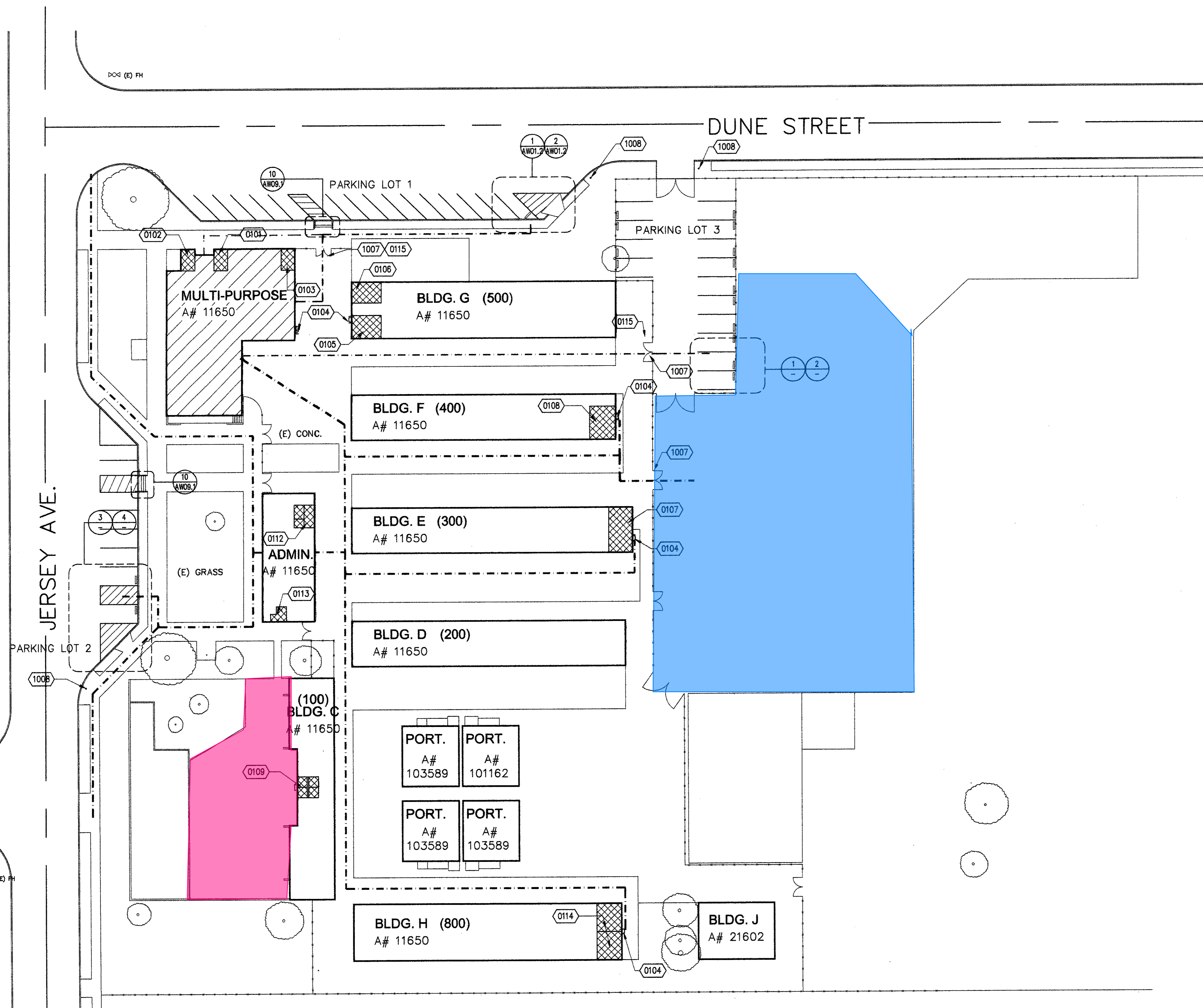

1

-Contractor to provide 1000' lineal feet of hot crack fill as specified. Contractor to figure the cracks are *minimum* 2" wide.
 - Contractor to provide 750' square feet of *demo and patch back* of 6" asphalt and 6" base as directed by the Construction Manager. Contractor to figure 5 different locations.
 - Contractor to provide striping to match existing.
 - Contractor shall clean existing surface thoroughly prior to applying 1st coat.
 - Contractor to provide any grinding needed for smooth transition from new asphalt to existing.
 - Contractor shall figure to remove all wheel stops and reinstall after completion of slurry coat as specified.
 - Contractor shall paint curbs to match existing.
 - Contractor to provide new redwood headers as needed where asphalt doesn't abut to concrete
 - Contractor to provide two coats of slurry as specified within the specifications.

-Contractor to provide removal of existing 6" asphalt and 6" base UNO.
 - Remove any native or imported fill to allow for new asphalt and base to be installed.
 - Contractor to provide 6" of asphalt over 6" of base.
 - Provide all compaction and grading to meet ADA Requirements and (E) adjacent grades. Sub grade, base to be compacted to 95% - Contractor shall clean existing surface thoroughly prior to applying seal coat. - Contractor to provide any grinding needed for smooth transition from new asphalt to existing
 - Contractor to provide striping to match existing.
 - Contractor to provide two coats of slurry as specified within the specifications.

-Contractor to provide removal of existing 6" asphalt and 6" base UNO.
 - Remove any native or imported fill to allow for new concrete to be installed.
 - Contractor to provide 6" of concrete over 6" of compacted base fill. Sub grade to be compacted to 95%
 - Contractor to provide reinforcement concrete wire mesh and drill, epoxy No. 4's 16" OC, 6" min into existing concrete.
 - Contractor shall provide all compaction to 95% and grading to meet ADA Requirements. New grading shall meet (E) adjacent grades.

MULTI-PURPOSE ROOM RENOVATION
WILLIAM ORR ELEMENTARY SCHOOL
 LITTLE LAKE CITY SCHOOL DISTRICT
 NORWALK, CA

△	04.21.2022		Addendum 1 - Scope Clarification
△			
△			
△			
NO	DATE	BY	DESCRIPTION
REVISIONS			

OVERALL SITE PLAN

DRAWING NUMBER **AWO1.1**

OVERALL SITE PLAN

1" = 30'-0" 5

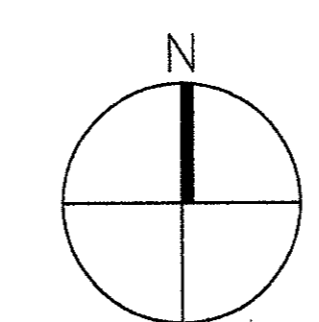

cover the plan per drawing 1/ALL.1.1 on previous page

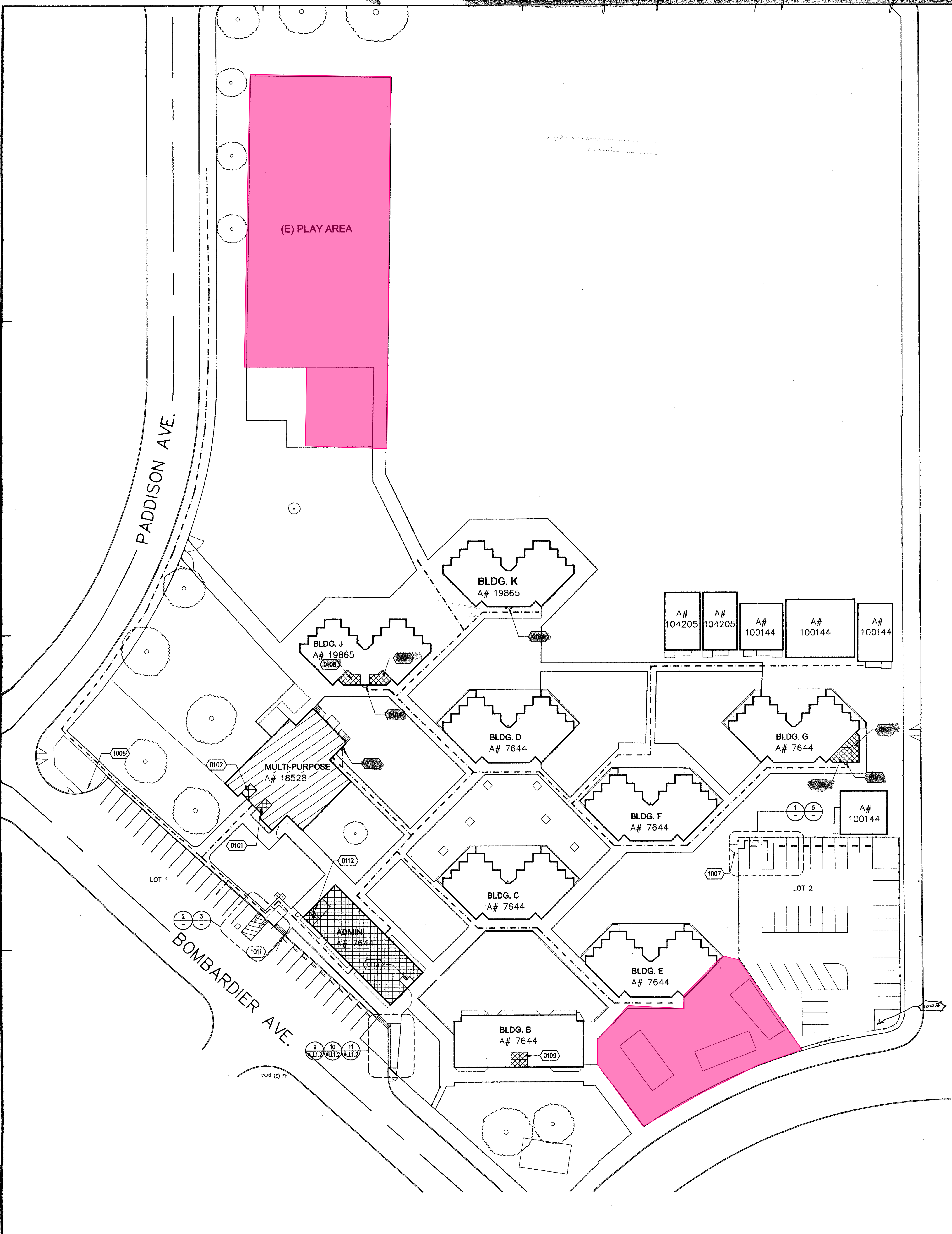

1

-Contractor to provide 1000' lineal feet of hot crack fill as specified. Contractor to figure the cracks are *minimum* 2" wide.
 - Contractor to provide 750' square feet of *demo and patch back* of 6" asphalt and 6" base as directed by the Construction Manager. Contractor to figure 5 different locations.
 - Contractor to provide striping to match existing.
 - Contractor shall clean existing surface thoroughly prior to applying 1st coat.
 - Contractor to provide any grinding needed for smooth transition from new asphalt to existing.
 - Contractor shall figure to remove all wheel stops and reinstall after completion of slurry coat as specified.
 - Contractor shall paint curbs to match existing.
 - Contractor to provide new redwood headers as needed where asphalt doesn't abut to concrete
 - Contractor to provide two coats of slurry as specified within the specifications.

-Contractor to provide removal of existing 6" asphalt and 6" base *UNO*.
 - Remove any native or imported fill to allow for new asphalt and base to be installed.
 - Contractor to provide 6" of asphalt over 6" of base.
 - Provide all compaction and grading to meet ADA Requirements and (E) adjacent grades. Sub grade, base to be compacted to 95%
 - Contractor shall clean existing surface thoroughly prior to applying seal coat. - Contractor to provide any grinding needed for smooth transition from new asphalt to existing
 - Contractor to provide striping to match existing.
 - Contractor to provide two coats of slurry as specified within the specifications.

-Contractor to provide removal of existing 6" asphalt and 6" base *UNO*.
 - Remove any native or imported fill to allow for new concrete to be installed.
 - Contractor to provide 6" of concrete over 6" of compacted base fill. Sub grade to be compacted to 95%
 - Contractor to provide reinforcement concrete wire mesh and drill, epoxy No. 4's 16" OC, 6" min into existing concrete.
 - Contractor shall provide all compaction to 95% and grading to meet ADA Requirements. New grading shall meet E) adjacent grades.

MULTI-PURPOSE ROOM RENOVATION
LAKELAND ELEMENTARY SCHOOL
 LITTLE LAKE CITY SCHOOL DISTRICT
 NORWALK, CA

04.21.2022	ADDENDUM 1 - Scope Clarification		
NO	DATE	BY	DESCRIPTION
REVISIONS			

OVERALL SITE PLAN

DRAWING NUMBER: **ALL.1.1**

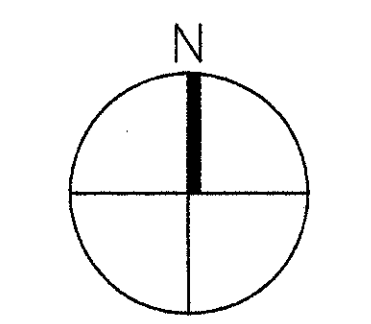

1" = 30'-0" 6

OVERALL SITE PLAN